

Instruction Manual

Water Purifier **Household Use**

Model No. **TK-CJ21**
TK-CJ11
TK-CJ01

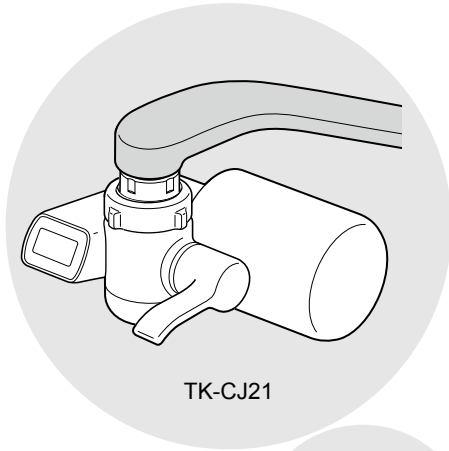

Replacement cartridges for this water purifier:

- For TK-CJ21/TK-CJ11 : Model No. **TK-CJ21C1**
- For TK-CJ01 : Model No. **TK-CJ01C1**

How to Replace the Cartridge (P.25)

Contents

Safety precautions.....	2
Tips to ensure proper operation...	4
Product composition.....	5
Checking the main unit and accessories.....	6
Names and functions of the parts...	7
Steps to take before installing the product.....	8
Installation procedure.....	10
Operation (How to run water).....	18
Maintenance.....	20
Cartridge replacement.....	23
Troubleshooting.....	26
Frequently Asked Questions (Q&A).....	28
Optional accessories.....	29
Specifications.....	30

Thank you very much for purchasing this Panasonic product.

- Please read through this instruction manual carefully before using the product to ensure proper operation.
- **Be sure to read the “Safety precautions” (pages 2 and 3) before using the product.**
- Check that the purchase date has been entered on the warranty, and keep the warranty in a safe place together with the instruction manual.
- Bear in mind that Panasonic will not be liable for any product malfunctioning or accidents which result from the failure to install or operate the product properly.



Safety precautions

These must be observed

Please be sure to observe these precautions to prevent injury to people or damage to property.

- The following precautions are classified according to the extent of possible harm or damage resulting from misuse of the product.

 **WARNING**

If not observed, may result in death or serious injury.

 **CAUTION**

If not observed, may result in minor injury or property damage.

 **WARNING**

■ Do not disassemble

- Do not attempt to disassemble, repair or alter this product.
Doing so may result in fire or electric shock.
 - Please consult with your dealer about the repair of the product.

■ Water used

- This product does not have sterilizing capability and cannot remove harmful substances other than those indicated (See page 24), so drinking unfit (non-potable) water may cause health problems.

■ [TK-CJ21 only] Prevention of accidental ingestion

- Keep coin type lithium batteries out of the reach of babies and small children.
The battery may be accidentally swallowed.
 - If a battery is swallowed, consult a physician immediately.

CAUTION

■ Use / Storage of purified water

● Do not use purified water to raise fish.

The environment may deteriorate, possibly causing the fish to die.

● Dispose the water inside the purifier before use.

● Every day before using the product for the first time, allow about 0.7 liter of water to pass through it (This will take about 20 seconds).

● If the product has not been used for two or more days, allow about 6 liters of water to pass through it (This will take about 3 minutes).

If this is not observed, the health condition may deteriorate.

● When storing purified water, store it in clean airtight containers at most for a day at room temperature and at most for two days in a refrigerator.

If not observed, the water quality may deteriorate and cause health problems since disinfectants (such as chlorine) have been removed from the water.

■ Handling / Prevention of accidental ingestion

● Do not block the purified water outlet.

Doing so may result in water leakage or malfunction.

● Do not connect a hose or other appliance to the purified water outlet.

Doing so may result in malfunctioning of the hot-water supply system.

● Do not connect the product to a hot-water supply system which does not have a non-return valve (a valve for preventing the backflow of water).

Doing so may result in malfunctioning of the water heater.

● Do not connect the product to a mains stop type of water heater (with a structure that makes it impossible to shut off the water at the hot water outlet such as an instantaneous water heater).

● Keep the accessories out of the reach of babies and small children.

The accessory may be accidentally swallowed.

● If an accessory is swallowed, consult a physician immediately.

■ [TK-CJ21 only] Use of the battery

● Do not expose the coin type lithium battery to flame or to excessive heat.

The battery may explode and cause an accident.

● Be sure to insert the coin type lithium battery correctly by matching the “+” and “-” markings.

If the “+” and “-” are not correctly oriented, the battery may explode or leak and cause an accident. (See page 16)

● Do not wet the coin type lithium battery or the battery compartment interior.

The battery may explode or leak and cause an accident.

Tips to ensure proper operation

■ **Do not pass the following kinds of water through the product.**

(Doing so will significantly shorten the cartridge life.)

- Very cloudy water
- Water with a high red rust content

■ **The temperatures of the water that can be used for this product are shown in the table below. Be sure to follow these temperatures.**

(If not observed, may result in malfunction or may cause total trihalomethanes absorbed in the cartridge to be released.)

Selector lever position	Water temperature
Purified	Under 35 °C
Unpurified	Under 80 °C
Shower	

■ **Do not install the water purifier in the following places.**

(If not observed, may result in a malfunction)

- Near heat sources such as stoves (Over 60°C)
If not observed, the case may be deformed by the heat, etc.
- Under direct sunlight or exposed to rain and wind
If not observed, may cause a malfunction, breakdown, etc.
- Places where water may freeze
If not observed, may cause water leakage, the cartridge to crack, etc.
- Places where it may be oil-stained
If not observed, may cause the case to crack, etc.

Product composition

TK-CJ21

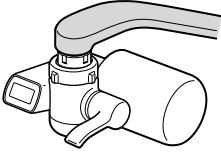

- With LCD display
- Cartridge replacement guidelines:
About 1 year

TK-CJ11

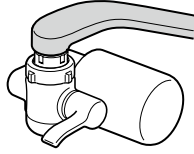

- Cartridge replacement guidelines:
About 1 year

TK-CJ01

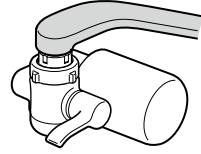

- Cartridge replacement guidelines:
About 6 months

-
- Except for limited exceptions, TK-CJ11/TK-CJ01 are used for the water purifier illustrations in this manual.

Checking the main unit and accessories

If any items are missing, please contact the dealer from whom you purchased the product.

Package items Items included in the box

■ Water purifier

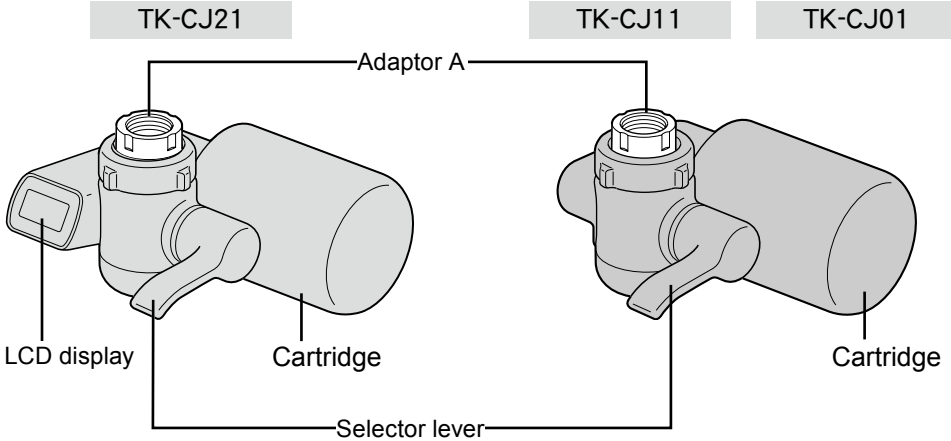

■ Supplied accessories



Installation Adaptor
(with 4 screws)



Bushing
(with gasket)

[TK-CJ21 only] Coin type lithium battery

Model No.: CR2032 (Commercial item)

- The battery included in the package is for test use and may have a short life. Please refer to page 16 for how to insert the battery before using the product.



Names and functions of the parts

TK-CJ21

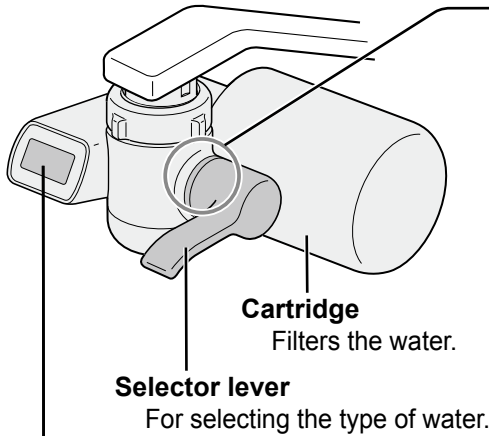

Selector lever position indicator

Displays the current lever position.

Purified water is discharged from the purified water outlet.

Purified

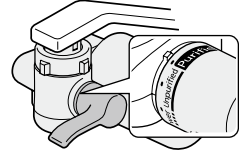

Unpurified water (tap water) is discharged.

Unpurified

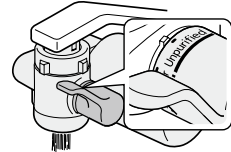

Shower

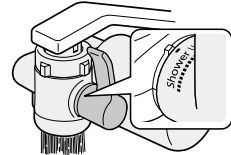

TK-CJ11

TK-CJ01

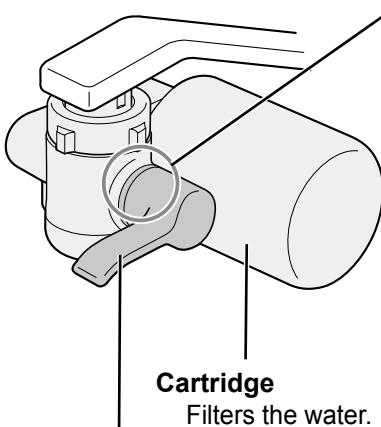

[View from below]

The illustrations show examples for TK-CJ11/TK-CJ01.

Purified water outlet

Purified water is discharged.

Unpurified Water Shower hoses

Unpurified Water Outlet (straight)

The water may look white because air is taken in discharging water to moderate the water flow.

Steps to take before installing the product

■ Faucets onto which the product can be installed

- **Faucets with a thread on the outside**
(See page 6)

Thread diameter: 22 mm

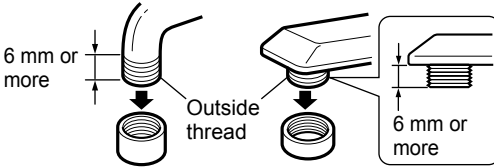

- **Faucets with a thread on the inside**
(See pages 8 and 9)

Thread diameter: 24 mm

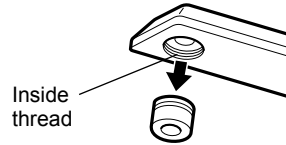

- **Faucets without an aerator** (See pages 10 and 11)

<Flared faucets>

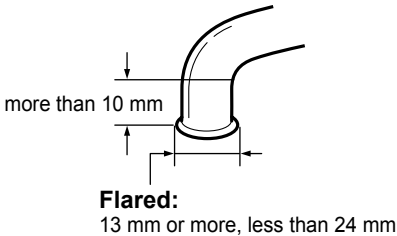

<Straight faucets>

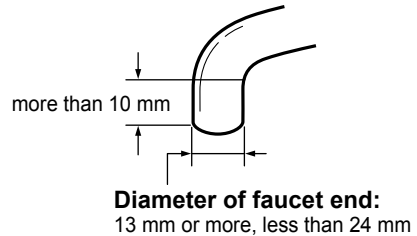

■ Faucets that require an optional accessory to install the product

With the following kinds of faucets, an optional accessory is required to install the product. Purchase the optional accessory from your dealer.

For details on installation, read carefully through the instructions that accompany the accessory.

- **Large faucets**

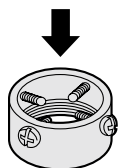

Optional accessory

**Large-diameter Installation Adaptor
Model No.: P-06JRC**

■ Faucets onto which the product cannot be installed

Bear in mind that it will not be possible to install the product onto custom designed faucets or faucets with the wrong thread diameter (which is not 22 mm) or wrong pipe diameter in addition to what is shown below. Neither is it possible to install the product if the main unit comes into contact with the faucet.

● Plastic faucets

Installation will cause the plastic area at the end of the faucet to crack.

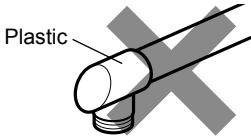

• The product can be installed onto faucets with a metal thread.

● Faucets with a shower nozzle

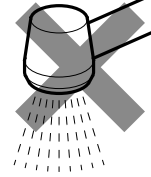

● Faucets whose end area measures 10 mm or less

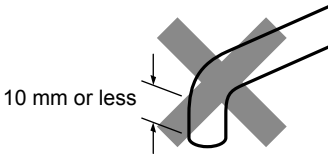

● Faucets with a sensor

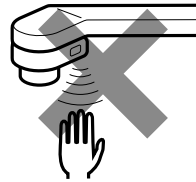

Installation procedure

- Do not connect the product to a faucet used solely for hot water.

Faucets with an outside thread (thread diameter: 22 mm)

Types of faucets

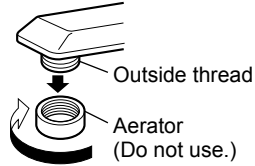
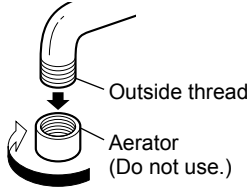

1 Remove the mounting nut and adaptor.

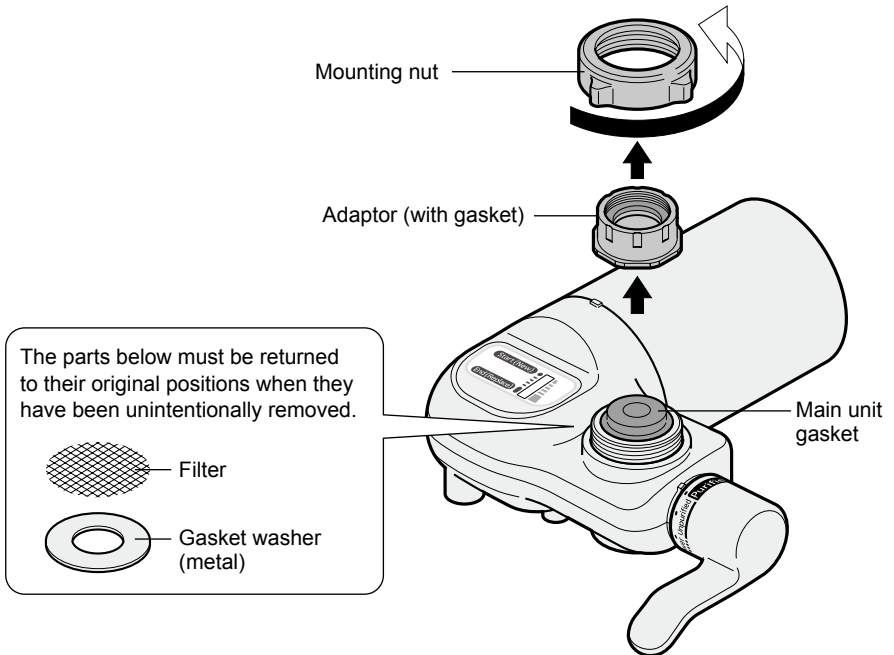

2 Remove the aerator, pass the mounting nut over the faucet, and install the adaptor.

- The adaptor should be screwed on straight. Screwing it on tilted may strip the threads, resulting in water leaks.

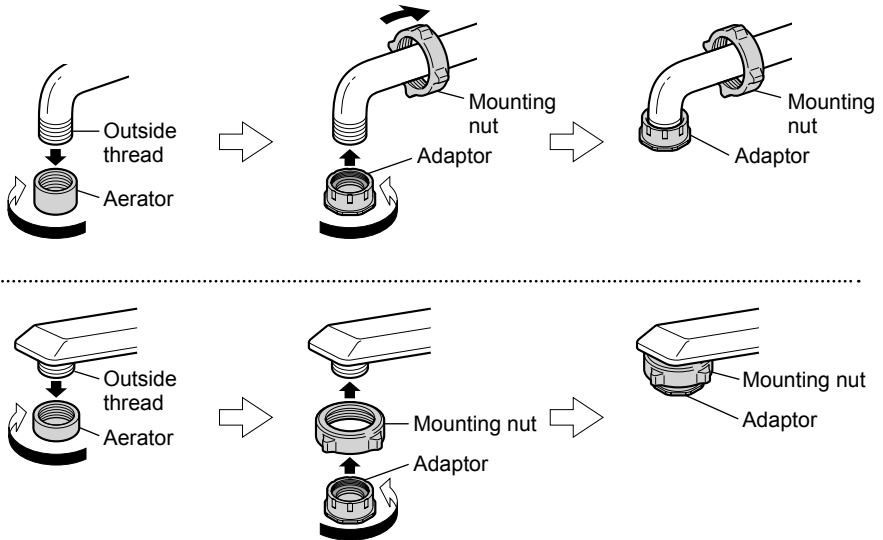

3 Turn the mounting nut manually, and tighten it securely.

Important

- Do not use a tool to tighten up the mounting nut. (Doing so may damage the mounting nut.)
- Do not turn the main unit to tighten up the mounting nut. (Doing so will apply a powerful force to the thread, possibly damaging the main unit.)

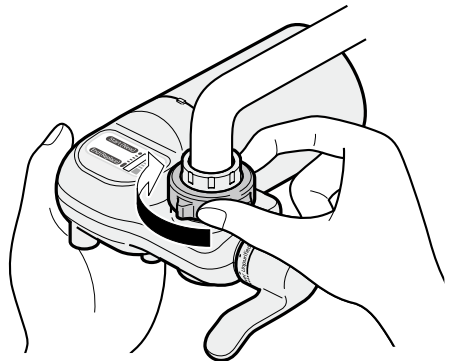

Upon completion of installation, check that the main unit does not easily rotate and that there is no play.

Installation procedure

- Do not connect the product to a faucet used solely for hot water.

Faucets with an inside thread (thread diameter: 24 mm)

Types of faucets

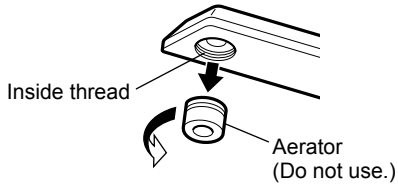

Accessories used



1 Remove the mounting nut and adaptor.

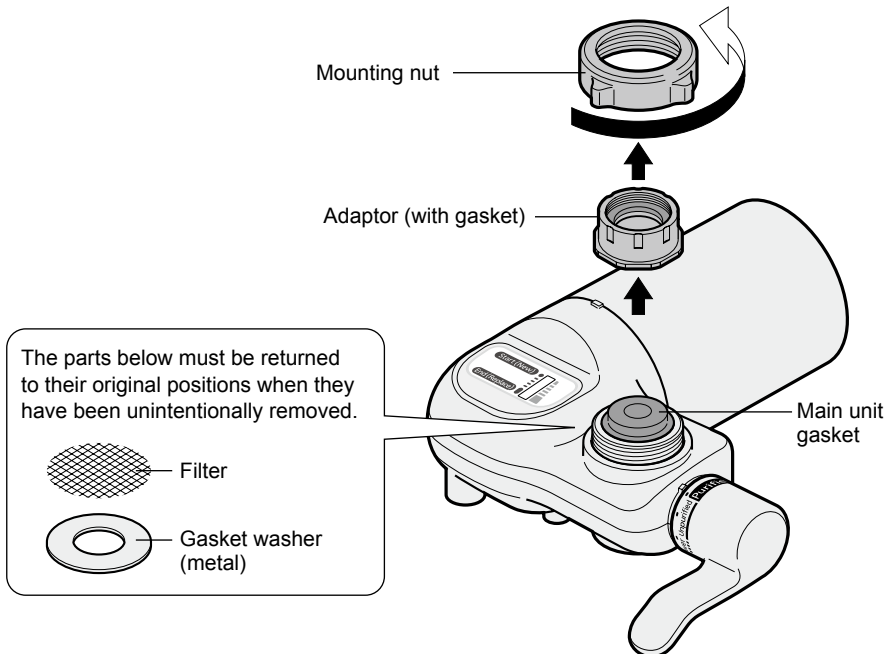

2 Screw in the bushing. Insert into the adaptor.

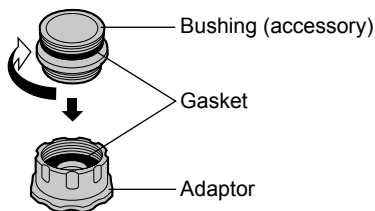

3 Attach the mounting nut and adaptor.

- The adaptor should be screwed on straight. Screwing it on tilted may strip the threads, resulting in water leaks.

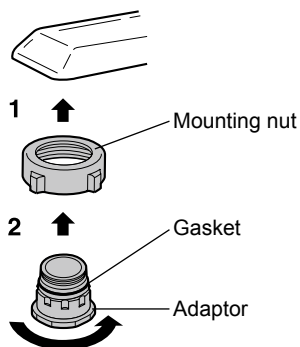

4 Turn the mounting nut manually, and tighten it securely.

Important

- Do not use a tool to tighten up the mounting nut. (Doing so may damage the mounting nut.)
- Do not turn the main unit to tighten up the mounting nut. (Doing so will apply a powerful force to the thread, possibly damaging the main unit.)

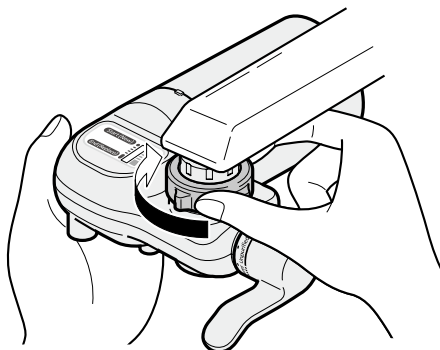

Upon completion of installation, check that the main unit does not easily rotate and that there is no play.

Installation procedure

- Do not connect the product to a faucet used solely for hot water.

Faucets without an aerator

Types of faucets

- Flared faucets

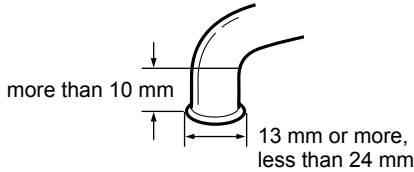

- Straight faucets

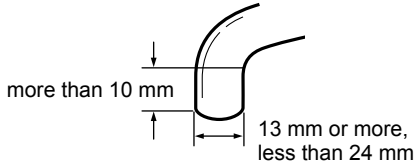

Accessories used



Installation Adaptor
(with 4 screws)

1 Remove the mounting nut and adaptor.

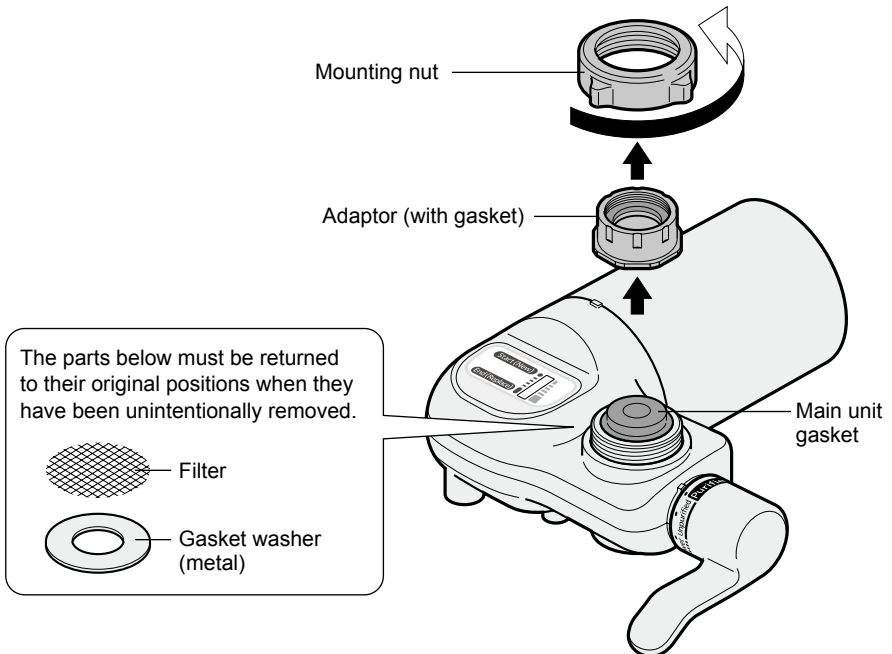

2 Remove the four screws of the installation adaptor, install the installation adaptor, and tighten it using the mounting nut.

1. Remove the four screws.

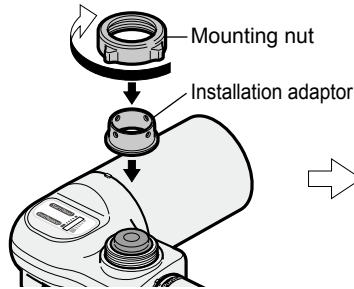

2. Tighten the installation adaptor using the mounting nut.

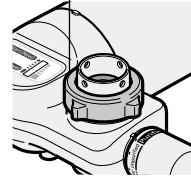

3 Loosely tighten the screws, and loosen the mounting nut.

1. Loosely tighten the screws (x4).

2. Loosen the mounting nut until a 3 mm to 4 mm clearance forms between the mounting nut and main unit.

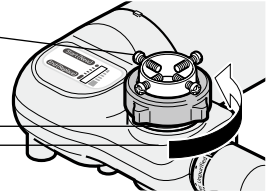

4 While pushing the main unit up, install it onto the faucet.

1. Tighten the two rear screws by hand until they touch the pipe in such a way that the pipe is positioned in the center of the installation adaptor.

2. Use a screwdriver to tighten the two remaining screws.

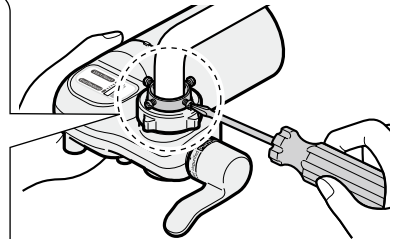
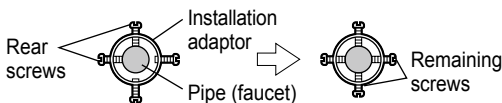

5 Turn the mounting nut manually, and tighten it securely.

Important

- Do not use a tool to tighten up the mounting nut. (Doing so may damage the mounting nut.)
- Do not turn the main unit to tighten up the mounting nut. (Doing so will apply a powerful force to the thread, possibly damaging the main unit.)

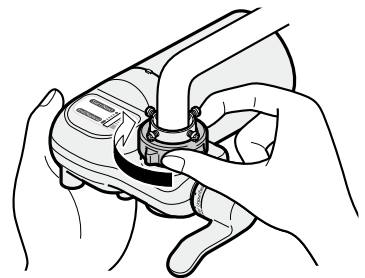

Upon completion of installation, check that the main unit does not easily rotate and that there is no play.

Installation procedure

[TK-CJ21 only] How to insert a lithium battery in the water purifier (To replace battery)

TK-CJ21 uses one coin type lithium battery to power the sensor for the cartridge replacement guideline.

1 Open the battery cover.

- Before opening the battery cover, carefully wipe the unit free of all moisture.

Turn the cover counterclockwise with a coin-like object. (Do not use the battery included in the package)

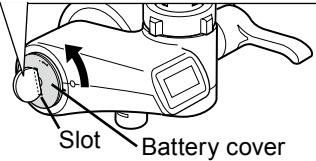

2 Insert battery.

- When replacing the battery, remove the old battery.
- When the battery is inserted, all items displayed on the LCD will light up for about one second, followed by the cartridge replacement guideline.
- When a battery that is almost exhausted is inserted, the battery replacement mark (🔋) will appear.

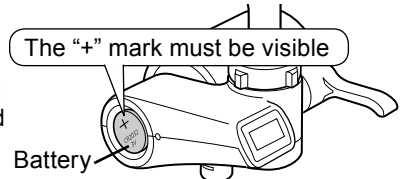

3 Close the battery cover.

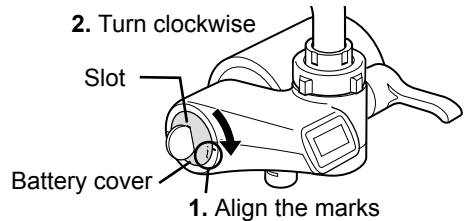

■ Battery replacement timing

Replace the battery when the battery replacement mark (🔋) appears on the LCD.

	Flashes	It is almost time to replace the battery.
	Stays on	The battery needs to be replaced. Please replace it with a new battery.

- Approximate battery life
 - **About 1 year**
 - The battery included in the package is for test use and may have a short life.
- Replacement battery
 - This product uses the commercially available, coin type lithium battery CR2032.



Note

- Replacing the battery will not reset the cartridge replacement guideline.

Important

• About battery disposal

Please dispose of used battery according to the local government regulations.

Checks after installation

Please carry out checks to ensure proper installation and operation.

- 1 Run purified water for about 3 to 4 minutes to expel the air inside the main unit.**

Selector lever

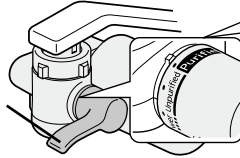

How to run purified water
(See page 18 for details)

1. Set the selector lever to 'Purified'
2. Turn on the water faucet to let the water flow

- 2 Check the items below and take respective measures in case of abnormality.**

- 3 Mark the month when the cartridge was replaced using a permanent marker.**
(See page 23 for guidelines on cartridge replacement)



Example:
Replaced in
March

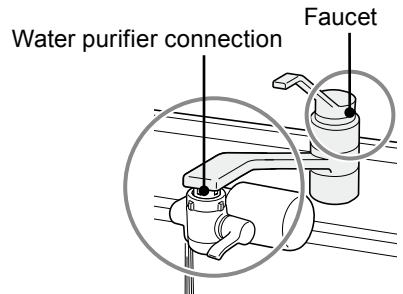

English

Check items	Inspection points and measures in case of abnormality	Reference page
<p>Is water leaking from the purifier connection area?</p>	<ul style="list-style-type: none"> • Is the water purifier installed securely onto the faucet? →Reconfirm the 'Installation Procedures' to install the product securely. * If the adaptor is loose, rotating the purifier will tighten up the mounting. • Are the parts inside the water purifier assembled properly? →Assemble the parts properly. 	10-15
<p>Is water leaking from the faucet?</p>	<ul style="list-style-type: none"> • Is the end of the faucet (such as insulation cap) chipped or cracked? →Consult a plumber. • Is the faucet gasket being used an old one? →Consult a plumber. 	—

Operation (How to run water)

Using purified water

Always use water with a temperature under 35°C.

(If not observed, may result in cartridge malfunction.)

- If water above 35°C is accidentally used, allow water to flow to the purified side for about 20 seconds.

1 Set the selector lever to 'Purified'.

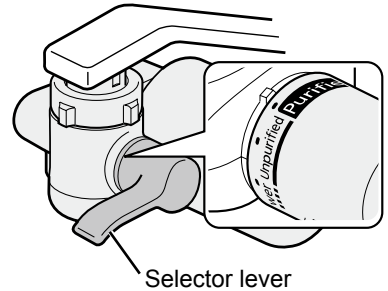

2 Turn on the water faucet to let the water flow.

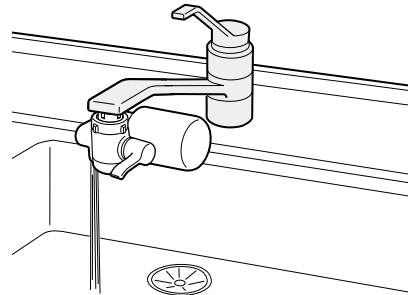
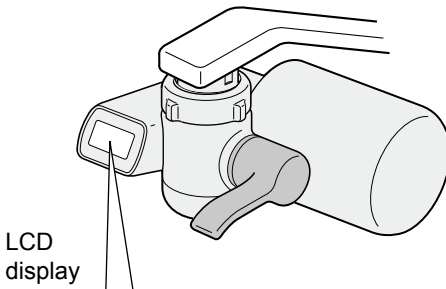

During use

(Animation display)



For 10 seconds after turning off the faucet

Displays the timing for cartridge replacement with a remaining volume that can be purified. (P.23)



10 seconds after turning off the faucet

To conserve battery power, the LCD will shut off about 10 seconds after turning off the faucet. (Turns back on when water passes again)

- When the water flow is 0.6 liter/minute or less, the water is considered to have been turned off and the remaining volume that can be purified is displayed.

3 When finished, turn off the water faucet.

Using unpurified water (tap water)

Always use water with a temperature under 80°C.
(If not observed, may result in malfunctioning of the water purifier.)

- 1 Set the selector lever to 'Shower' or 'Unpurified'.**

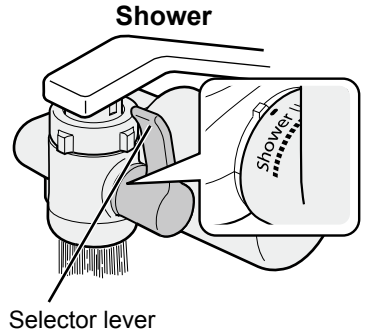

- 2 Turn on the water faucet to let the water flow.**

Note

- If the shower does not come out uniformly, turn on the water faucet to increase water flow.

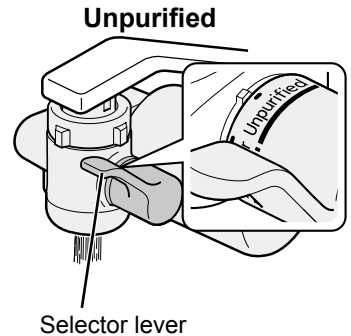
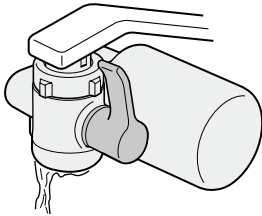

- 3 When finished, turn off the water faucet.**

Maintenance

Regular maintenance

Moisten and wring a soft cloth, and clean the product with it.

Note

- Do not use detergents, cleansers, paint thinners, benzene, alcohol, kerosene, etc. If used by accident, wipe the product with a damp cloth to remove the detergent, etc. on the surface. (The detergent may get mixed in the water, cause the resin to crack or lead to discoloration/ deformation)
- Do not use a metal brush, etc. (Doing so may cause scratches)

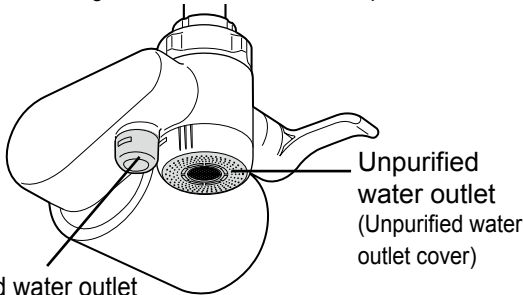

Purified water outlet
(Purified water outlet cover)

- The illustration is an example for TK-CJ11/TK-CJ01.

■ Unpurified water outlet

- Clean the stains(*) on the unpurified water outlet using a brush such as a toothbrush.
- The inside areas can be cleaned by removing the unpurified water outlet cover.

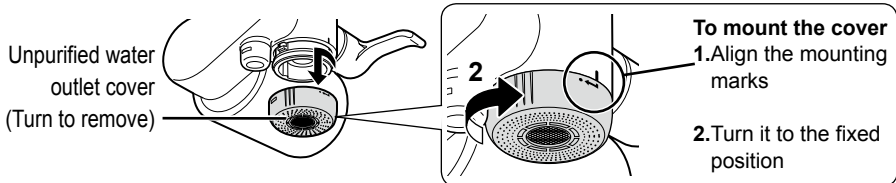

*Washings splash remaining on the product may cause stains and mold growth. Cleaning after each use or regular cleaning is recommended.

■ Purified water outlet

- The inside areas can be cleaned by removing the purified water outlet cover.

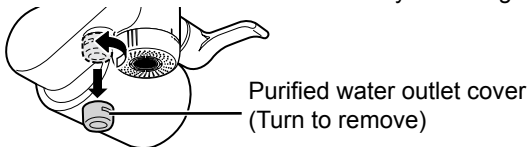

■ In case of a suspension of water supply

- The product cannot be used.
- If water supply is cut off during use, turn off the faucet.
- When water supply is resumed, set the selector lever to 'Unpurified' or 'Shower' and run unpurified water (tap water) to expel the air and turbid water inside the main unit. Once this is done, the product can be used normally. (Allowing air and turbid water to pass through the purified side will significantly shorten cartridge life)

Once-a-Year Maintenance

- The water flow may decrease when the filter in the main unit connection area becomes clogged with impurities.
- Take the following steps to clean the product once a year.

■ Main unit connection area (filter, water inlet)

- The illustration of the water purifier shows an example for TK-CJ11/TK-CJ01.

1 Loosen the mounting nut, and remove the main unit. Remove the filter and gasket, Then remove the gasket washer.

- Set the selector lever to “Purified”
- Gently turning the main unit will loosen the mounting nut.

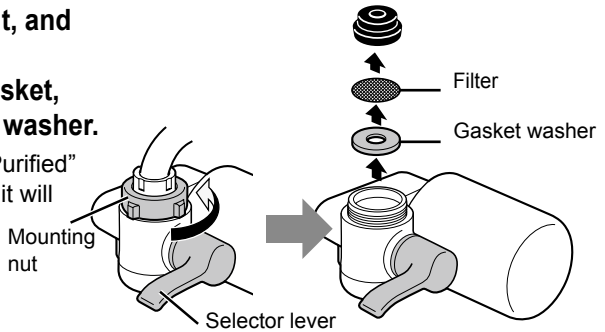

(Example: In case the unit is installed with an adaptor)

2 Clean the filter and water inlet.

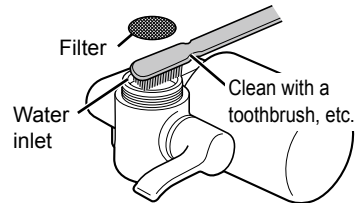

3 Reinstall the water purifier.

- Don't forget to mount the filter.
- After mounting the unit, set the lever to “Unpurified” or “Shower” and allow water to flow for about 5 seconds.

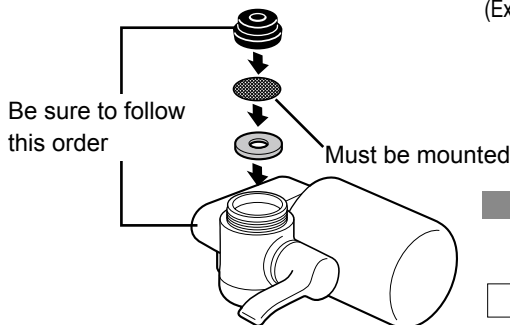

(Example: In case of installation using an adaptor)

Note

- Do not use any tools to tighten the mounting nut.
(Doing so may damage the mounting nut)

Maintenance

Replacing the gasket and filter

■ **Gasket** *The water purifier illustration shows an example for TK-CJ11/TKCJ01.

- To install the unit onto a faucet, the gaskets must be used as shown in the figure below.
- Water leakage may occur with long-term use, due to rubber degradation, deformation, and/or scratches.

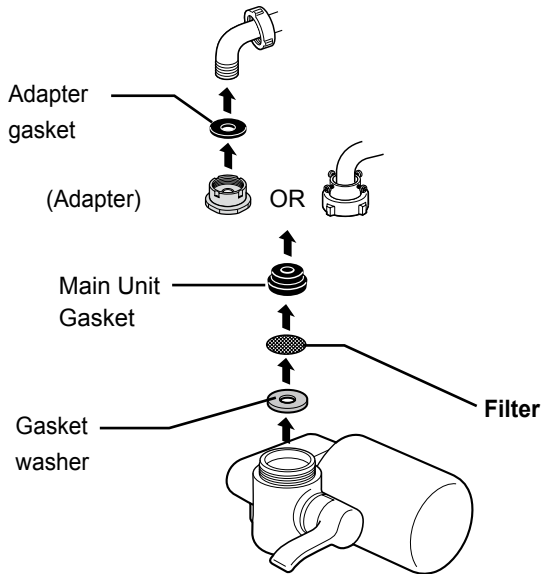

■ If the amount of water discharge has decreased

(1) Due to filter clogging



- The filter removes large particles, which stick to the water pipes (fur, rust, etc.).
- Using the product without a filter may result in malfunctioning of the water purifier.

(2) Due to reasons other than filter clogging

- When the water temperature is low (because it is then harder for the water to pass through the cartridge)
- When the product is used in an area where the water pressure is low (under 70 kPa)
- When the water pressure in the area has dropped or when there is a suspension of water supply after waterworks, etc.
- Clogging of the cartridge

Cartridge replacement

- If it is time for replacement and filter performance has dropped, replace it with a new cartridge.

Model No.	TK-CJ21/TK-CJ11	TK-CJ01
Replacement cartridge Model No.	 TK-CJ21C1 P.29	 TK-CJ01C1 P.29
Cartridge replacement guidelines:	Cumulative volume of purified water: 4,000 liters *1	Cumulative volume of purified water: 2,000 liters *1
	*1 Household water purifier test method: Based on JIS S 3201 figures	
Guidelines on usage period	10 liters of purified water used a day: About 1 year 20 liters of purified water used a day: About 6 months	10 liters of purified water used a day: About 6 months 20 liters of purified water used a day: About 3 months

Note: Replace the cartridge in the following situations even when the volume of purified water used has not decreased.

- When the odor or unpleasant taste is detected in the water (the cartridge removal capability has dropped)
- When the volume of purified water used has decreased considerably (the cartridge is clogged)
- For TK-CJ21/TK-CJ11: Cartridge has been used for more than 1 year
- For TK-CJ01: Cartridge has been used for more than 6 months



Replace the cartridge (P.27)

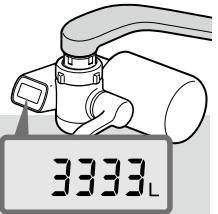

[TK-CJ21 only]

- Confirm the LCD for the remaining volume that can be purified (displayed for 10 sec. after turning off the faucet)
- The volume remaining to reach the guideline of 4,000 liters of purified water is displayed for 10 seconds.
- Cumulative water flow is calculated.

When the remaining volume until replacement drops below 150 liters, the following display will flash.

Example:
150 liters left



When there is no remaining volume, the following indications will alternately appear.

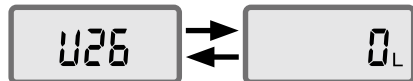

Please replace the cartridge before the remaining volume hits "0L".

Cartridge replacement

About cartridge removal performance

■ Substances that can be removed

- Free residual chlorine
- Total trihalomethane *1
- 2MIB (musty odor)
- Iron (fine particles) *2
- Geosmin (musty odor) *2
- Turbidity
- Soluble lead (Only TK-CJ21/TK-CJ11)
- Aluminum (neutral) *2
- Phenols *2

*1 This is a general term for four compounds: chloroform, bromodichloromethane, dibromochloromethane, and bromoform.

*2 Substances subject to removal provided in the standards (JWPAS B Standards) established by Japan Water Purifier Association (JWPA).

■ Difference in usage period due to water quality

A hollow fiber membrane filter is built in the cartridge to remove fine dirt.

Therefore, the usage period becomes shorter for water containing more substances that cause clogging.

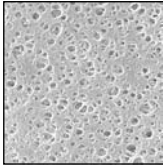

Hollow fiber membrane surface (when new)

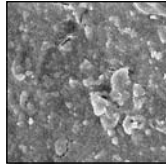

Clogged hollow fiber membrane surface

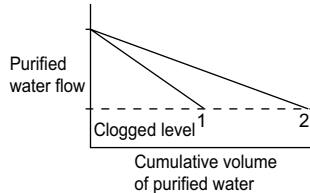

1. Water quality with more substances that cause clogging
2. Standard water quality

- Radioactive substances cannot be removed.

Note

- For regular tap water, the clogging timing may differ significantly depending on the water quality (turbidity, iron mold, etc.) and water pressure.

How to replace the cartridge

- Turn off the faucet before starting.
Do not run the water when the cartridge has been removed. Water will overflow.

1 Remove the old cartridge.

- Remove the cartridge in the sink. (Water will drip)
- The cartridge will come off by turning it in the direction of the arrow as shown on the right.

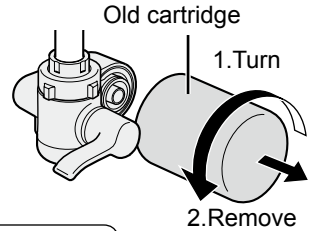

2 Install the new cartridge.

1. Mark the month when the cartridge was replaced using a permanent marker.



Example: Replaced in March

2. Insert the cartridge in the direction of the arrow.
3. Slowly turn it in the direction of the arrow until it stops.
 - Do not over-tighten the cartridge.
(Doing so may damage the cartridge mount and cause water to leak.)

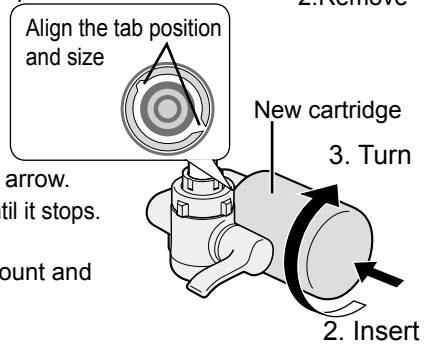

[TK-CJ21 only]

4. Press the reset button (for 3 sec.)
(Do not press the button with pointed objects such as a toothpick. Use an object with a rounded tip, such as the rounded end of a toothpick.)
 - The remaining volume that can be purified with the cartridge will be reset to 4000L.

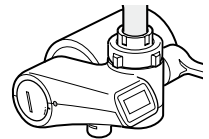

3 Turn on the faucet and set the selector lever to "Purified" and allow water to flow (For about 3 - 4 min.)

- Check that no water is leaking from the cartridge mount when the water passes the product.

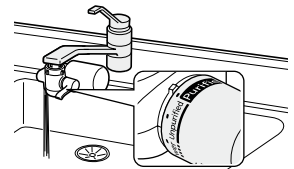

Note

- Please dispose of the used cartridge according to the local laws and regulations.
(The cartridge case is made of ABS resin. See page 30 for Specifications of filter components)



[TK-CJ21 only]

- Even if replacing the cartridge when there is still remaining volume that can be purified, press the reset button in step 2-4 until the remaining volume of 4000L is displayed. (For about 3 sec.) [This is to correctly display the cartridge's remaining volume that can be purified]

Troubleshooting

If you think there is a malfunction, please check the following points before requesting a repair. If you find a problem, do not disassemble or repair the product by yourself. Please contact the dealer from whom you purchased the product.

Symptom	Causes and measures to be taken	Reference page
The purified water flow is low or there is no flow.	<ul style="list-style-type: none"> • Is the water faucet fully turned on? →Turn the faucet to increase water flow. • Is the water pressure too low? →Turn the faucet all the way on. 	—
	<ul style="list-style-type: none"> • Is the filter inside the water purifier clogged? →Clean the filter. 	21
	<ul style="list-style-type: none"> • Is the cartridge securely mounted? →Mount the cartridge securely onto the faucet. 	25
	<ul style="list-style-type: none"> • Is there a suspension of water supply? →Wait until water supply is resumed. 	20
	<ul style="list-style-type: none"> • Water flow is low due to clogging of the cartridge. →This is not a malfunction. It is almost time to replace the cartridge. 	23, 24
Odor, unpleasant taste or turbidity does not go away.	<ul style="list-style-type: none"> • The cartridge's removal capability has dropped. →Replace the cartridge. 	23 - 25
Water flow is low even after replacing the cartridge.	<ul style="list-style-type: none"> • Air inside the cartridge has not been expelled. →This is not a malfunction. Run water through the product for about 3 to 4 minutes. 	—
[TK-CJ21 only] The LCD display has disappeared suddenly.	<ul style="list-style-type: none"> • To conserve battery power, the LCD automatically shuts off when not in use. →This is not a malfunction. 	18

Symptom	Causes and measures to be taken	Reference page
<p>[TK-CJ21 only] The following display appeared.</p> 	<ul style="list-style-type: none"> The cumulative volume of purified water exceeded the cartridge replacement guideline (4000 liters). →Replace the cartridge. Did you press the reset button after replacing the cartridge? →Press the reset button. (For about 3 sec.) 	25
<p>[TK-CJ21 only] The following display appeared.</p> 	<ul style="list-style-type: none"> The battery needs to be replaced. →Replace the battery (Coin type lithium battery: CR2032). 	16

English

■In case of a water leakage

Water leak area	Causes and measures to be taken	Reference page
Purifier connection area	<ul style="list-style-type: none"> Is the water purifier installed securely onto the faucet? →Install the product securely. * If the adaptor is loose, rotating the purifier will tighten up the mounting. Are the parts inside the water purifier assembled properly? →Assemble the parts properly Is the end of the faucet (such as insulation cap) chipped or cracked? →Consult a plumber. 	10 - 15 —
Cartridge mount area	<ul style="list-style-type: none"> Is the cartridge securely mounted? →Mount the cartridge securely. 	25
Faucet area	<ul style="list-style-type: none"> Is the faucet gasket being used an old one? →Consult a plumber. 	—

Frequently Asked Questions (Q&A)

The following is a list of frequently asked questions.

Usage

Q1	Is it all right to drink purified water if you are taking medication?
	Use "Purified" water when taking medication. Purified water can be used for drinking and cooking in addition to taking medication.
Q2	How long can the purified water be stored?
	Use it within a day at room temperature. In case of purified water, chlorine (disinfectants) in the tap water has been removed, which encourages growth of general bacteria. Store the water in clean airtight containers and at most for two days, even in a refrigerator.
Q3	The purified water seems to glitter? Why?
	Elements dissolved in water (mainly minerals) have precipitated. The same phenomenon appears when the cartridge performance has dropped. In that case, replace it with a new cartridge.
Q4	Can lead (soluble lead) be removed?
	TK-CJ21/TK-CJ11 :It can be removed. TK-CJ01 :It cannot be removed.

Maintenance

Q5	What should be done if the product is not to be used for a long time (Guideline: more than 1 week)?
	<ul style="list-style-type: none">● Remove the cartridge from the water purifier, put it in a plastic bag, remove air from the bag, close it and store in a refrigerator.● When reusing it again, attach the cartridge and let water pass for about 3 minutes. Check that water is not leaking and it is operating normally with no irregular displays. If the product is not used for more than 1 month, the quality of the water inside the cartridge may deteriorate, so cartridge replacement is recommended.

Other

Q6	What is total trihalomethane?
	It is a general term for four compounds: chloroform, bromodichloromethane, dibromochloromethane, and bromoform.
Q7	What is 2-MIB?
	It is an abbreviation for 2-methylisoborneol and is one of the substances causing the musty odor of tap water.

Optional accessories (Prices as of March 2012)

Available at the dealer from whom you purchased the product or dealers handling Panasonic products. Please carefully read the instruction manual included with each product before using or installing the product.

Consumable supply

- Replacement cartridge (P.25)
For TK-CJ21/TK-CJ11
Model No.: TK-CJ21C1
Suggested retail price: 6,800 yen
(tax included)



- For TK-CJ01
Model No.: TK-CJ01C1
Suggested retail price: 5,300 yen
(tax included)

Optional accessory

- Large-diameter Installation Adaptor
Model No. : P-06JRC



Specifications

Specifications

Product name	TK-CJ21	TK-CJ11	TK-CJ01
Dimensions	135(W) x 125(D) x 75(H) mm	125(W) x 110(D) x 75(H) mm	
Weight	Approx. 350 g (Approx. 490 g when full of water)	Approx. 310 g (Approx. 450 g when full of water)	
Water temperature when using the main unit	Purified water: Under 35 °C (Unpurified/shower: Under 80 °C)		
Minimum usable dynamic water pressure	70kPa		
Filtering capacity	1.8 L / min. [At water pressure 100 kPa]		
Cartridge type	TK-CJ21	TK-CJ01C1	
Filter performance	Free residual chlorine *1	4000L	2000L
	Turbidity *2	4000L	2000L
	Total trihalomethane *1	4000L	2000L
	2 - MIB (musty odor) *1	4000L	2000L
	Soluble lead *1	4000L	—
Removable substances other than the above	Iron (fine particles) *4	●	●
	Aluminum (neutral) *4	●	●
	Geosmin (musty odor) *4	4000L	2000L
	Phenols *4	4000L	2000L
Guide for time to replace filter (cartridge) *3	About 1 year (10 liters of purified water used a day) About 6 months (20 liters of purified water used a day)		About 6 months (10 liters of purified water used a day) About 3 months (20 liters of purified water used a day)
Type of material used	ABS resin		
Filter components	Non woven fabric filter, Granular activated carbon, Ceramic, Hollow fiber membrane		Non woven fabric filter, Granular activated carbon, Hollow fiber membrane
Substances not removed	Dissolver iron, heavy metals (Silver, Copper, etc.) and salt (Seawater)		

* All figures given are for a water temperature of 20 °C.

* This product cannot convert hard water into soft water.

*1 This test method is based on Japanese Industrial Standard (JIS) S 3201.

*2 This figure is 50 % of filtration flow rate based on JIS S 3201 test.

*3 This may be significantly shorter depending on the volume of water used, water quality and water pressure.

*4 This figure is 80% of removal rate based on tests according to standards (JWPAS B Standards) established by Japan Water Purifier Association (JWPA). Filter performance is not provided for iron (fine particles) and aluminum (neutral).

Panasonic Corporation

1006, Kadoma, Osaka 571-8501, Japan

Printed in Japan

使用說明書

濾水器 家庭用

型號 **TK-CJ21**
TK-CJ11
TK-CJ01

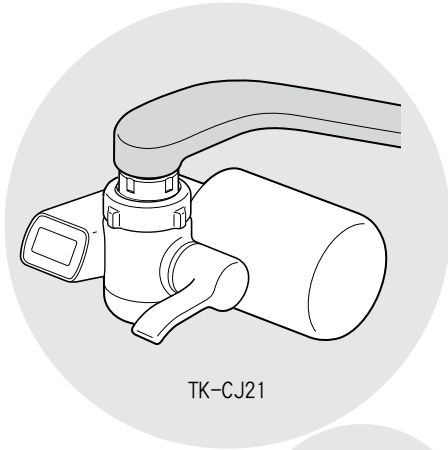

TK-CJ21

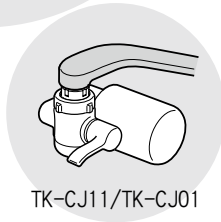

TK-CJ11/TK-CJ01

本濾水器的更換用濾心如下

- TK-CJ21/TK-CJ11 用 型號：TK-CJ21C1
- TK-CJ01 用 型號：TK-CJ01C1

更換方法（請參考 55 頁）

目錄

安全注意事項.....	32
使用須知.....	34
關於產品的構成內容.....	35
確認本體與配件.....	36
各部名稱與作用.....	37
安裝前.....	38
安裝方法.....	40
使用方法（排水）.....	48
維修保養.....	50
更換濾心.....	53
故障排除.....	56
常見問題（Q&A）.....	58
選購品.....	59
規格.....	封底

感謝您選購 Panasonic 濾水器。

- 使用前請詳閱本說明書，詳閱說明書後再正確安全使用。
- 特別是「安全注意事項」（32 ~ 33 頁），請務必在使用前詳細閱讀。
- 保證書上的「購買日期」請務必填寫，並與本說明書妥善保管。
- 因安裝錯誤或不正確使用，而造成產品產生故障或發生事故時，本公司恕不負責。

安全注意事項

請務必遵守

以下說明務必遵守的事項，以免造成人員受傷以及財產受損。

■ 內容說明錯誤的使用方式而引起之危害或損害程度的分類



警告

「可能致死或受重傷之虞的內容」。



注意

「可能有受輕傷或財產受損之虞的內容」。



警告

■ 禁止拆解

● 切勿自行拆解、修理或改造

以免起火或觸電。

● 維修請洽經銷商。

■ 用水

● 請勿使用能夠飲用的水（自來水等）以外的水源。

由於沒有殺菌處理及無法除去可去除物質（參閱 54 頁）以外的有害物質，飲用後對健康有害。

■ [僅 TK-CJ21] 防止誤食

● 硬幣型鋰電池應放置在嬰幼兒拿不到的場所。

以免誤食。

● 不慎誤食時，應立即就醫診治。

注意

■ 過濾水／過濾水的保存

● 過濾水切勿用於飼養魚類等

以免因水質環境改變而導致魚類等死亡。

● 開始使用前，請將內部的積水排出

每天開始使用前…通水約 0.7 公升（約 20 秒）後再使用。

2 天以上未使用時…通水約 6 公升（約 3 分鐘）後再使用。

請務必遵守上述事項，以免影響到健康。

● 存放過濾水時，請放入乾淨的密閉容器，常溫下請於 1 天內使用，置於冰箱時請於 2 天內使用。

因殺菌劑（漂白劑等）已被除去，請務必遵守上述事項，以免因水變質而影響到健康。

■ 操作／防止誤飲

● 請勿阻塞過濾水口。

以免造成漏水或故障。

● 過濾水口請勿連接水管或其他器具。

以免造成漏水或故障。

● 請勿連接於熱水器等無法關閉熱水構造的地方。

以免造成熱水供應設備故障。

● 請勿連接於無附設防止逆流閥的熱水供應設備。

以免造成熱水器故障。

● 配件應放置在嬰幼兒拿不到的場所。

以免誤食。

• 不慎誤食時，應立即就醫診治。

■ [僅 TK-CJ21] 電池的處理

● 硬幣型鋰電池切勿丟入火中或加熱

以免因破裂而發生意外。

● 請依正極與負極位置正確放入硬幣型鋰電池

以免因極性位置錯誤而造成破裂或漏液等意外。（請參閱 46 頁）

● 請避免硬幣型鋰電池或電池外殼內部受潮

以免因破裂或漏液等而發生意外。

使用須知

■請勿以下列情況的水通水。

(將導致濾心壽命大幅減短。)

- 嚴重混濁的水
- 紅鏽含量多的水

■可使用的水溫如下表所示，請依該溫度使用。

(以免故障或吸附於濾心的總三鹵甲烷被釋出)

切換手把的位置	水溫
Purified	不超過 35℃
Unpurified	不超過 80℃
Shower	

■切勿設置於以下場所。

(以免故障)

●瓦斯爐等高溫來源的附近(60℃以上)

以免外殼因高溫而變形等。

●直接日照的場所、受風雨侵襲的場所

以免造成動作失誤或故障。

●可能結凍的場所

以免造成漏水或濾心破裂等。

●容易被油附著的場所

以免外殼出現裂縫等。

關於產品的構成內容

TK-CJ21

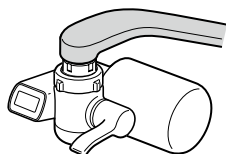

- 附視窗部
- 更換濾心的週期：約 1 年

TK-CJ11

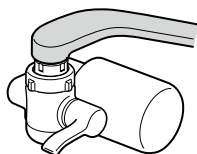

- 更換濾心的週期：約 1 年

TK-CJ01

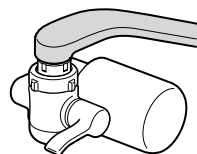

- 更換濾心的週期：約 6 個月

-
- 除了有限定的情況外，本書所使用的濾水器插圖為 TK-CJ11/TK-CJ01。

確認本體與配件

如有短缺，請向購買的經銷商洽詢。

包裝內容 紙箱內的物品

■ 濾水器

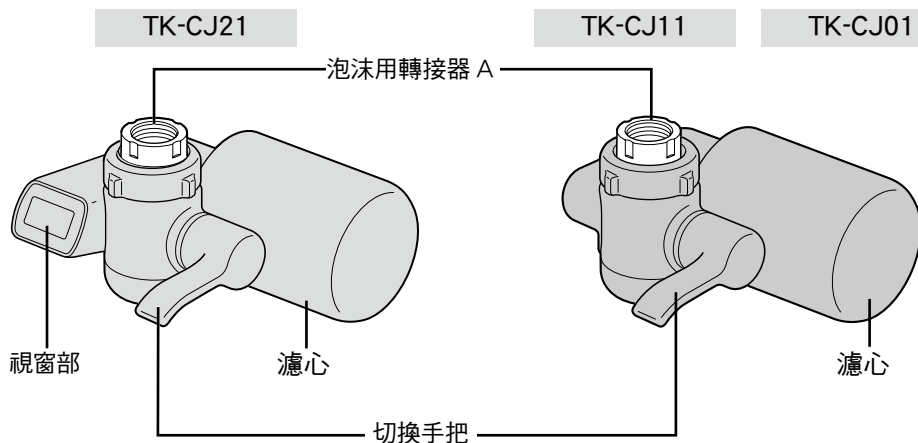

■ 配件



安裝轉接器
(附有四個螺絲)



密封套
(附有墊片)

[僅 TK-CJ21] 硬幣型鋰電池

型號：CR2032 市售電池

- 附屬的電池僅供測試用，使用期間比較短。
使用前，請參閱 46 頁放入電池。



各部名稱與作用

TK-CJ21

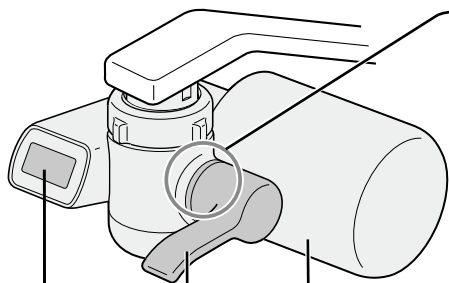

濾心
過濾水。

切換手把
切換水流。

視窗部

顯示濾心與電池剩餘的用量。
P46、48、53

TK-CJ11

TK-CJ01

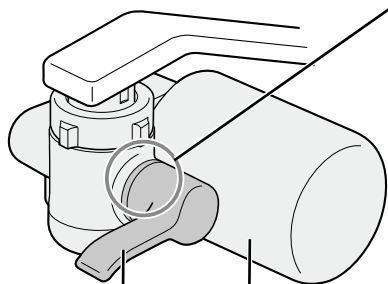

濾心
過濾水。

切換手把
切換水流。

切換手把位置顯示部

顯示現在的手把位置。

從濾水口排出濾水

Purified

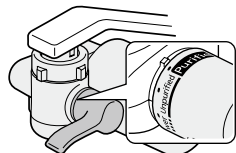

排出原水（自來水）

Unpurified

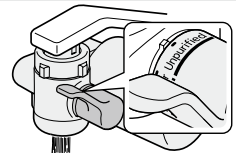

Shower

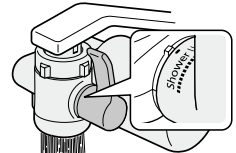

[由下往上看時]

插圖是以 TK-CJ11/TK-CJ01 為例。

過濾水口

排出濾水。

原水淋
灑式口

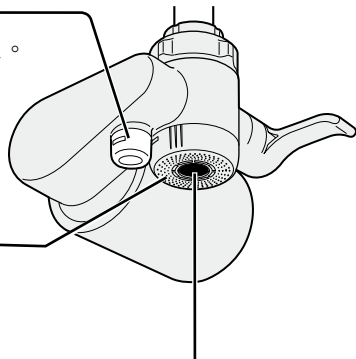

原水口（直式）

讓空氣進入流出的水，或讓水流更為緩和，水因而看起來較白濁。

安裝前

■可安裝的水龍頭

● 外螺紋水龍頭 (參閱 6 頁)

螺紋直徑：22 毫米

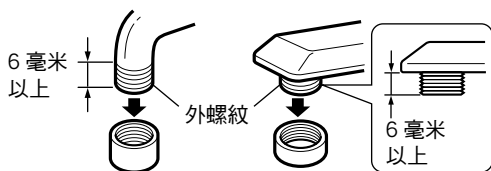

● 內螺紋水龍頭 (參閱 8 ~ 9 頁)

螺紋直徑：24 毫米

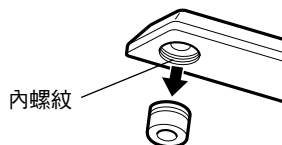

● 無充氣器的水龍頭 (參閱 10 ~ 11 頁)

< 端部呈喇叭型的水龍頭 >

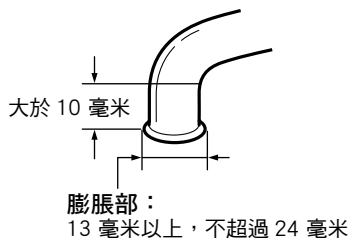

< 直型的水龍頭 >

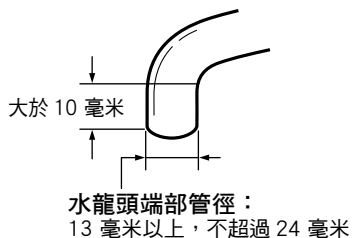

■需要選購件才能安裝的水龍頭

安裝於下列水龍頭時需要選購件。選購件請向經銷商購買。安裝方法請詳閱附屬的說明書。

● 大型水龍頭

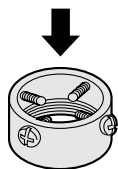
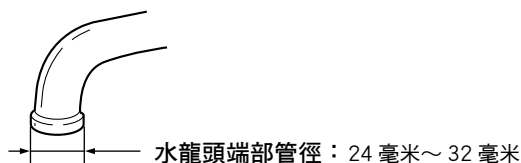

選購件

大型水龍頭用金屬蛇口
型號：P-06JRC

■無法安裝的水龍頭

下列之外也有變形水龍頭，或螺紋直徑（22 毫米以外）、管徑不同的水龍頭，可能無法安裝，請注意。此外，水龍頭會和本體接觸時也不能安裝。

● 樹脂製水龍頭

將導致水龍頭端部的樹脂破裂



• 螺紋部分為金屬則可安裝

● 附有淋灑部

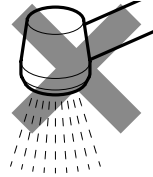

● 端部 10 毫米以下

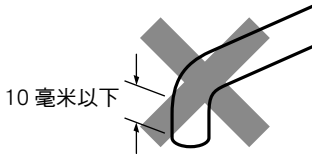

● 附有感測器

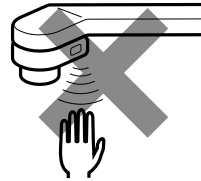

安裝方法

- 請勿連接於熱水專用的水龍頭。

外螺紋水龍頭（螺紋直徑：22 毫米）

水龍頭的種類

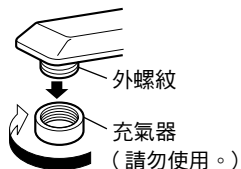
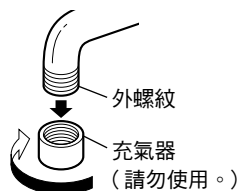

1 卸下螺帽和轉接器

卸下後，請務必將其放回原位。

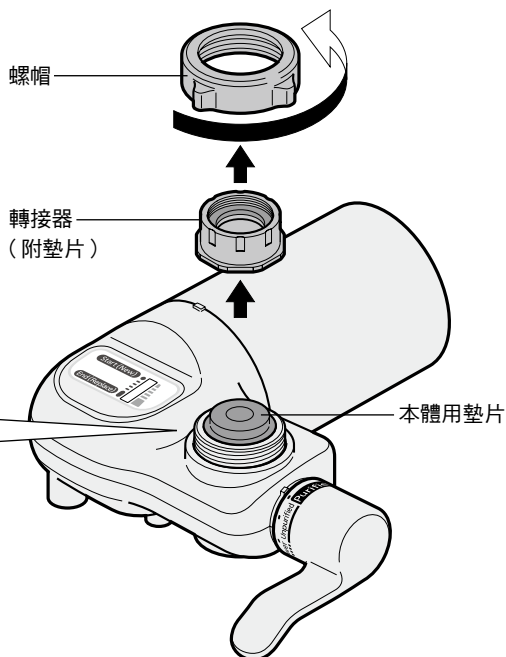
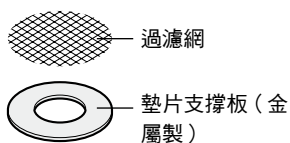

2 卸下充氣器，安上螺帽和轉接器

- 要將轉接器垂直擰緊。斜著擰入的話，會損壞其螺紋，造成漏水。

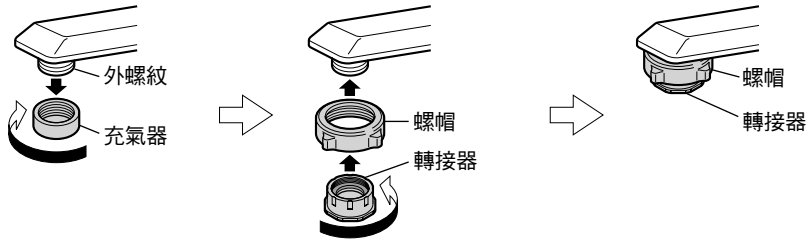
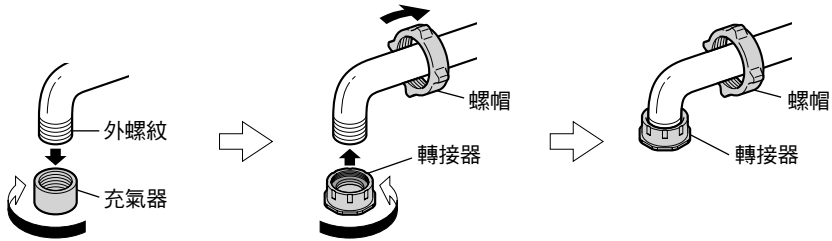

3 用手旋轉螺帽並確實鎖緊

注意事項

- 緊固螺帽時請勿使用工具。
(將導致螺帽損壞。)
- 請勿旋轉本體緊固。
(螺絲部受力太大，將導致本體損壞。)

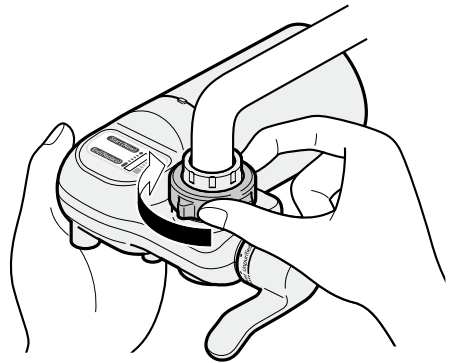

安裝方法

- 請勿連接於熱水專用的水龍頭。

內螺紋水龍頭（螺紋直徑：24 毫米）

水龍頭的種類

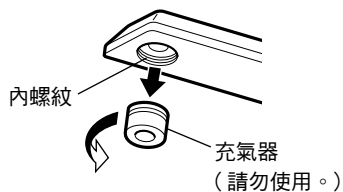

使用配件



密封套
(附有墊片)

1 卸下螺帽和轉接器

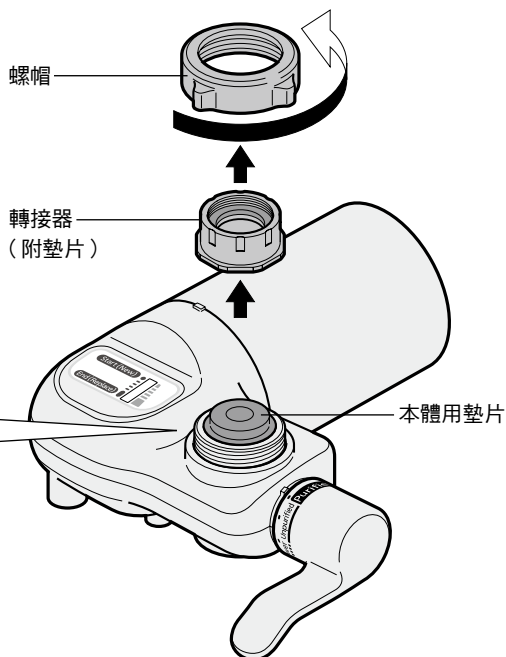

2 擰入密封套。插入轉接器

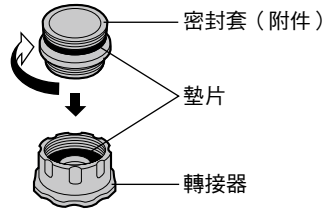

3 安上螺帽和轉接器

- 要將轉接器垂直擰緊。斜著擰入的話，會損壞其螺紋，造成漏水。

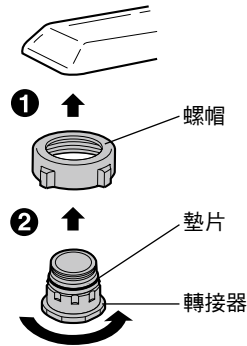

4 用手旋轉螺帽並確實鎖緊

注意事項

- 緊固螺帽時請勿使用工具。
(將導致螺帽損壞。)
- 請勿旋轉本體緊固。
(螺絲部受力太大，將導致本體損壞。)

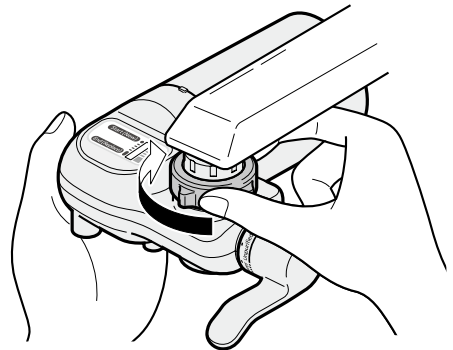

安裝後請確認本體不能輕易轉動、不搖晃。

安裝方法

- 請勿連接於熱水專用的水龍頭。

無充氣器的水龍頭

水龍頭的種類

- 端部呈喇叭型的水龍頭

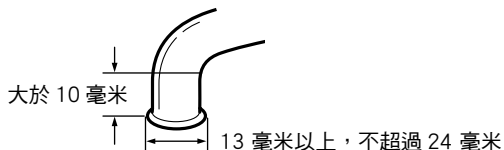

- 直型的水龍頭

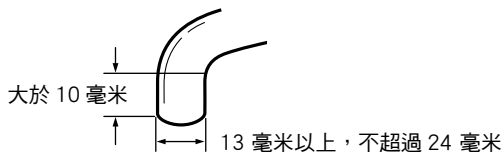

使用配件



安裝轉接器
(附有四個螺絲)

1 卸下螺帽和轉接器

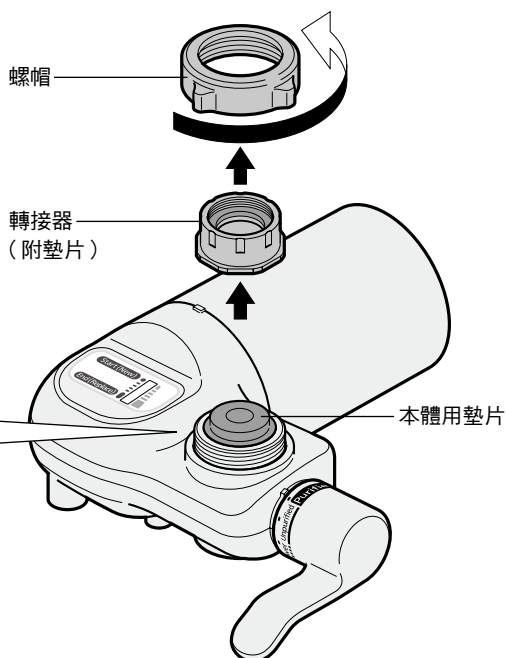

卸下後，請務必將其放回原位。

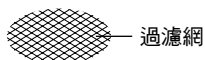

過濾網



墊片支撐板 (金屬製)

2 卸下安裝轉接器的 4 個螺絲，插入安裝轉接器並用螺帽將其緊固

1. 卸下螺絲 (4 個)

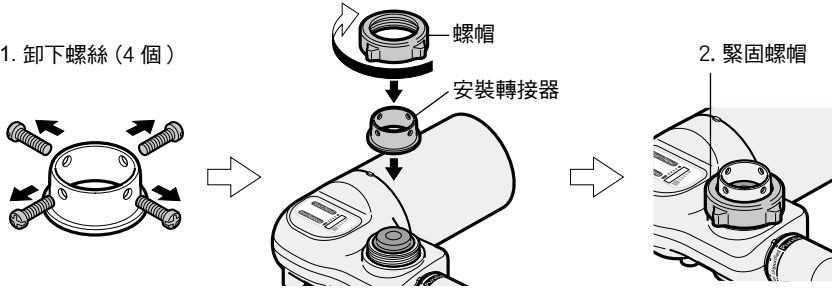

3 先暫時緊固螺絲，再鬆動螺帽

1. 暫時緊固 4 個螺絲

2. 鬆動螺帽，使螺帽和本體間留出
3 毫米~4 毫米的間隙。

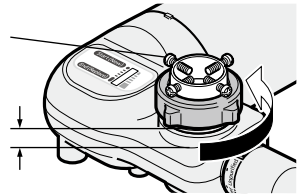

4 將本體用力推入到水龍頭上安裝

1. 用手緊固內方的 2 個螺絲至接觸到水龍頭，並使水管保持於中央。
2. 用螺絲起子緊固其餘 2 個螺絲。

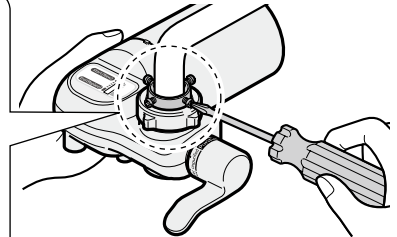
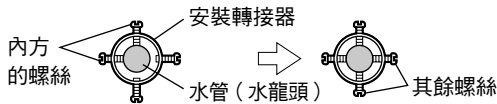

5 用手旋轉螺帽並確實鎖緊

注意事項

- 緊固螺帽時請勿使用工具。
(將導致螺帽損壞。)
- 請勿旋轉本體緊固。
(螺絲部受力太大，將導致本體損壞。)

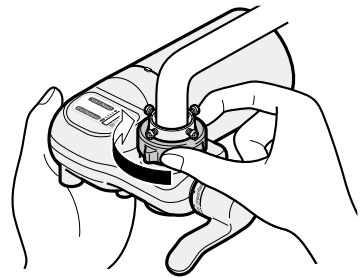

安裝後請確認本體不能輕易轉動、不搖晃。

安裝方法

[僅 TK-CJ21] 將鋰電池放入濾水器（更換）

TK-CJ21 備有提醒您即時更換濾心的感應器，請放入 1 個硬幣型鋰電池。

1 打開電池蓋

- 打開電池蓋之前，請將水份確實擦乾。

請使用類似圓盤的物品往左轉
(附屬的電池不要轉動)

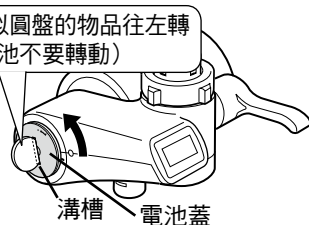

2 放入電池

- 更換電池時，請先取出舊電池。
- 放入電池後，視窗部全面亮燈約 1 秒鐘後，顯示濾心的更換標準。
- 若放入即將沒電的電池，則會顯示更換電池的符號 ()。

可清楚看到+的符號

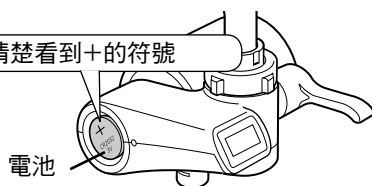

3 關上電池蓋

2. 往右轉

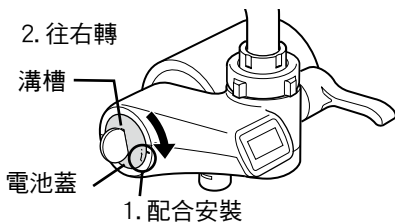

■ 更換電池

視窗部顯示更換電池的符號 () 後，請更換電池。

	閃燈	電池即將用完
	亮燈	電池已用完。 請更換新的電池

- 更換時期的概略標準

- 約 1 年
- 附屬的電池僅供測試用，使用期間可能會較短。

- 更換電池

- 請使用市售硬幣型鋰電池 CR2032。



備註

- 更換電池後，濾心的更換標準不會被重新設定。

注意事項

- 電池的廢棄

使用後的電池請依市町村單位規定的電池廢棄規定處理。

安裝後的確認

請確認是否正確安裝以及是否正常動作。

- 1** 請讓過濾水進行通水約 3~4 分鐘，以利排出本體內的空氣

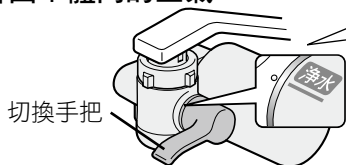

過濾水的排出方法（細節詳見 48 頁）

1. 切換手把切換至「濾水」
2. 打開水龍頭讓水流出

- 2** 確認下列各項目，如有異常請各自採取處置

- 3** 請以油性筆註明濾心的更換月份（濾心的更換標準 53 頁）

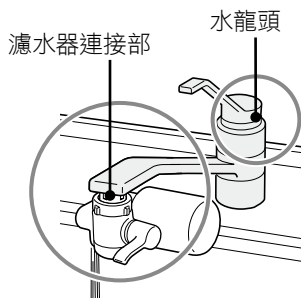
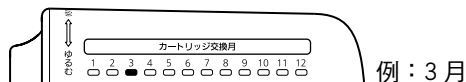

確認項目	異常時的檢查部位與處置	參閱頁數
<p>濾水器連接部有無漏水</p>	<ul style="list-style-type: none"> ● 濾水器是否確實安裝至水龍頭 → 再次確認「安裝濾水器」，並請確實安裝。 ※ 泡沫用轉接器無法旋緊時，請轉動濾水器即可確實緊固。 ● 相關零件是否已正確放入濾水器裡 → 請正確安裝零件。 	40-45
<p>水龍頭有無漏水</p>	<ul style="list-style-type: none"> ● 水龍頭的前端（斷熱蓋等）有無龜裂 → 請接洽水電行。 ● 水龍頭的墊片是否老化 → 請接洽水電行。 	—

使用方法（排水）

排放濾水

請使用低於 35°C 的水溫。（以免造成濾心故障。）

- 不慎誤用 35°C 以上的水時，請讓水通過濾水側約 20 秒鐘。

1 轉動切換手把至「濾水」

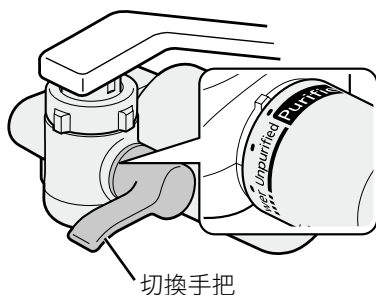

2 打開水龍頭讓水流出

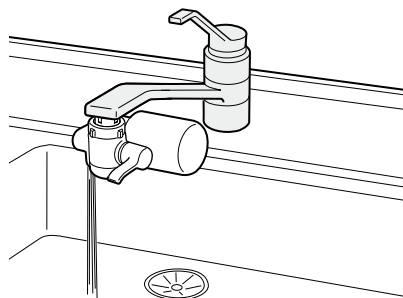
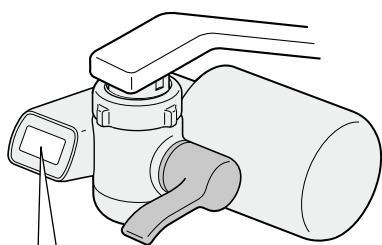

《視窗部》

使用中

（顯示動畫）



關上水龍頭約 10 秒鐘

顯示可使用的剩餘用量(53頁)



關上水龍頭約 10 秒鐘之後

為避免消耗電池，視窗部
在關上水龍頭約 10 秒鐘
後熄燈。

（再次通水時亮燈）

- 流量低於 0.6L / 分鐘以下時視同止水，濾心的剩餘用量會有所改變。

3 結束後關上水龍頭

排放原水（自來水）

請使用低於 80°C 的水溫。（以免濾水器故障）

1 轉動切換手把至「淋灑式口」或「原水」

淋灑式口

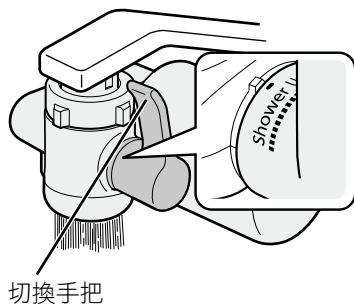

2 打開水龍頭讓水流出

須知

- 淋灑式口的水不規則時：
請打開水龍頭，使用大量的水。

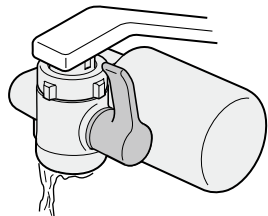

原水

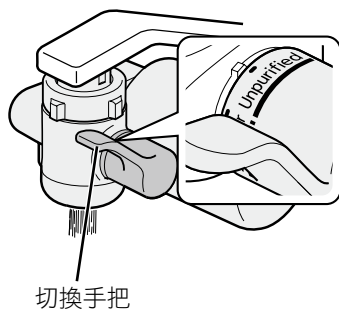

3 束後關上水龍頭

維修保養

平時的維修保養

請使用軟布沾水，擰乾後擦拭。

須知

- 請勿使用洗潔劑、清潔劑、稀釋劑、揮發劑、酒精或燈油等。不慎使用時，請立即灑水沖洗，並將表面的清潔劑等擦拭乾淨。（清潔劑通水混合，可能會導致樹脂龜裂、變色或變形）。
- 請勿使用金屬製的刷具等。（以免刮傷）

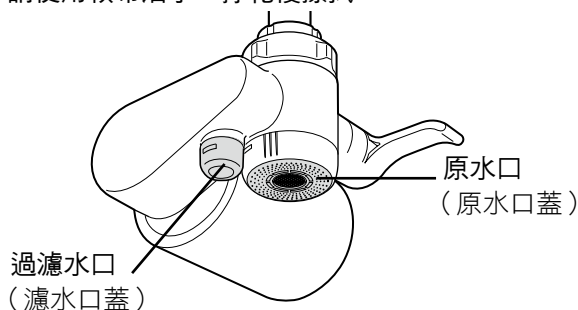

- 濾水器的插圖是以 TK-CJ11/TK-CJ01 為例。

原水口

- 請使用牙刷等刷洗原水口的髒污 ※。
- 拆除原水口蓋後即可清理內部。

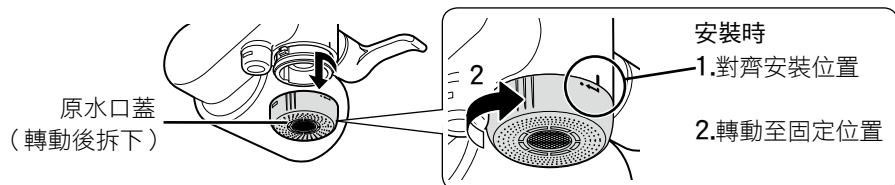

※ 清洗時若有水珠附著，容易造成髒污以及孳生霉菌。
建議於每次使用時或是定期進行維修保養。

濾水口

- 拆除濾水口蓋之後，即可清理內部。

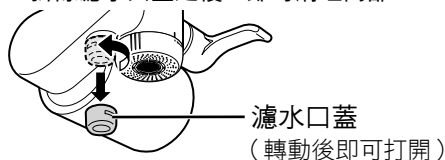

■ 停水時

- 不可使用。
- 使用中停水時，請關閉水龍頭。
- 恢復供水後，切換手把切換至「原水」或「淋灑式口」，首先排放原水（自來水），讓本體內的空氣或混濁的水流出。接著以正常方式使用即可。（讓空氣或混濁的水流入濾水側，可能會嚴重影響到濾心的使用壽命）

1 年 1 次的維修保養

- 請濾水器安裝口的過濾網若有異物堵塞，則水量會變少。
- 請依下列步驟每年進行 1 次清潔。

■ 濾水器安裝口（過濾網、注水口）

- 濾水器的插圖是以 TK-CJ11/TK-CJ01 為例。

1 鬆開螺帽，拆除濾水器，分別取出過濾網、墊片、墊片支撐板。

- 切換手把切換至「濾水」。
- 濾水器本體略為轉動，有助於鬆開螺帽。

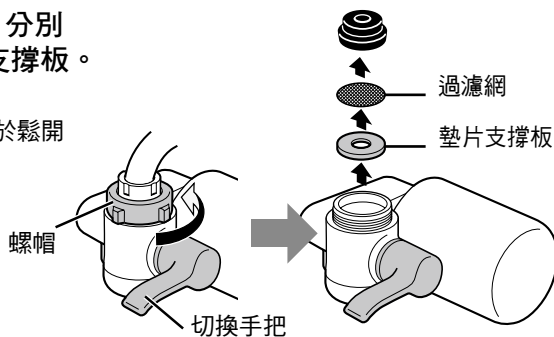

（例：使用泡沫用轉接器安裝時）

2 清洗過濾網與注水口。



3 安裝濾水器。

- 請務必裝上過濾網。
- 安裝後，以「原水」或「淋灑式」讓水排放約 5 秒鐘。

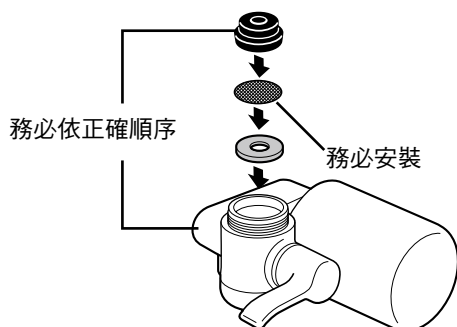

（例：使用泡沫用轉接器安裝時）

確實旋緊螺帽。

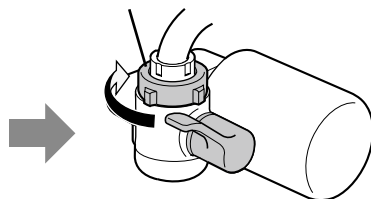

須知

- 旋緊螺帽時，請勿使用工具。（以免螺帽破損）

維修保養

墊片、過濾網的更換

墊片 ※ 濾水器的插圖是以 TK-CJ11/TK-CJ01 為例。

- 安裝至水龍頭時，必須使用如下圖所示之墊片。
- 長期使用時，可能會因為橡膠劣化、變形、刮傷而導致漏水。

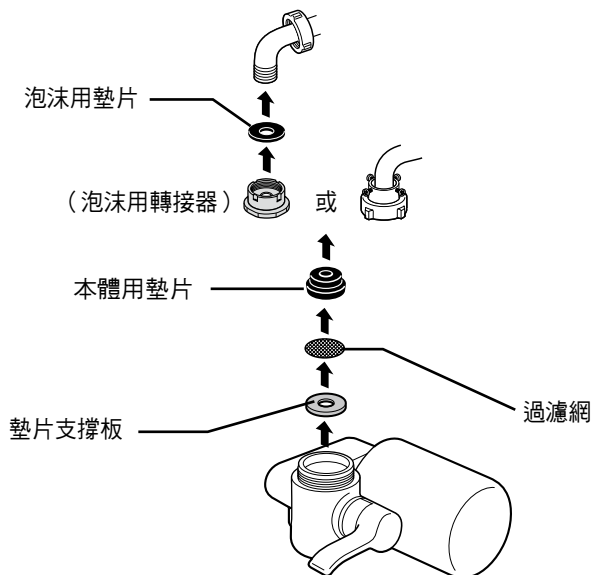

吐水量變少時

(1) 過濾網堵塞



- 過濾網會將附著在水管的大型異物（水垢、鏽化物等）去除。
- 若在過濾網拆除的狀態下使用，恐導致濾水器故障。

(2) 過濾網堵塞以外的情形

- 水溫過低（水難以通過濾心）時
- 在水壓偏低的地區（70kPa 以下）使用時
- 該地區的自來水水壓偏低、水管工程施工後等停水時
- 濾心堵塞

更換濾心

- 屆滿使用壽命、濾水能力減弱的濾心，請更換新的濾心。

型號	TK-CJ21/TK-CJ11	TK-CJ01
更換用濾心型號：	 TK-CJ21C1 59 頁	 TK-CJ01C1 59 頁
更換濾心的概略標準	總通水量：4000 公升 ※1	總通水量：2000 公升 ※1
	※1 家庭用濾水器試驗方法：JIS S3201 的數值	
使用期限的概略標準	每天使用 10 公升時：約 1 年 每天使用 20 公升時：約 6 個月	每天使用 10 公升時：約 6 個月 每天使用 20 公升時：約 3 個月

須知：即使使用量未變少，下列情形仍請即時更換。

- 出現異味或口感有異樣時
(濾心除去異物的功能減弱)
- 濾水的流量明顯變少時
(濾心堵塞)
- TK-CJ21/TK-CJ11 使用期間超過 1 年時
- TK-CJ01 使用期間超過 6 個月時



請更換濾心
(57 頁)

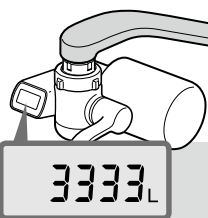

[僅 TK-CJ21]

- 根據視窗部確認濾心可使用的剩餘用量 (關上水龍頭 10 秒鐘)
- 10 秒鐘顯示達到總通水量 (4000 公升) 之前的剩餘用量。
- 累計通水量。

屆滿更換標準之前的剩餘用量若低於 150 公升以下，剩餘用量會如下所示的燈號閃爍。

例：剩餘 150 公升



當屆滿剩餘用量時，以下的燈號會交替顯示

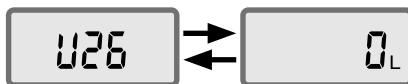

請在剩餘用量達到「0 L」之前，即時更換濾心。

更換濾心

關於濾心除去異物的性能

- 可除去的物質

- | | |
|--|---|
| <ul style="list-style-type: none">● 游離殘留氯● 總三鹵甲烷 ※1● 2-MIB（霉味）● 鐵（微粒子狀）※2● 土臭素（霉味）※2 | <ul style="list-style-type: none">● 髒汙● 溶解性鉛（僅 TK-CJ21/TK-CJ11）● 鉛（中性）※2● 苯酚類 ※2 |
|--|---|

※1 三氯甲烷、溴二氯甲烷、二溴氯甲烷、溴甲烷之 4 種化合物的總稱。

※2 依濾水器協會（JWPA）制定之規格基準（JWPAS B 基準）所規定的除去對象物質。

- 不同的水質各有不同的使用期限

濾心內置中空系膜過濾網，有助於除去細小的髒汙。

因此，水質內含大量引起堵塞的物質時，使用期限會縮短。

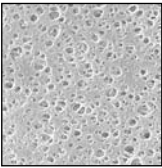

中空系膜表面
（新的濾心）

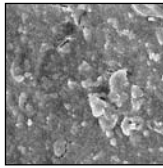

有異物堵塞的
中空系膜表面

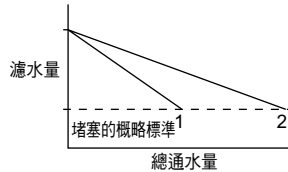

1 內含大量引起堵塞物質的水質
2 標準水質

- 無法除去輻射物質。

註釋

- 一般自來水的堵塞程度會因水質（混濁、鐵鏽等）、水壓而各有明顯的不同。

濾心的更換方法

- 請先關上水龍頭。
- 此外，在濾心拆除的狀態下切勿通水。以免水溢出。

1 拆除舊濾心

- 請將舊濾心拆下置於水槽內。(以免滴水)
- 按右圖所示之箭頭方向轉動後，即可拆除濾心。

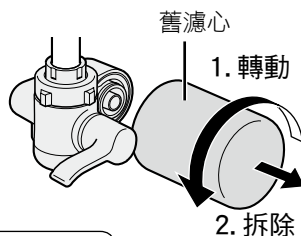

2 更換新的濾心

- 請以油性筆註明濾心的更換月份

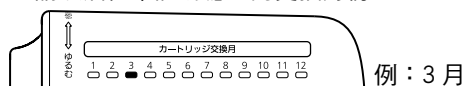

- 濾心往箭頭方向按入
- 慢慢往箭頭方向轉動直到停止
- 濾心切勿過度旋緊。
(以免濾心安裝部破損，造成漏水。)

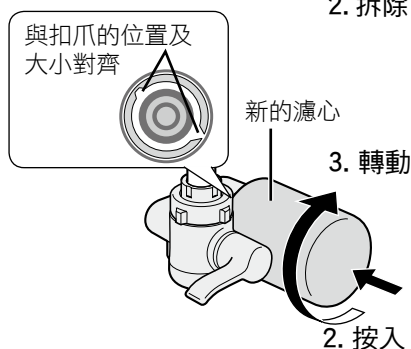

[僅 TK-CJ21]

- 按下重新設定按鈕 (約 3 秒鐘)
(切勿使用牙籤等前端尖銳物品等按壓。可使用牙籤的另一端或前端不尖銳的物品等按壓。)
- 濾心可使用的剩餘用量顯示恢復為「4000L」。

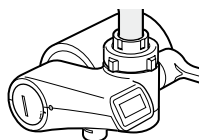

3 打開水龍頭，切換手把切換至「濾水」，讓本體通水 (約 3~4 分鐘)。

- 通水中，請確認濾心安裝部有無漏水。

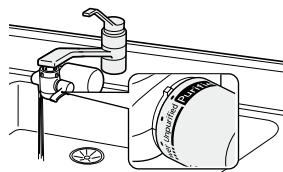

須知

- 使用後的濾心依地區規定的條例廢棄。
(濾心外殼材質為 ABS 樹脂。濾材的種類請參閱「規格」封底。)

[僅 TK-CJ21]



- 在濾心仍有剩餘用量而要更換濾心時，請務必持續按住重新設定按鈕，直到顯示「4000L」為止。(約 3 秒鐘)〔為了正確顯示濾心的剩餘用量〕

故障排除

疑似故障時，送修前請確認下列事項。

異常時，請洽詢經銷商，切勿自行修理。

現象	原因與應變處理內容	參閱頁數
<p>濾水量變少或 流不出濾水</p>	<ul style="list-style-type: none"> ● 水龍頭是否關的太緊？ → 請打開水龍頭。 ● 水壓會不會太低？ → 請將水龍頭全開。 	—
	<ul style="list-style-type: none"> ● 濾水器內的過濾網有無堵塞？ → 請將過濾網清洗乾淨。 	51
	<ul style="list-style-type: none"> ● 濾心是否確實安裝？ → 請確實安裝。 	55
	<ul style="list-style-type: none"> ● 是否停水？ → 請等候恢復供水。 	50
	<ul style="list-style-type: none"> ● 濾心的堵塞等會讓流量變少。 → 並非故障。 可能是濾心即將屆滿更換期限。 	53, 54
<p>持續出現異味、 奇怪的口感、混濁等</p>	<ul style="list-style-type: none"> ● 濾心除去異物的能力減弱。 → 請更換濾心。 	53 - 55
<p>濾心更換後的 濾水量變少</p>	<ul style="list-style-type: none"> ● 因為濾心內仍殘留空氣。 → 並非故障，請通水約 3~4 分鐘。 	—
<p>[僅 TK-CJ21] 視窗部突然消失</p>	<ul style="list-style-type: none"> ● 為避免消耗電池，未使用時，視窗部會自動熄燈。 → 並非故障。 	48

現象	原因與應變處理內容	參閱頁數
<p>[僅 TK-CJ21]</p> <p>出現下列顯示</p> 	<ul style="list-style-type: none"> ● 超出濾心的更換標準的總通水量 (4000 公升) → 請更換濾心。 ● 濾心更換後，是否記得按下重新設定按鈕？ → 請按下重新設定按鈕。(約 3 秒鐘) 	55
<p>[僅 TK-CJ21]</p> <p>出現下列顯示</p> 	<ul style="list-style-type: none"> ● 需要更換電池。 → 請更換電池 (硬幣型鋰電池：CR2032) 	46

■ 漏水時

漏水處	原因與應變處理內容	參閱頁數
<p>濾水器連接部</p>	<ul style="list-style-type: none"> ● 濾水器是否確實安裝至水龍頭？ → 請確實安裝。 ※ 泡沫用轉接器無法旋緊時， 請稍微轉動濾水器，即可確實緊固。 ● 相關零件是否已正確放入濾水器裡？ → 請正確安裝零件。 ● 水龍頭 (隔熱蓋等) 的前端有無龜裂？ → 請接洽水電行。 	40 - 45
<p>濾心安裝部</p>	<ul style="list-style-type: none"> ● 濾心是否確實安裝？ → 請確實安裝。 	55
<p>水龍頭部份</p>	<ul style="list-style-type: none"> ● 水龍頭部位的墊片是否已老舊？ → 請接洽水電行。 	—

常見問題 (Q&A)

以下列舉常見的問題。

使用方法

Q1	服藥時，可直接飲用「濾水」嗎？
	服藥時，可直接飲用「濾水」。 除了服藥以外，烹調也可以使用濾水。
Q2	濾水可保存幾天？
	常溫下請於 24 小時內使用。 由於濾水是將自來水當中的氯（殺蟲劑）除去，因此容易孳生一般細菌。 放置於冰箱內時，請先放入乾淨的密閉容器，並於 2 天內使用。
Q3	濾水為什麼看起來亮亮的？那是什麼？
	析出溶於水的成份（主要是礦物質）。 濾心的功能減弱時，也會出現相同的現象，屆時請更換新的濾心。
Q4	無法除去鉛（溶解性鉛）嗎？
	TK-CJ21/TK-CJ11: 可以除去。 TK-CJ01 : 無法除去。

維修保養

Q5	長期（概略：約 1 週以上）未使用時，應如何處理？
	<ul style="list-style-type: none">● 先從濾水器拆除濾心，放入塑膠袋內，排出空氣後將開口密封，置入冰箱內保存。● 再次使用時，裝上濾心，通水約 3 分鐘後，確認有無漏水以及動作或顯示是否異常。 超過 1 個月以上未使用時，濾心內的水會變質，建議您最好更換濾心。

其他

Q6	總三鹵甲烷是什麼？
	三氯甲烷、溴二氯甲烷、二溴氯甲烷、溴甲烷之 4 種化合物的總稱
Q7	2-MIB 是什麼？
	2- 甲基冰片的簡稱，也是造成自來水出現霉味的物質之一。

選購品 (截至 2012 年 3 月所訂定的價格。)

請至所購買之經銷商或販售 PANASONIC 產品之經銷商選購。
使用方法、安裝方法請詳閱各附件的操作說明書。

耗件

- 更換用濾心 ★ 55 頁
TK-CJ21/TK-CJ11 用
型號：TK-CJ21C1
零售價：6,800 日圓 (含稅)



- TK-CJ01 用
型號：TK-CJ01C1
零售價：5,300 日圓 (含稅)

選購品

- 大型水龍頭用金屬蛇口
型號：P-06JRC



規格

規格

型號	TK-CJ21	TK-CJ11	TK-CJ01
尺寸	長度 135mm × 寬度 125mm × 高度 75mm	長度 125mm × 寬度 110mm × 高度 75mm	
重量	約 350g (滿水時：約 490g)	約 310g (滿水時：約 450g)	
本體可使用的水溫	濾水側：低於 35°C (原水/淋灑式：低於 80°C)		
可使用的最低動水壓	70kPa		
過濾能力	1.8L/分鐘〔水壓 100kPa 時〕		
配備的濾心	TK-CJ21		TK-CJ01C1
濾材效果	游離殘留氯	4000L	2000L
	磷汙	4000L	2000L
	總三鹵甲烷	4000L	2000L
	2-MIB (霉味) *1	4000L	2000L
	溶解性鉛	4000L	—
上述以外可 除去的物質	鐵 (微粒子狀) *4	●	●
	鋁 (中性)	●	●
	土臭素 (霉味) *4	4000L	2000L
	苯酚類	4000L	2000L
更換濾材 (濾心) 的 更換概略標準 *3	約 1 年 (每天使用 10L) 〔約 6 個月 (每天使用 20L)〕		約 6 個月 (每天使用 10L) 〔約 3 個月 (每天使用 20L)〕
材料種類	ABS 樹脂		
濾材成份	不織布、粒狀活性碳、 陶瓷、中空系膜		不織布、粒狀活性 碳、中空系膜
無法除去的物質	溶於水的鐵、重金屬類 (銀、銅等)、鹽份 (海水)		

* 數值是指在水溫 20°C時適用

* 無法將硬水轉變為軟水。

*1 依 JIS S3201 試驗，除去率 80% 的數值。

*2 依 JIS S3201 試驗，過濾流量 50% 的數值。

*3 可能會因使用的水量、水質、水壓而有大幅縮短的情況。

*4 依濾水器協會 (JWPA) 制定之規格基準 (JWPAS B 基準) 實施試驗後所得除去率 80% 的數值。
而對於鐵 (微粒子狀) 與鋁 (中性) 則並未規定濾水能力。