

Setup Instructions

Wireless LAN Module (built-in)



設定説明書
無線區域網路模組 (內建) 2-28
請細讀此設定說明，並保存此書以備日後參考。

Setup Instructions 29-60
Wireless LAN Module (built-in)
Please read these Setup Instructions thoroughly and keep them for future reference.



內建網絡，允許從任何地方控制空調器裝置的運轉。

感謝您購買此 Panasonic 產品。

目錄

安全措施	2-3
系統概述	4-5
開始使用	6
應用程式設定	7-16
如何使用	17-23
網絡適配器和應用程式常見問題解答	24-26
故障檢修	27
信息	28

安全措施

在遠端位置嘗試透過無線通訊控制/操作該空調器產品之前，請確保檢查裝置的安裝及其周圍區域，並警惕附近的任何人。

為了防止個人傷害，危害其他人或財物的損失，請遵守以下指示。

因不遵守以下指示導致的錯誤操作將引起傷害或損壞，其嚴重程度分類如下：

 警告	此標識所示的行為有可能導致嚴重傷害或死亡。
--	-----------------------

 注意	此標識所示的行為有可能導致傷害或財產損失。
--	-----------------------

要遵守的指示按下列符號分類：



此符號表示被禁止的行為。



此符號表示務必執行的行為。



警告

網絡（已啟用）



請勿在任何醫療設備或自動控制設備（自動門、火警設備等）附近使用空調器。
（室內機的無線電波可能會干擾設備，可能導致設備故障而發生意外）

安全措施



如果您裝有心臟起搏器，請與空調器保持至少 15 cm 的距離。
(無線電波可能干擾起搏器的工作)



注意

網絡 (已啟用)



提前檢查以下要求(在家):

- 完全插入電源。確保沒有灰塵積聚在電源上。
(這可能導致電源接觸不良而打火，從而引起火災)
- 檢查其他人設定的定時器啟動狀態。
(意外的停止運行操作可能對人體、寵物和植物造成傷害)
- 空調器不應該有任何異常，如氣流變化。確保沒有任何物件因氣流直接吹向它而容易移位。掉落或移動的物件可能導致火災、人身傷害等危險。
- 任何時候，如有可能無法自行控制溫度而依賴於空調器的預設配置的人(例如嬰兒、兒童、殘疾人、長者或病人)，請使用內部遙控器。
由於遙控操作而引起的溫度升高和降低，可能使居住者感到不適和/或擾亂他們的日常生活。
植物和動物可能受溫度突然調節的影響。



從遠端位置操作空調器之前，請檢查以下要求：

- 請告知空氣調節區域附近的人，您將遙控空調器的操作和設定。以此避免因被驚嚇或溫度突然變化(從舒適到寒冷，或反之)而對人造成嚴重影響的任何可能性。
(由於室外溫度和室內溫度的突然變化，這可能對人體造成傷害。溫度調節可以通過遙控器操作)
 - 如果 **Panasonic Comfort Cloud** 應用程式的主畫面未顯示操作狀態，請使用內部遙控器操作空調器。
- 由於該應用程式使用網絡通訊，因此有時可能因通訊和/或網絡故障(例如 **Panasonic** 雲端伺服器停機、電信提供商的伺服器停機、**WIFI** 連接等)而無法進行遠端操作。如果發生此類故障，請使用內部遙控器操作空調器。

系統概述



您需要準備的物品 (另行購買和訂購)

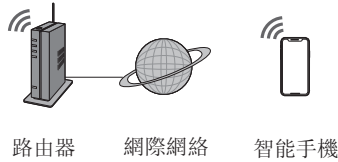

從應用程式商店下載



Panasonic Comfort Cloud
應用程式 (免費)

- 此功能需要應用程式與智慧手機配合使用。請檢查每個商店以獲取支援的作業系統版本。
- 網路專門設計為“Panasonic Comfort Cloud”應用程式的端子。
- 無線區域網路覆蓋必須到達窗口機安裝位置。

規格 - 內置網路 - (2個二維碼) *

型號	PIOT-V2(WA)
輸入電壓	DC 5V (來自空調器)
電流消耗	Tx/Rx 最大 190/70 mA
無線標準	IEEE 802.11 b/g/n; 低功耗藍牙5.0 (BLE)
頻率範圍	2.4 GHz 頻帶
加密	WPA™ / WPA2™ / WPA3™

在 PIOT-V2(WA) 頻帶中傳輸的最大無線電頻率功率

無線的類型	頻帶	最大 EIRP (dBm)
無線區域網路	2412 - 2472 MHz	20 dBm
BLE	2402 - 2480 MHz	20 dBm

* 兩者中任一特定的網路需納入相應的空調器型號中。請務必向銷售人員進行確認。

預先注意事項

- 請勿以任何方式拆卸或改裝此網絡。
- 請勿在操作期間從空調器移除此網絡。
- 通過無線電波發送和接收的數據可以被截取和監視。

使用注意事項

- 使用產品前，請務必閱讀本手冊中的所有注意事項以正確使用。對於您或第三方因錯誤使用或在使用過程中發生的因使用本產品而引起的故障，除非承認，否則本公司不承擔任何法律責任。

安全措施

- 無線區域網絡使用無線電波交換資訊。因此，存在未經授權存取的風險。
- 在處置或轉讓給第三者之前，請初始化產品上的應用程式設定。

設定網絡連接之前

- 確認無線路由器已正確連接到網絡。
- 確認智能手機的無線區域網絡已啟動。
- 確認您的智能手機和本產品已連接到同一無線路由器。

應用程式安裝

Android 使用者

- 打開 。
- 搜尋 “Panasonic Comfort Cloud” 應用程式。
- 下載並安裝。

iOS 使用者

- 打開 。
- 搜尋 “Panasonic Comfort Cloud” 應用程式。
- 下載並安裝。

備註

- 應用程式使用者介面圖像可能在未通知的情況下隨版本升級而更改。
- 使用此應用程式是免費的。但連接和操作可能會產生其他費用。

開始使用

操作之前和操作期間檢查應用程式的連接狀態。如果未顯示狀態，請使用遙控器操作空調器。

啟動“Panasonic Comfort Cloud”

建立新的 Panasonic ID

使用“Panasonic Comfort Cloud”應用程式作為控制空調器的選項。

- 對於新使用者，選擇“Create new Panasonic ID”以註冊。
- 對於已註冊的使用者，使用您的 Panasonic ID 和密碼登入。

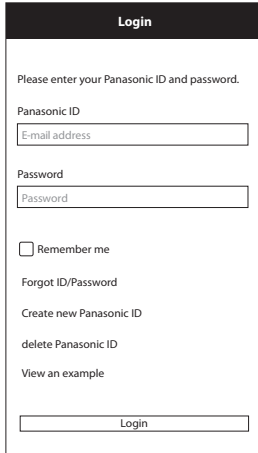

The image shows a login interface for the Panasonic Comfort Cloud application. The page has a dark header with the word "Login" in white. Below the header, the text "Please enter your Panasonic ID and password." is displayed. There are two input fields: "Panasonic ID" with a placeholder "E-mail address" and "Password" with a placeholder "Password". Below these fields is a checkbox labeled "Remember me". At the bottom of the form, there are four links: "Forgot ID/Password", "Create new Panasonic ID", "delete Panasonic ID", and "View an example". A "Login" button is located at the very bottom of the form area.

應用程式設定

新增新的空調器設備

在使用“Panasonic Comfort Cloud”應用程式之前需要註冊空調器。

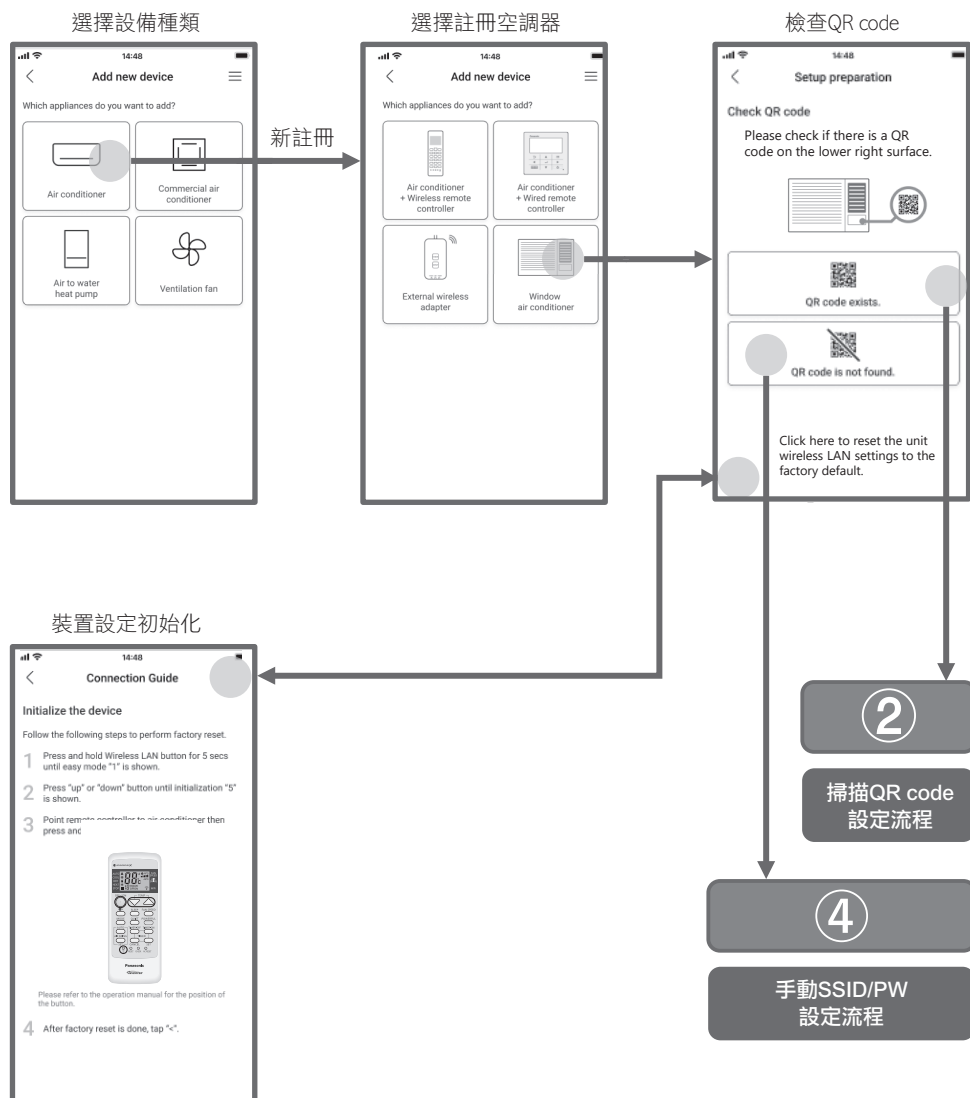

應用程式設定

變更空調設備或路由器

在使用“Panasonic Comfort Cloud”應用程式之前需要註冊空調器。

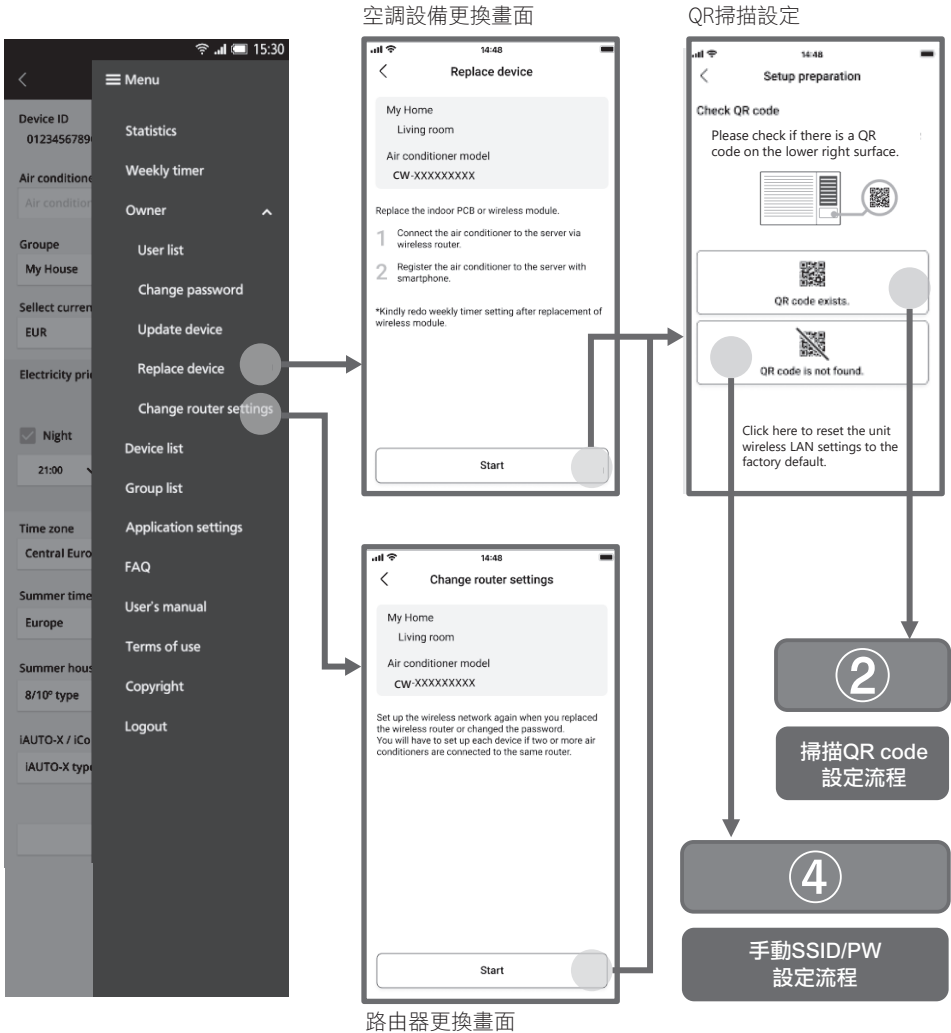

設定連接網絡(無線遙控器)

使用 QR 掃描設定

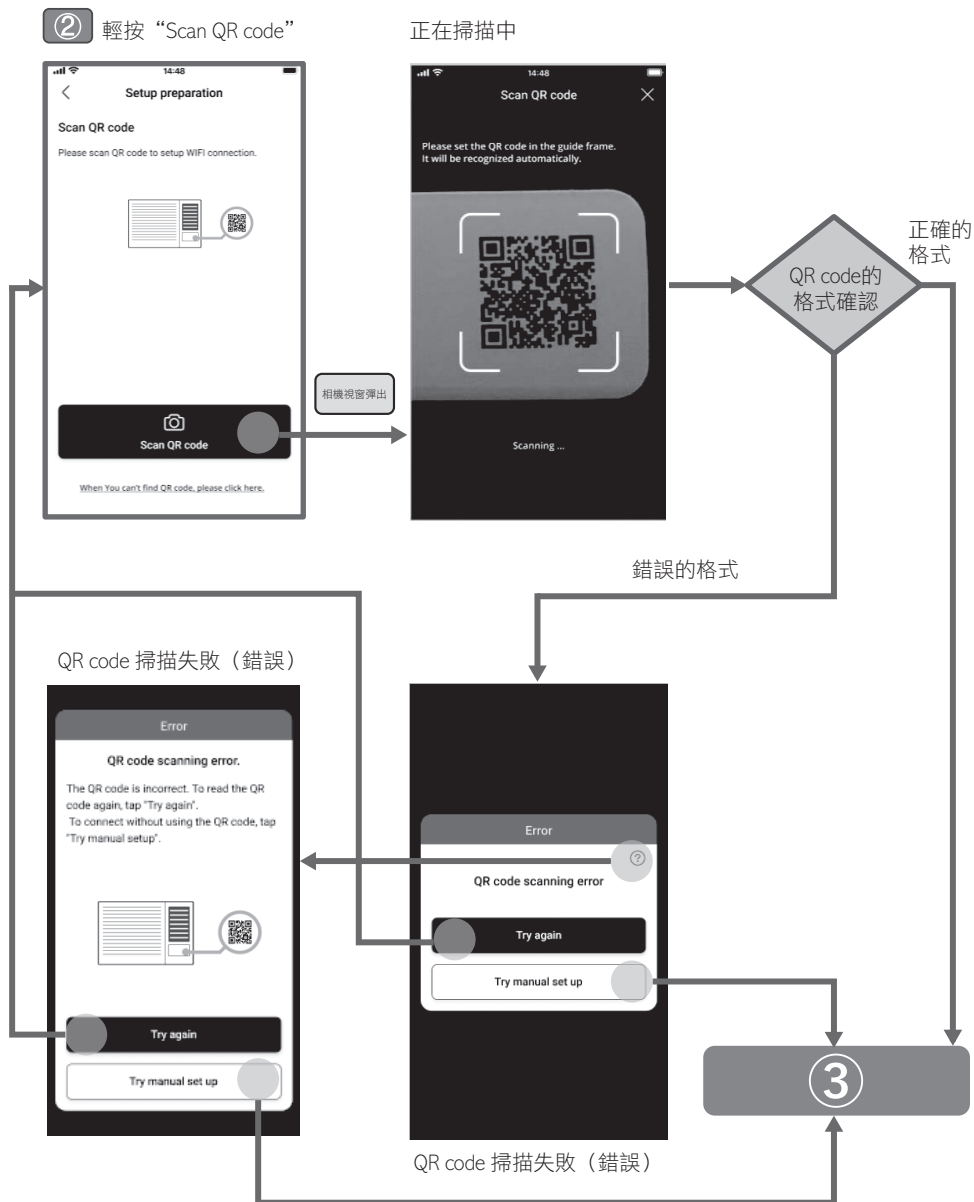

應用程式設定

設定連接網絡(無線遙控器)

使用 QR 掃描設定

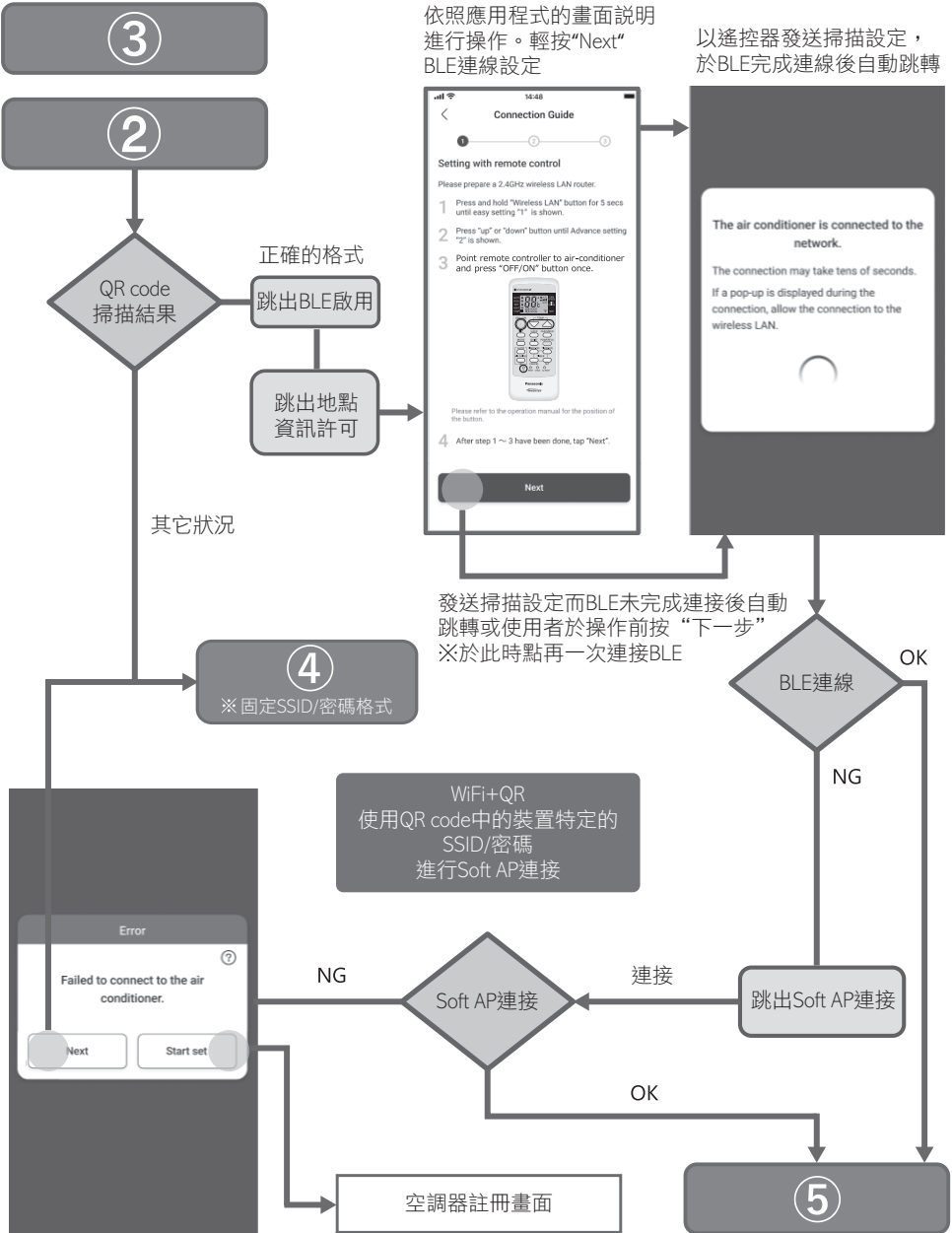

設定連接網絡(無線遙控器)

使用 AP 模式設定

4

3

固定SSID/密碼格式

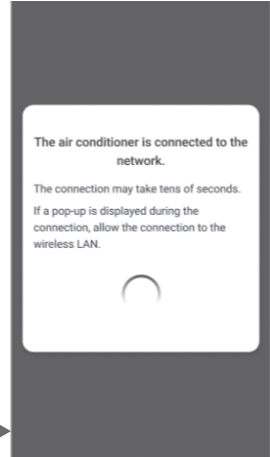

依照應用程式的畫面說明進行操作。輕按“Next”
WAC (V2) 固定SSID連線說明

跳出地點資訊許可

跳出Soft AP連線

註冊裝置密碼

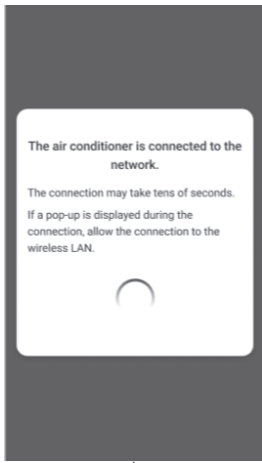

Soft AP
連線完成

5

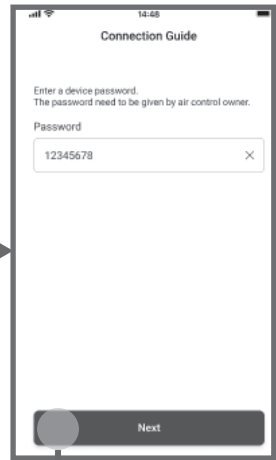

應用程式設定

設定連接網絡(無線遙控器)

路由器連接確認

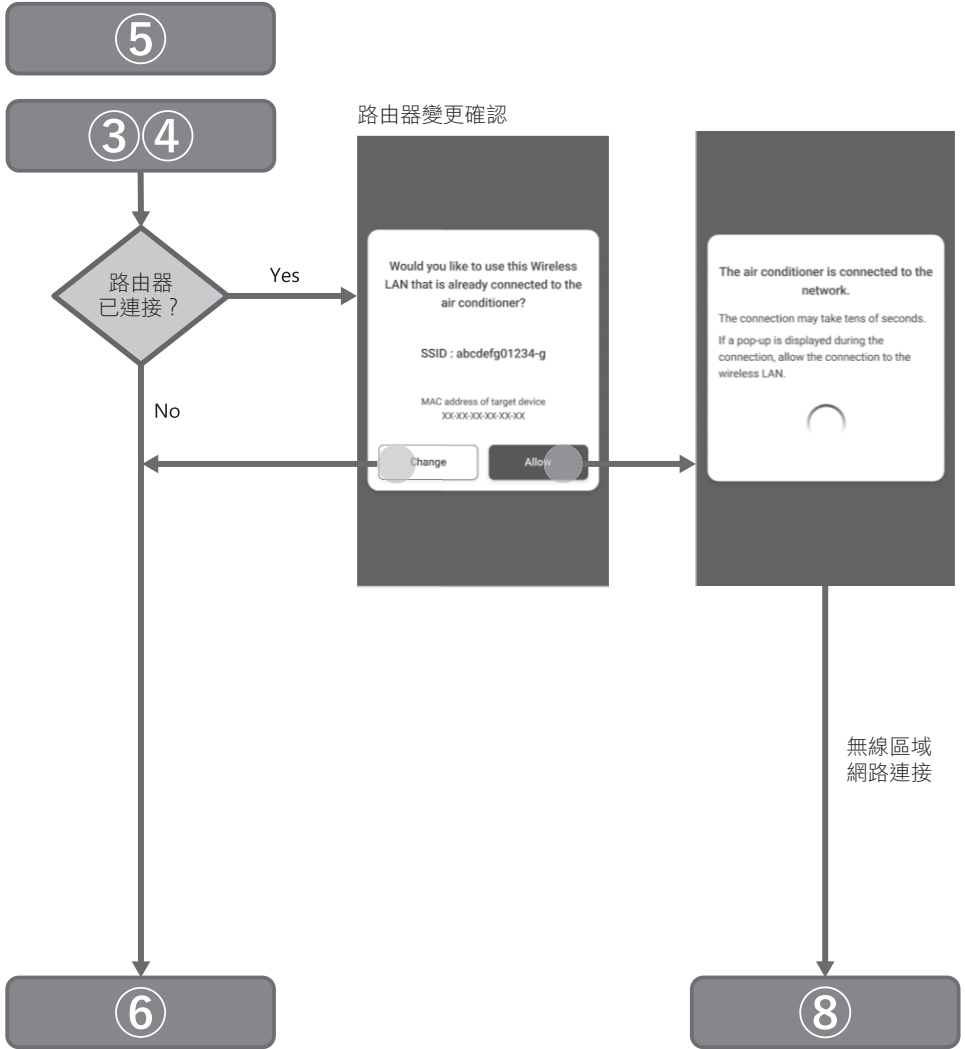

設定連接網絡(無線遙控器)

路由器連接選擇

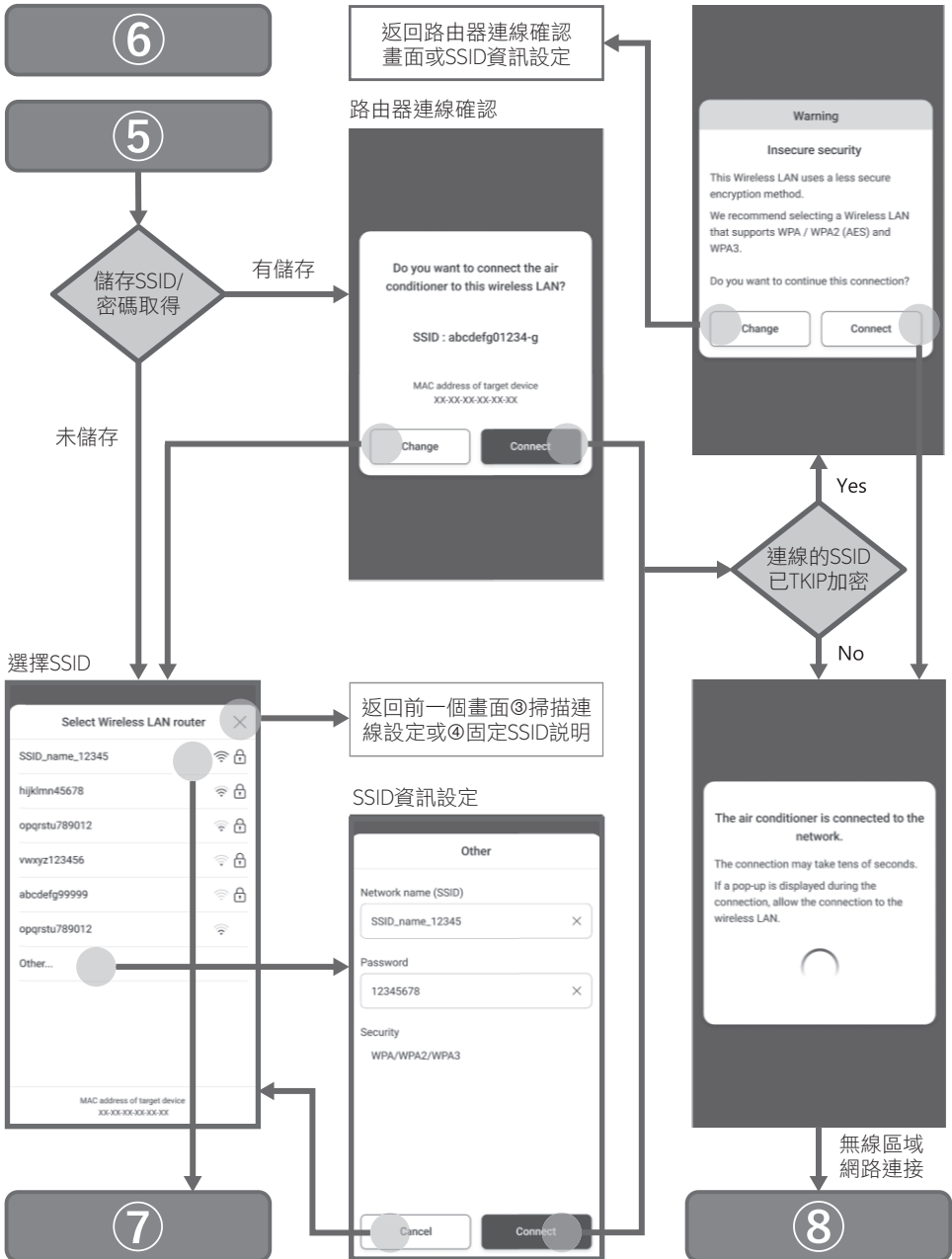

應用程式設定

設定連接網絡(無線遙控器)

路由器連接確認

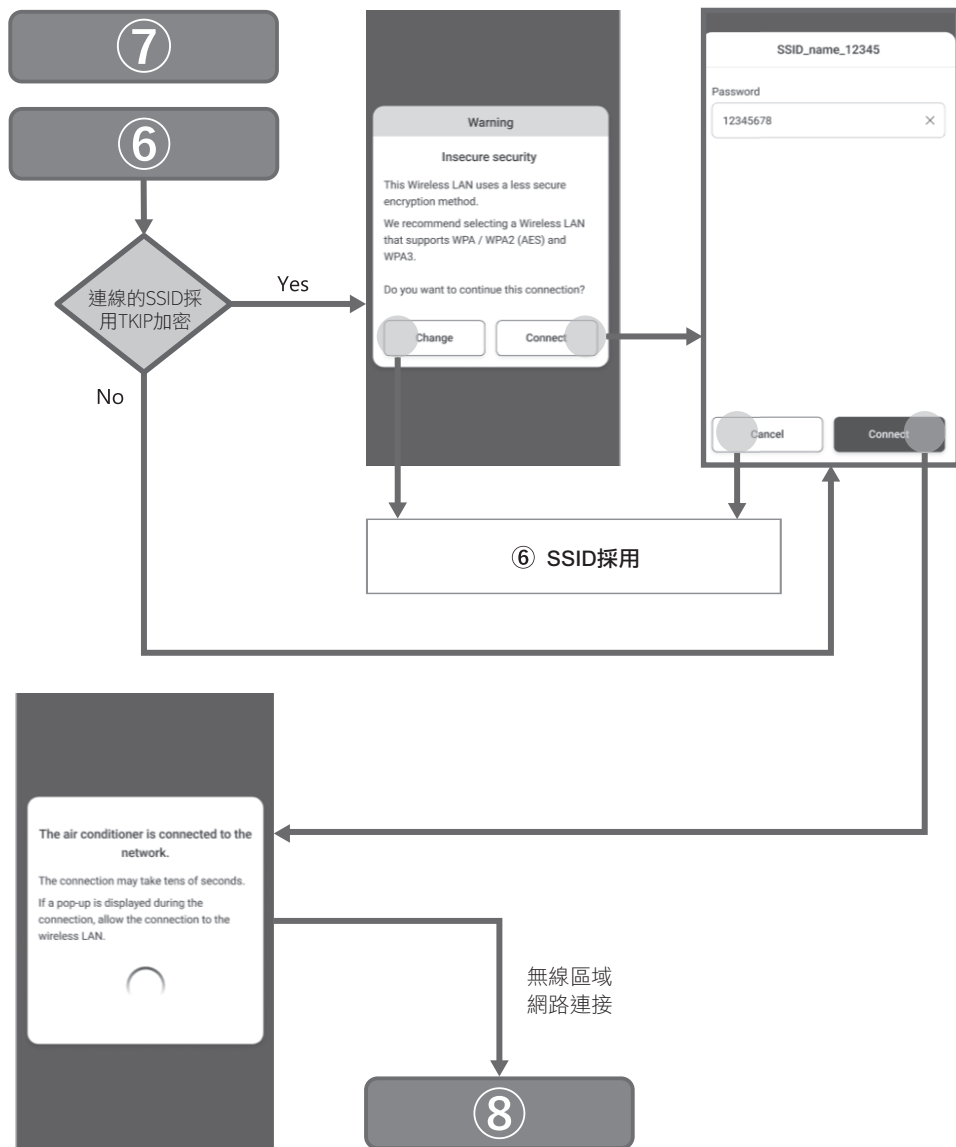

設定連接網絡(無線遙控器)

設備註冊確認

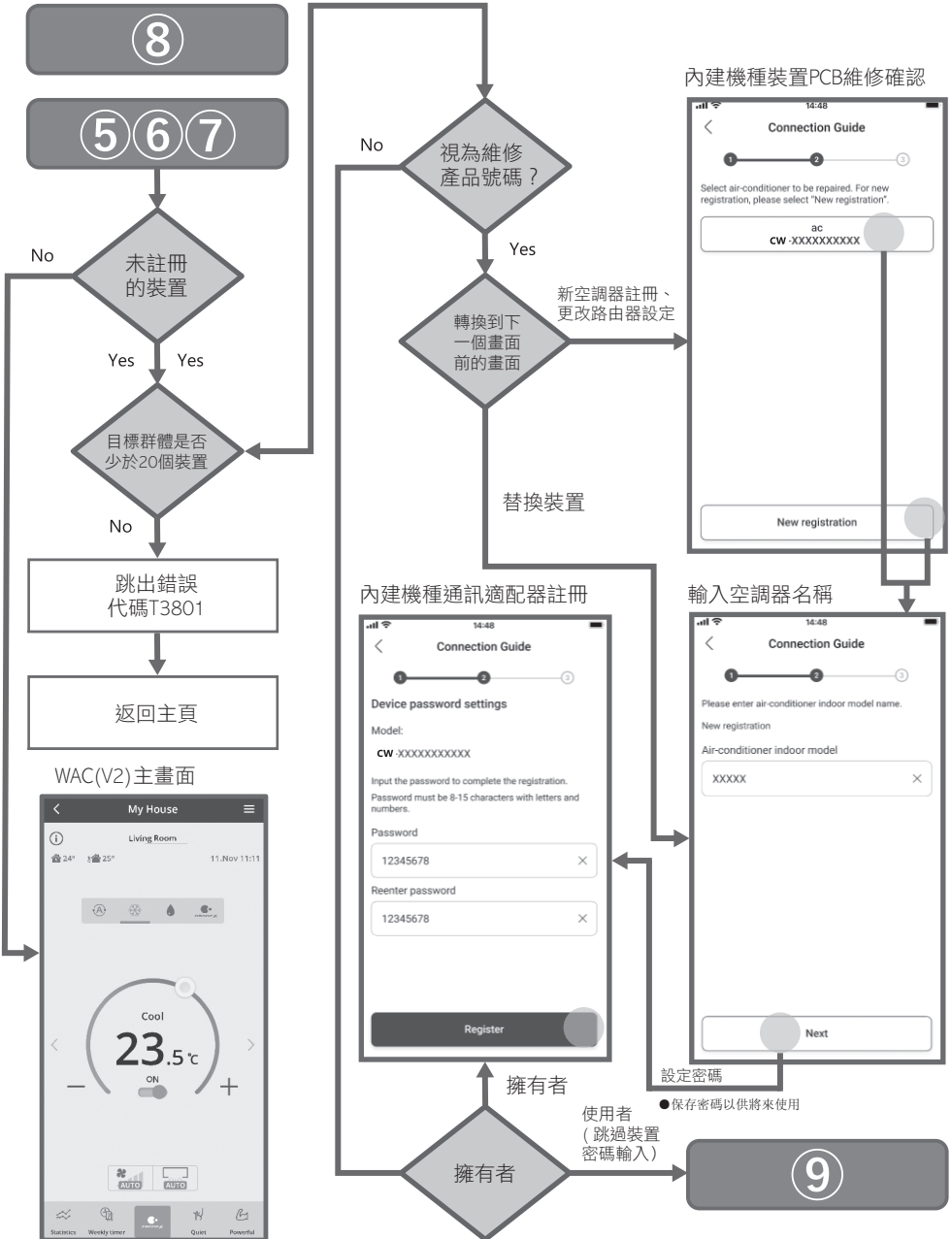

應用程式設定

設定連接網絡(無線遙控器)

擁有者(使用者)設備登入與分享



如何使用

註冊已完成

- ① 在註冊以及在應用程式和空調器之間建立連接後，設定首選名稱以輕鬆識別您的空調器。
 - 在為空調器註冊首選名稱後，您可以使用“Panasonic Comfort Cloud”應用程式功能。
- ② 除了操作控制之外，該應用程式還可以通過參考統計圖來監控估計的能耗並針對不同時間段進行比較。



備註

- 操作之前和操作期間檢查應用程式的連接狀態。如果未顯示狀態，請使用遙控器操作空調器。

如何使用

啟動應用程式

- ① 登入“Panasonic Comfort Cloud”應用程式。
- ② 選擇您要控制的空調器。

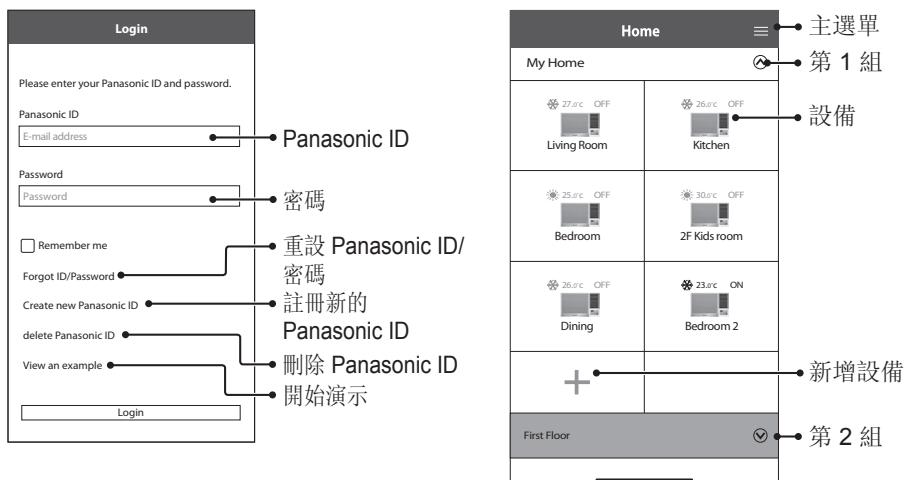

主畫面 - 操作設定

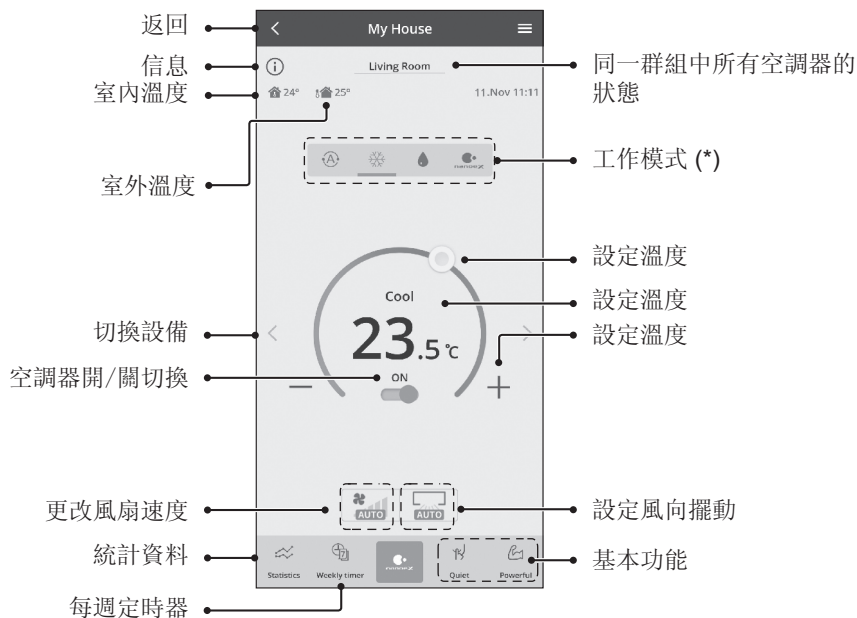

(*) 受型號相容性影響

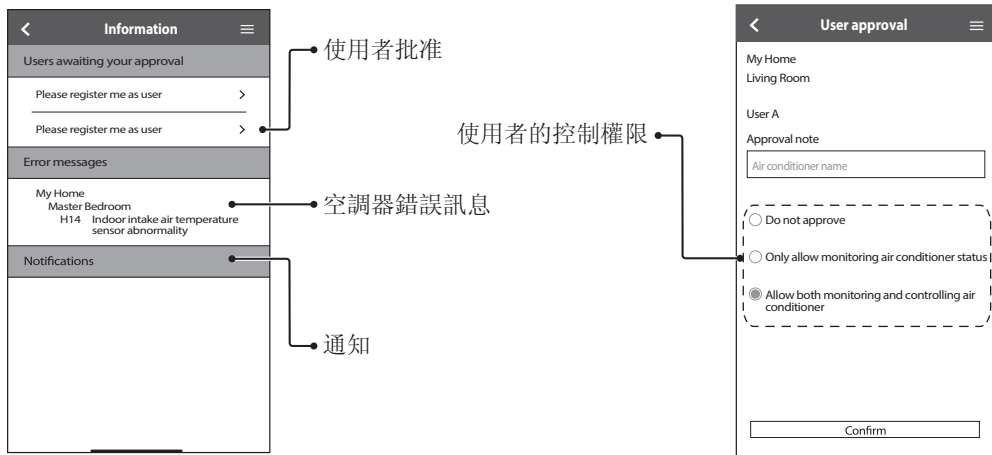

空調器狀態

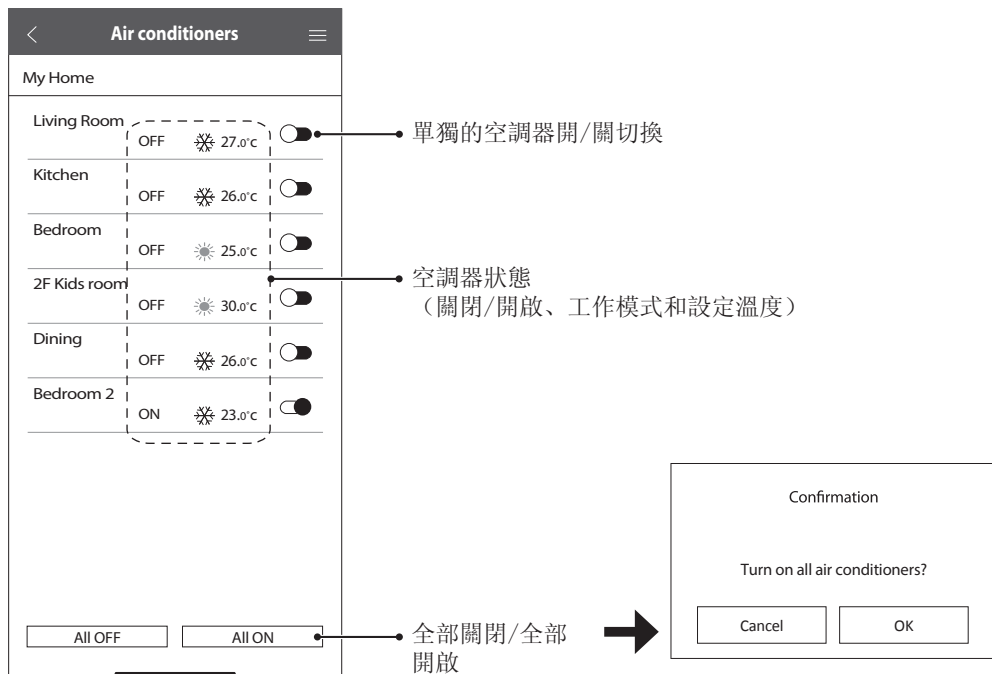

如何使用

統計資料

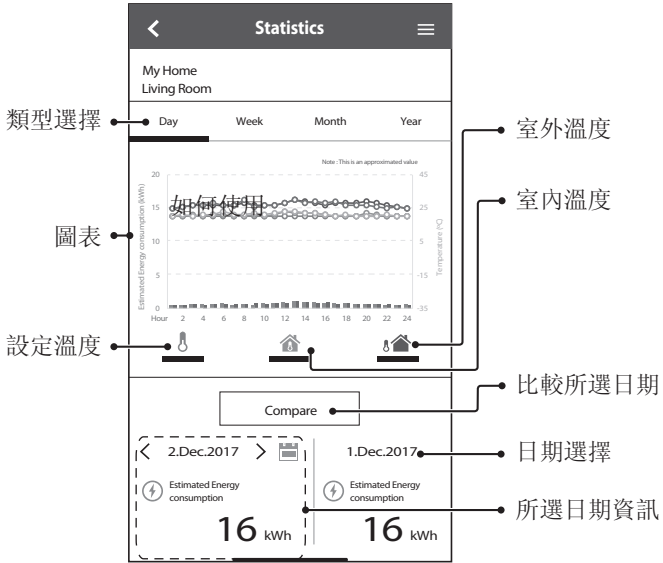

備註

- 某些型號可能不支援估計的能耗。
- 對於空調器系統：所顯示的能耗值適用於整個系統。

每週定時器

① 輕按 “Weekly Timer” 以設定定時器時間表。



② 輕按 。

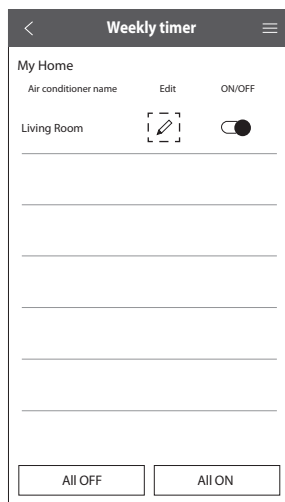

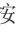
③ 輕按  以新增新程式。一天最多可以設定六個程式。

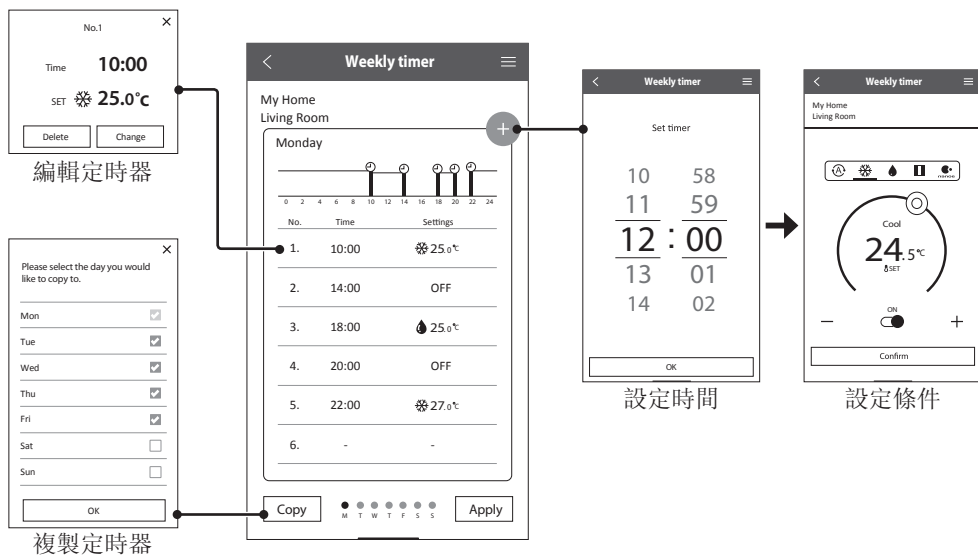

如何使用

主選單

主選單允許使用者編輯設備設定並提供重要資訊。

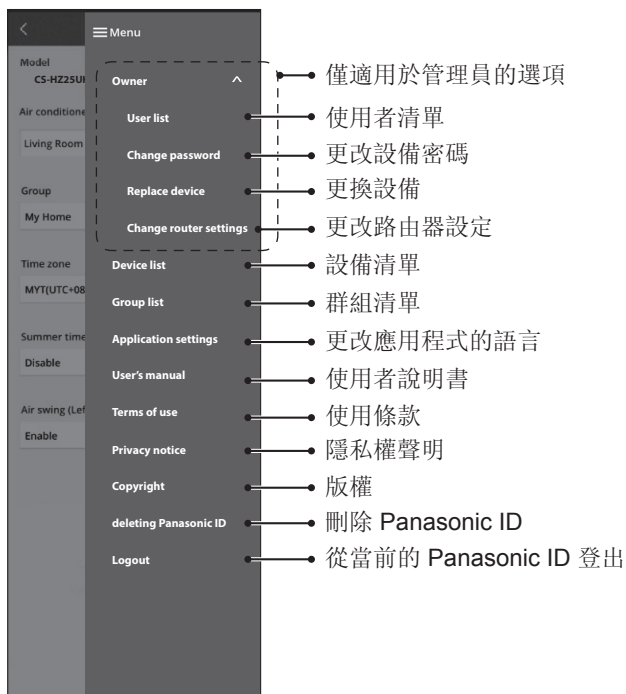

使用者清單

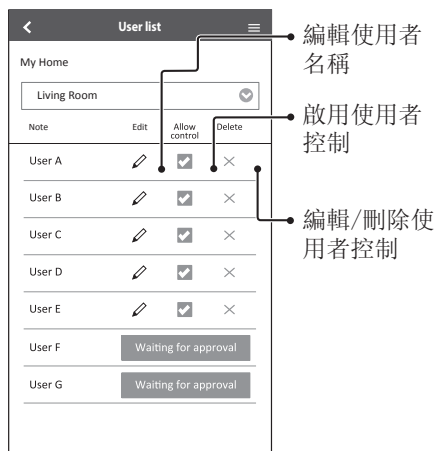

更改設備密碼

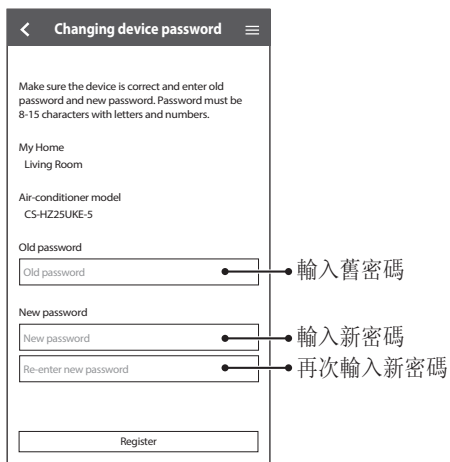

更換設備

- ① 從選單中選擇“Replace device”。

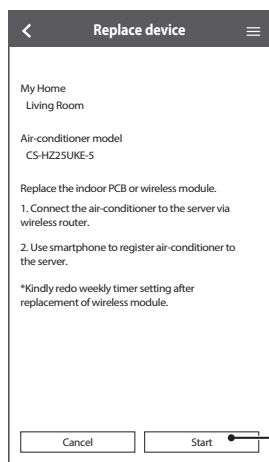

輕按開始

更改路由器設定

- ② 從選單中選擇“Change router settings”。

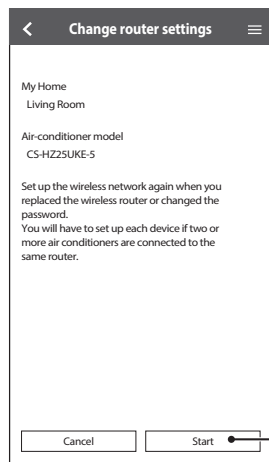

輕按開始

裝置清單

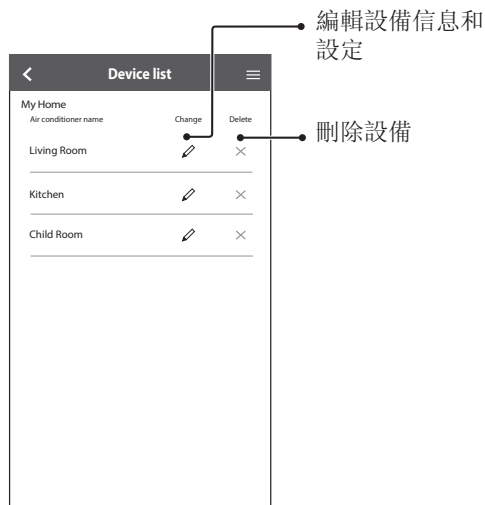

編輯設備信息和設定

刪除設備

群組清單



編輯群組名稱

刪除群組

新增群組





網絡和應用程式常見問題解答

在致電您的本地服務代理商之前，請檢閱此清單。可為您節省一些時間。

初始設定

現象	解決方案
“Panasonic Comfort Cloud” 應用程式無法安裝在智能手機上。	確認智能手機版本是否相容 (Android 5.0 及更高版本，或 iOS 9 及更高版本)。 無法保證應用程式將適用於所有版本。
將其他空調器註冊至 “Panasonic Comfort Cloud” 應用程式。	按照初始空調器設定步驟進行操作。建議您為每個已註冊的空調器命名，以便於區分它們。
註冊控制網絡适配器的其他使用者。	下載 “Panasonic Comfort Cloud” 應用程式並建立新的 Panasonic ID。按照初始設定操作。 註冊空調器後，輸入第一個使用者 (擁有者) 設定的密碼。 擁有者需要批准才能完成註冊。 要批准，擁有者需要選擇  Menu，然後選擇 “Owner”。 之後，選擇 “User List” 以批准其他使用者。

連接

現象	解決方案
無法連接空調器和無線路由器。	確認路由器的區域網絡信號已到達本裝置，未隱藏 SSID，已為本裝置啟用 MAC 位址設定，並且已啟用 2.4 GHz 連接的路由器雙頻段信號。 設定之前，確保您的智能手機已連接到 2.4 GHz 網絡。 一些 MESH 網絡路由器會自動分配給 5 GHz 信號。在這種情況下，向現有網絡新增專用的 2.4 GHz 路由器。
無法連接到雲端伺服器。	不支援需要伺服器登入的商業網絡。 PCPF 和 AFUS 的 IP 位址可能被篩選或已被封鎖。 為物聯網產品設定單獨的無線區域網絡。 對於路由器設定，請使用連接埠: 443; 網址: ldcws.pcpf.panasonic.com
無線信號斷開或中斷。	您的網絡連接可能不穩定。使用以下步驟檢查信號強度： • 停止空調器操作，然後按住無線區域網絡  按鈕 5 秒鐘，直到遙控器上出現 “1”。 • 按住  直到出現 “4”。 • 按  ，操作停止。 • 5 秒後，室內機上的無線區域網絡 LED 將顯示信號強度。 強: 閃爍 3 次，然後間隔 中等: 閃爍 2 次，然後間隔 弱: 閃爍一次，然後間隔 無信號: 關閉 • 網絡連接將在 10 分鐘後自動停止。按無線區域網絡  按鈕立即停止。
對本裝置的可疑或未經授權存取。	• 將空調器重設為製造預設設定。詳情請參閱本章中的 “其他 - 轉讓或報廢空調器”。然後，再次設定網絡連接。

“Panasonic Comfort Cloud” 應用程式



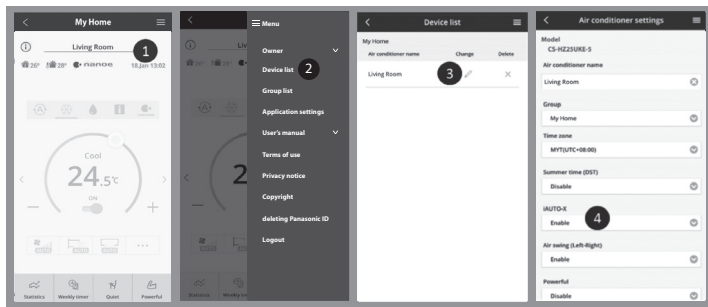



現象	解決方案
無法擷取使用者 ID	由於有隱私資料保護法，“Panasonic Comfort Cloud” 管理員無法擷取您的 Panasonic ID。建立新的 Panasonic ID。
選擇 “Forgot ID/password” 後，無法收到用於密碼重設的電子郵件連結	您的電子郵件地址可能輸入有誤。再次選擇 “Forgot ID/password”。
即使選擇 “Remember me” 亦被登出。	<ul style="list-style-type: none"> • 使用者不同意隱私權聲明。 • 根據隱私資料保護法，如果您連續 15 天未存取 “Panasonic Comfort Cloud” 應用程式，則會讓您自動登出。 • 您的手機中已關閉 “Panasonic Comfort Cloud” 應用程式。在沒有網絡連接的情況下重新開啟 “Panasonic Comfort Cloud” 應用程式。 • “Panasonic Comfort Cloud” 伺服器正在維護或更新。 • 您的 Panasonic ID 用於登入另一部智能手機。您在一部智能手機上只能登入一個 Panasonic ID。 • “Panasonic Comfort Cloud” 儲存資料/快取已清除。再次返回至 “Panasonic Comfort Cloud” 應用程式。
室內溫度圖示未顯示。	室內溫度圖示僅適用於具有最新設計的型號。
不提供某些產品功能，如 HEAT、iAUTO-X、左右掃風和強風。	<p>產品功能將根據每個國家/地區的預設設定顯示。使用者 ID 註冊期間選擇正確的國家。</p> <p>應用程式管理員可以為群組中的每個空調器啟用產品功能，如下所示：</p>



網絡和應用程式常見問題解答

現象	解決方案
<p>每週定時器不起作用。</p>	<p>確認是否在“Panasonic Comfort Cloud”應用程式中開啟每週定時器，如下所示：</p>  <p>確認每週定時器和遙控器定時器之間是否存在任何衝突。應用伺服器端和遠端控制時間可能不同。定時器將根據較早的時間啟用。確認時區是否已正確設定，如下所示：</p> 

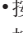
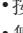
其他

現象	解決方案
<p>更換路由器。</p>	<p>從“Panasonic Comfort Cloud”應用程式中選擇 。選擇“Owner”並選擇“Change router settings”。</p>
<p>更改智能手機的型號。</p>	<p>確認智能手機版本是否相容 (Android 5.0 及更高版本，或 iOS 9 及更高版本)。安裝“Panasonic Comfort Cloud”應用程式並使用您的 Panasonic 登入 ID 和密碼登入。按照初始連接設定步驟進行操作。</p>
<p>更改空調器的控制板。</p>	<p>更換控制板。然後，從“Panasonic Comfort Cloud”應用程式中選擇 。選擇“Owner”，然後選擇“Replace device”。請注意，授權服務經銷商應執行此操作。</p>
<p>空調器更換無線區域網絡模組。</p>	<p>更換網絡無線區域網絡模組。然後，從“Panasonic Comfort Cloud”應用程式中選擇 。選擇“Owner”並選擇“Change router settings”。請注意，授權服務經銷商應執行此操作。</p>
<p>轉讓或報廢空調器。</p>	<p>將空調器重設為製造預設設定。</p> <ul style="list-style-type: none"> • 確認室內機上的無線區域網絡 LED 是否點亮/閃爍，然後按住無線區域網絡  按鈕 5 秒，直到遙控器上出現“1”。 • 按住  直到出現“5”。 • 按住  按鈕 3 秒，操作停止。 • 無線區域網絡 LED 熄滅，並且出廠重設已完成。 <p>要從“Panasonic Comfort Cloud”應用程式取消註冊空調器，選擇 ，然後選擇“Device list”以刪除裝置。</p>

故障檢修

以下現象並非表示故障。

現象	原因
當裝置關閉時，無線區域網絡 LED 點亮。	• 裝置與路由器的無線區域網絡連接已啟用。
無線區域網絡 LED 持續閃爍。	• 裝置未與路由器建立無線區域網絡連接。重新檢查您的連接。 • 如果您不想使用該應用程式，請按無線區域網絡  按鈕將其關閉。

信息

韌體更新功能

本產品具有通過網際網絡連接到 Panasonic 韌體更新伺服器的功能，可自動將設備韌體更新到最新版本。

為了更新韌體，設備在上電後每天會檢查一次其韌體是否為最新版本。如果需要更新，將應用更新並自動重啟設備。設備重啟期間(需要大約 1-5 分鐘)無法進行操作。

軟件許可資訊

該產品包含以下軟件：

- (1) 由 Panasonic Corporation 或為 Panasonic Corporation 獨立開發的軟件，
- (2) 第三者擁有並授權給 Panasonic Corporation 的軟件，
- (3) BSD 許可和/或等效許可下的開放來源軟件。

自 (3) 起分類的軟件已發行，希望它會有用，但不作任何保證，甚至沒有對適銷性或特定目的適用性的暗示保證。

以下許可條款應適用於開放來源組件。

1. 要求者許可

版權所有 (C) 2003-2016, Jouni Malinen <j@w1.fi> 和貢獻者。

保留所有權利。

根據 BSD 許可的條款分發、使用和修改此軟件：

只要符合以下條件，無論是否經過修改，都允許以原始碼和二進位格式進行重新分發和使用：

1. 重新分發原始碼必須保留上述版權聲明，條件清單和以下免責聲明。
2. 以二進位格式重新分發，必須在分發隨附的文件和/或其他資料中複製以上版權聲明、條件清單以及以下免責聲明。
3. 未經明確的事先書面許可，以上列出的版權擁有者的名稱或其貢獻者的名稱均不得用於認可或促銷從該軟件衍生的產品。

本軟件由版權擁有者和貢獻者按原樣提供，並且不提供任何明示或暗示的保證，包括但不限於對適銷性和特定目的適用性的暗示保證。任何情況下，版權擁有者或貢獻者均不對任何直接、間接、偶發、特殊、懲戒性或後果性損害負責，包括但不限於採購替代商品或服務；使用、資料或利潤損失；或業務中斷，無論該等損害是如何導致的，基於任何責任理論，不論是合約、嚴格責任還是侵權(包括疏忽或其他方式)，以任何方式使用本軟件而產生，即使已告知該等損害的可能性。

Built-in Network Adaptor that allows you to control your air conditioning unit operation from anywhere.

Thank you for purchasing this Panasonic product.

Table of Contents

Safety Precautions	29-30
System Overview	31-32
Get Started	33
App Settings	34-43
How to Use	44-50
Network Adaptor & App FAQs	51-53
Troubleshooting	54
Information	55
Copyright	56-60

Safety Precautions

Before attempting to control / operate this air-conditioner product via wireless communication from a remote location, make sure to check the installation of the appliance and its surrounding area, and, be wary of any person(s) within the vicinity.

To prevent personal injury, injury to others or property damage, please comply with the following:

Incorrect operation due to failure to follow instructions below may cause harm or damage, the seriousness of which is classified as below:

 WARNING	This sign warns of death or serious injury.
---	---

 CAUTION	This sign warns of injury or damage to property.
---	--

The instructions to be followed are classified by the following symbols:



This symbol denotes an action that is **PROHIBITED**.



This symbol denotes an action that is **COMPULSORY**.



WARNING

Network Adaptor (activated)



Do not use the indoor unit near to any medical equipment or automatic control equipment (automatic door, wire alarms, etc.).
(Radio wave from air conditioner unit may interfere with the equipment and may cause incident due to malfunction)

Safety Precautions



Keep at least 15 cm away from the indoor unit if you have a cardiac pacemaker.
(Radio wave from air conditioner unit may interfere with the operation of pacemaker)



CAUTION

Network Adaptor (activated)



Check the following requirements in advanced (At home):

- Insert the power supply thoroughly. Ensure no dust builds up on the power supply.
(This can cause fire due to ignition in the power supply's of poor contact)
- Check the status of timer activation set by other persons.
(Unexpected run-stop operation may cause harm to human body, pets, and plants)
- There should be no abnormality in the air conditioner such as change of airflow. Ensure no object(s) which may be displaced easily due to the airflow blowing directly at it. The fallen or moved object(s) might lead to danger such as fire, injury etc.
- At all times, use the in-house remote control when there is a possibility of person(s) (such as infant, children, disabled person(s), elderly or sickly person(s)) who are incapable of controlling the temperature themselves and rely on the pre-set configuration of the air-conditioner.
The rise and drop in the temperature due to remote operation might cause the occupant(s) to experience discomfort and/or disrupt their daily routine.
Plant(s) and animal(s) are likely to be affected by sudden temperature adjustments.



Check the following requirements before operating the air conditioner from a remote location:

- Do inform the person(s) in the vicinity of the area being air-conditioned that you will remotely control the air conditioner operation and settings. This is to avoid any possibility of serious effects on person(s) either due to being taken by surprise or due to sudden changes in temperature (from comfort to cold or vice versa).

(This may cause harm to human body due to sudden changes of outside temperature and room temperature.

Temperature adjustment can be operated by remote control)

- If the main display of the Panasonic Comfort Cloud app does not reflect the status of the operation, please use the in-house remote control to operate the air-conditioner.

- As the app uses network communication, there may be times when remote operation is not possible due to communication and/or network failures (such as Panasonic Cloud server downtime, telecom providers' server downtime, WIFI connectivity etc.). In the event of such failure(s), please use the in-house remote control to operate the air-conditioner.

System Overview

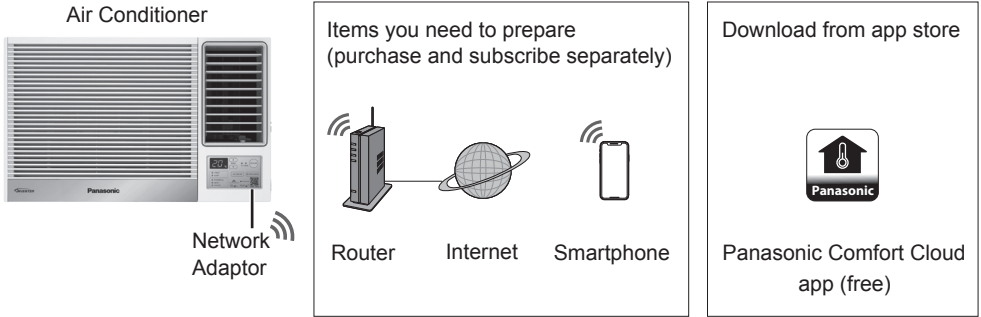

- This feature requires the app to work with a smartphone. Please check each store for the supported OS version.
- The Network Adaptor is designed specifically as a terminal for “Panasonic Comfort Cloud” app.
- The Wireless LAN network coverage must reach the Window air conditioner unit installation location.

Specification - Built-in Network - (2QR code) *

Model	PIOT-V2(WA)
Input Voltage	DC 5V (From Air Conditioner Indoor Unit)
Current Consumption	Tx/Rx max. 190/70 mA
Wireless standard	IEEE 802.11 b/g/n; BT5.0 Low Energy (BLE)
Frequency range	2.4 GHz band
Encryption	WPA™ / WPA2™ / WPA3™

Maximum radio-frequency power transmitted in the frequency bands PIOT-V2(WA)

Type of wireless	Frequency band	Max. EIRP (dBm)
WLAN	2412 - 2472 MHz	20 dBm
BLE	2402 - 2480 MHz	20 dBm

- * Either one of the specific network to be incorporated within the corresponding air conditioner model. Be sure to make clear with sales representative accordingly.

System Overview

Precaution

- Do NOT disassemble or alter this Network in any way.
- Do NOT remove this Network from the air conditioner unit during operation.
- Data transmitted and received over radio waves may be intercepted and monitored.

Usage precaution

- Before using this product, be sure to read all the precautions in this manual for proper use. The Company is not liable for any defects and damages, unless legal liability is recognized, in regards to failures, incurred by use of this product that occur through incorrect use or during use by yourself or a third party.

Security measure

- Wireless LAN uses radio waves to exchange information. Therefore, there is a risk of unauthorized access.
- Initialize the app settings on the product prior to disposal or transferring to a third party.

Before setting the network connection

- Confirm the wireless router is connected to the network correctly.
- Confirm the Wireless LAN of the smartphone is activated.
- Confirm your smartphone and this product are connected to the same wireless router.

App Installation

For Android user

- Open  .
- Search for “Panasonic Comfort Cloud” app.
- Download and install.

For iOS user

- Open  .
- Search for “Panasonic Comfort Cloud” app.
- Download and install.

Note

- The app user interface image may change for version upgrade without notification.
- There is no charge to using this application. However, other charges may be incurred for connection and operation.

Get Started

Check the app's connectivity status before and during operation. If the status is not reflected, use the remote control to operate your air conditioner.

Starting "Panasonic Comfort Cloud"

Create New Panasonic ID

Use "Panasonic Comfort Cloud" app as an option to control the air conditioner.

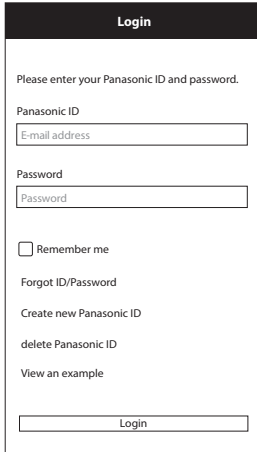

The screenshot shows the login interface of the Panasonic Comfort Cloud app. At the top, there is a black header with the word "Login" in white. Below the header, the text "Please enter your Panasonic ID and password." is displayed. There are two input fields: the first is labeled "Panasonic ID" and contains the placeholder text "E-mail address"; the second is labeled "Password" and contains the placeholder text "Password". Below these fields is a checkbox labeled "Remember me". Underneath the checkbox, there are three links: "Forgot ID/Password", "Create new Panasonic ID", and "delete Panasonic ID". At the bottom of the form, there is a "View an example" link and a "Login" button.

- For new user, select "Create new Panasonic ID" to register.
- For registered user, log in using your Panasonic ID and password.

App Settings

Add new air conditioner device

Air conditioner need to be registered before using “Panasonic Comfort Cloud” app.

Device registration screen

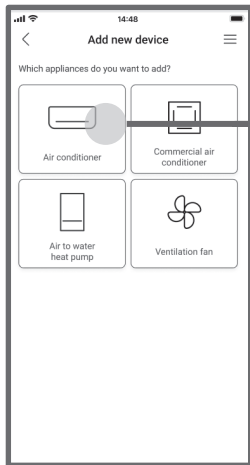

New registration

Air conditioner registration

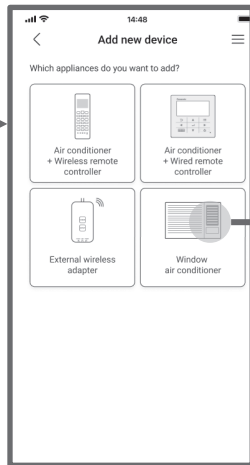

Wac(V2) Check QR code

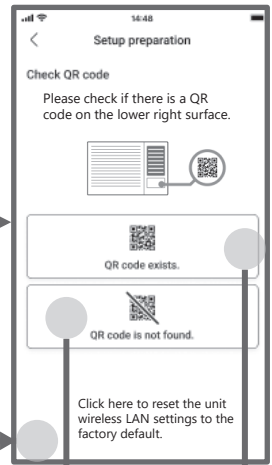

Click here to reset the unit wireless LAN settings to the factory default.

WAC (V2) Device initialization



2

Go to QR code Flow

4

Go to Fixed SSID/PW Flow

Setting connection network (Wireless Remote Control)

Replace device \ Change router settings

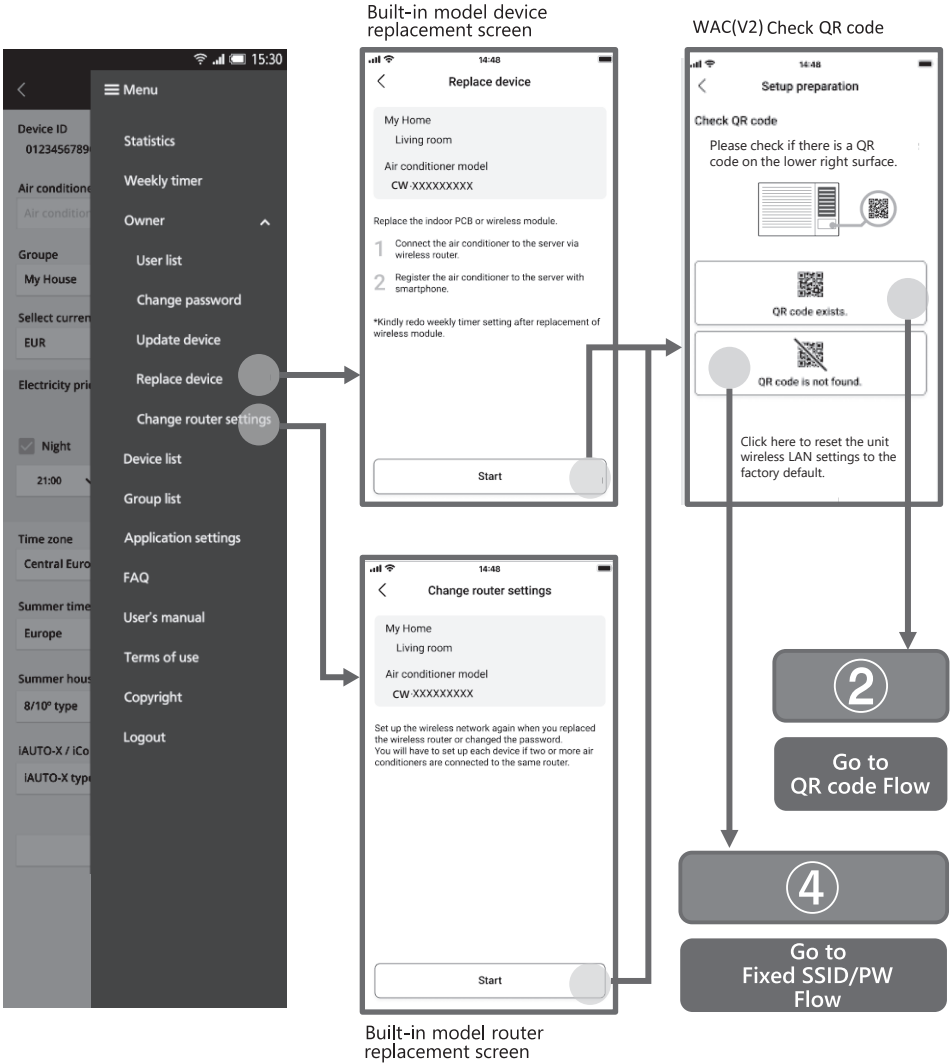

App Settings

Setting connection network (Wireless Remote Control)

Setup using QR scan

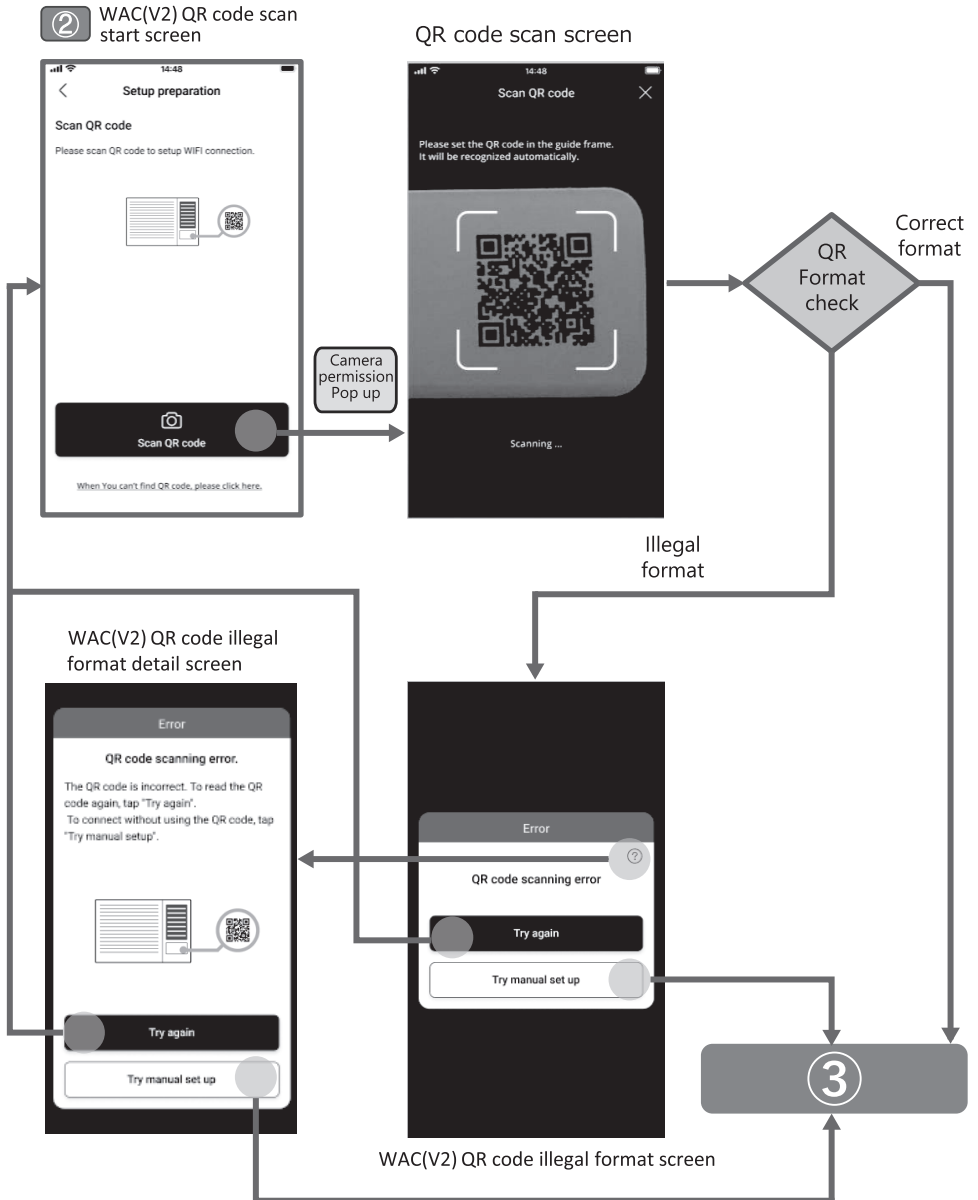

Setting connection network (Wireless Remote Control)

Setup using QR scan

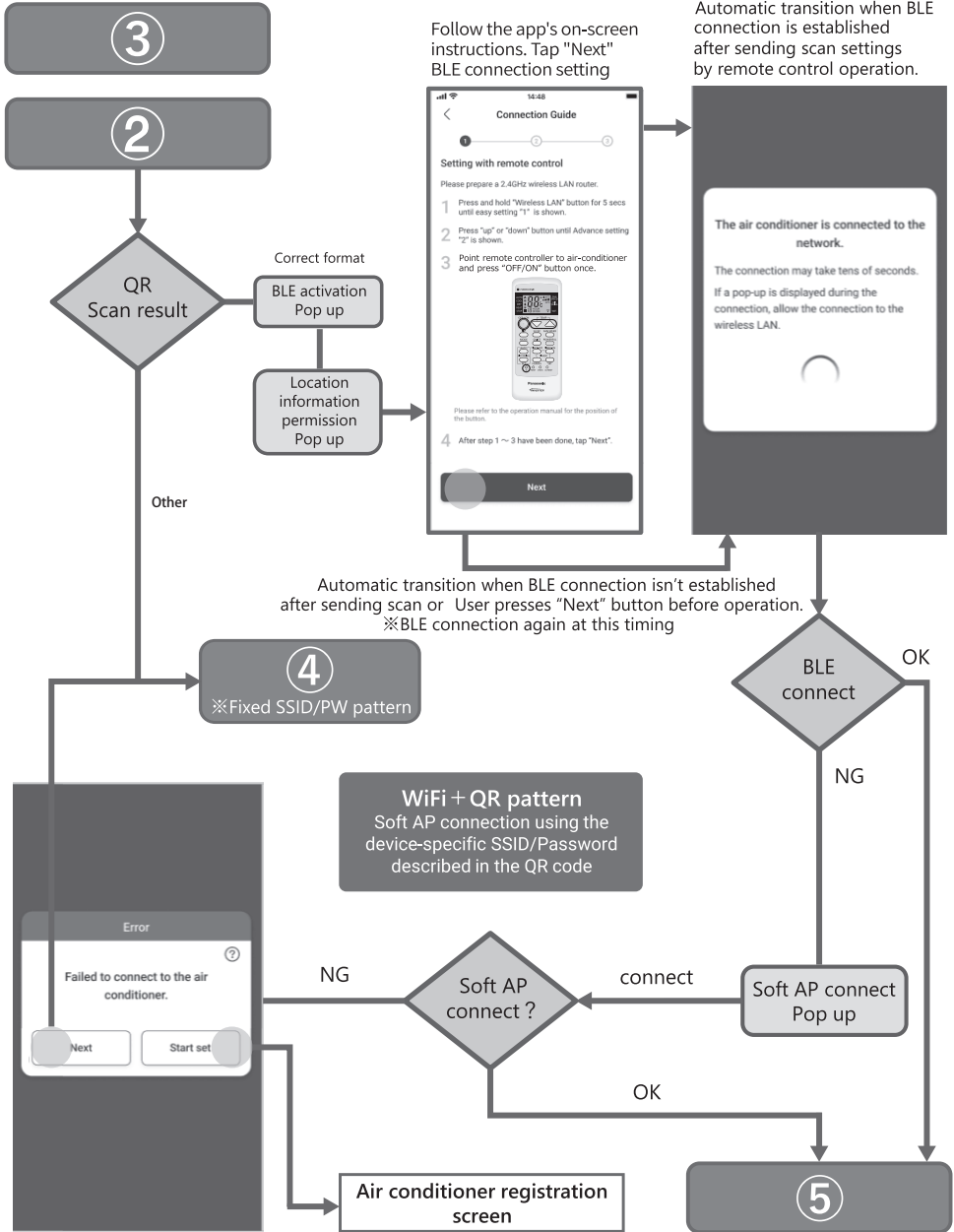

App Settings

Setting connection network (Wireless Remote Control)

Setup using AP mode

4

3

Fixed SSID/PW pattern
Call Fixed SSID(Panasonic-CS-V2-eM00)/PW,
soft AP connection

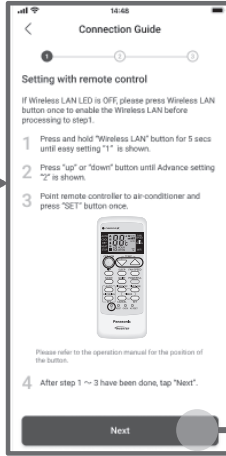

WAC(V2) Fixed SSID connection explanation

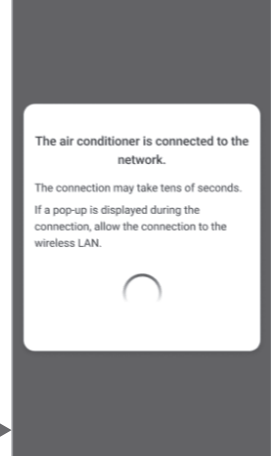

Location information permission Pop up

Soft AP connect Pop up

Device password registered

No

YES

Soft AP connection completed

5

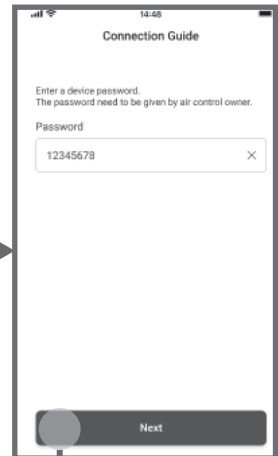

Setting connection network (Wireless Remote Control)

Router connect confirmation

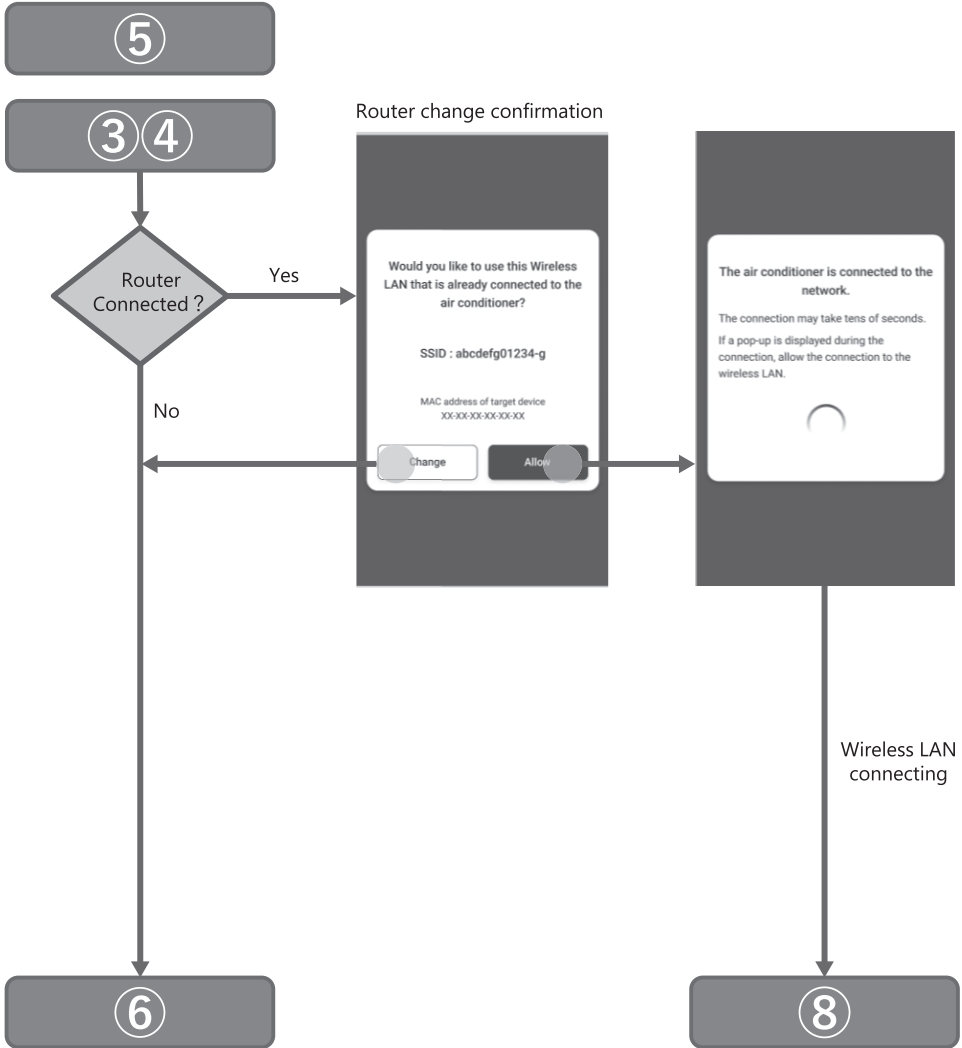

App Settings

Setting connection network (Wireless Remote Control)

Router connect choosing

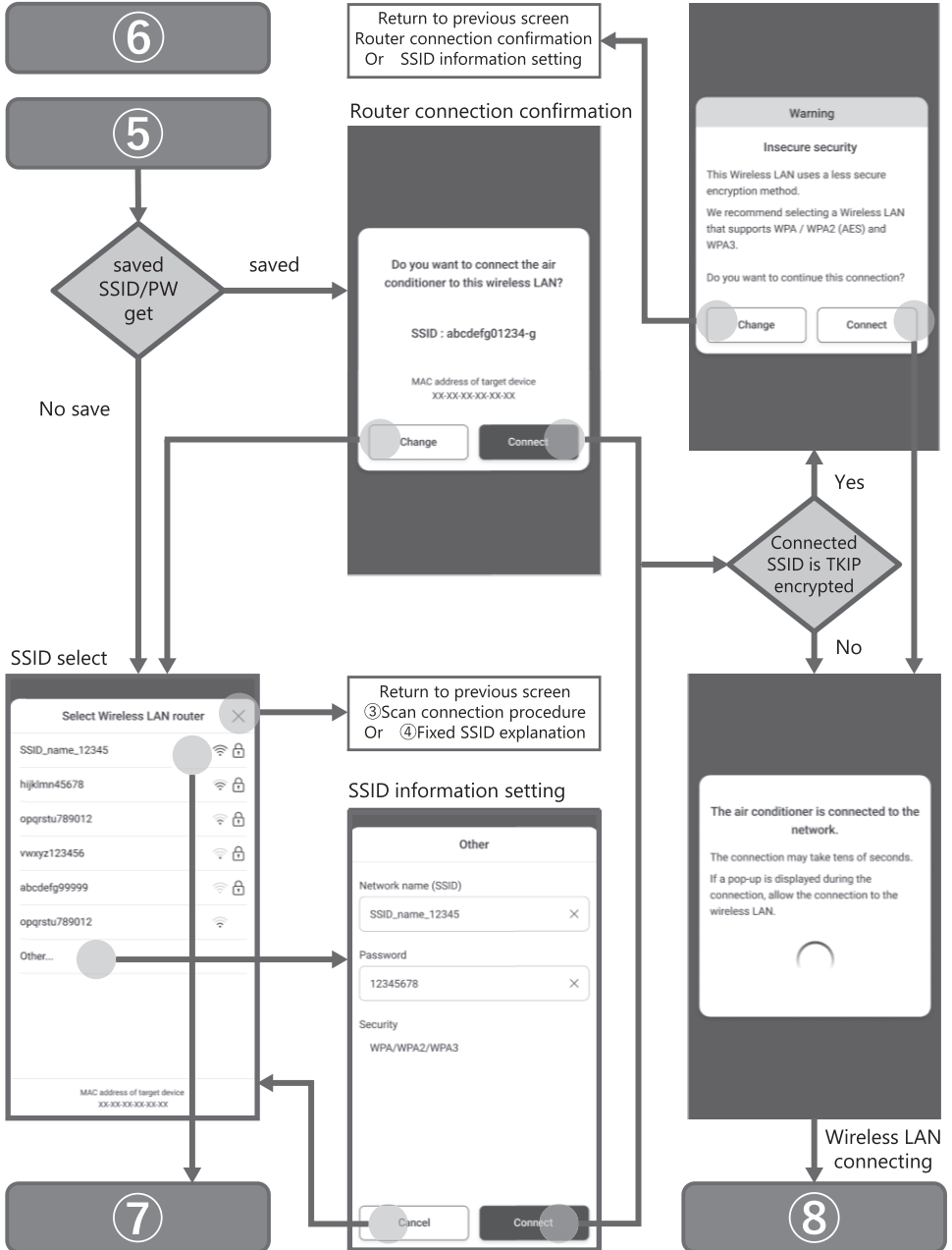

Setting connection network (Wireless Remote Control)

Router connect confirmation

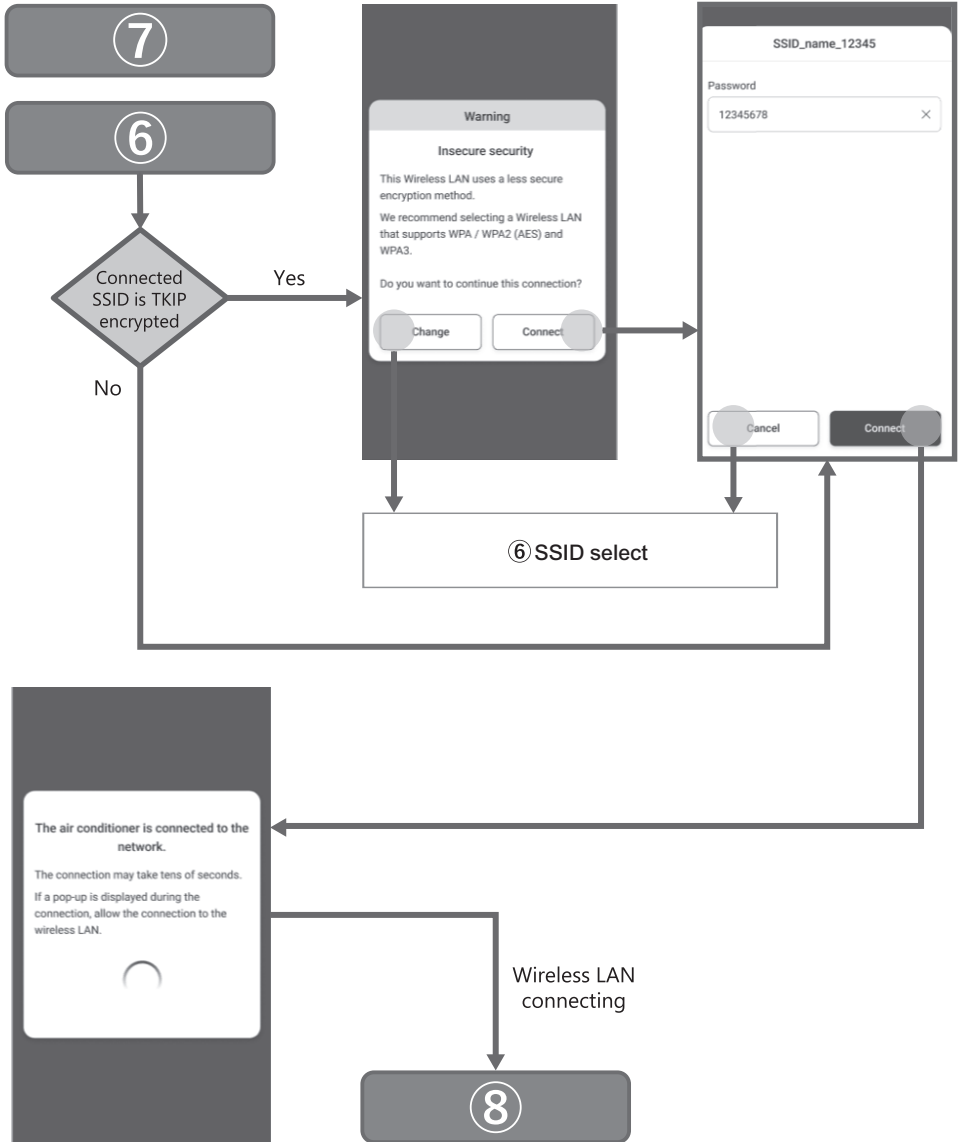

App Settings

Setting connection network (Wireless Remote Control)

Device registration confirmation

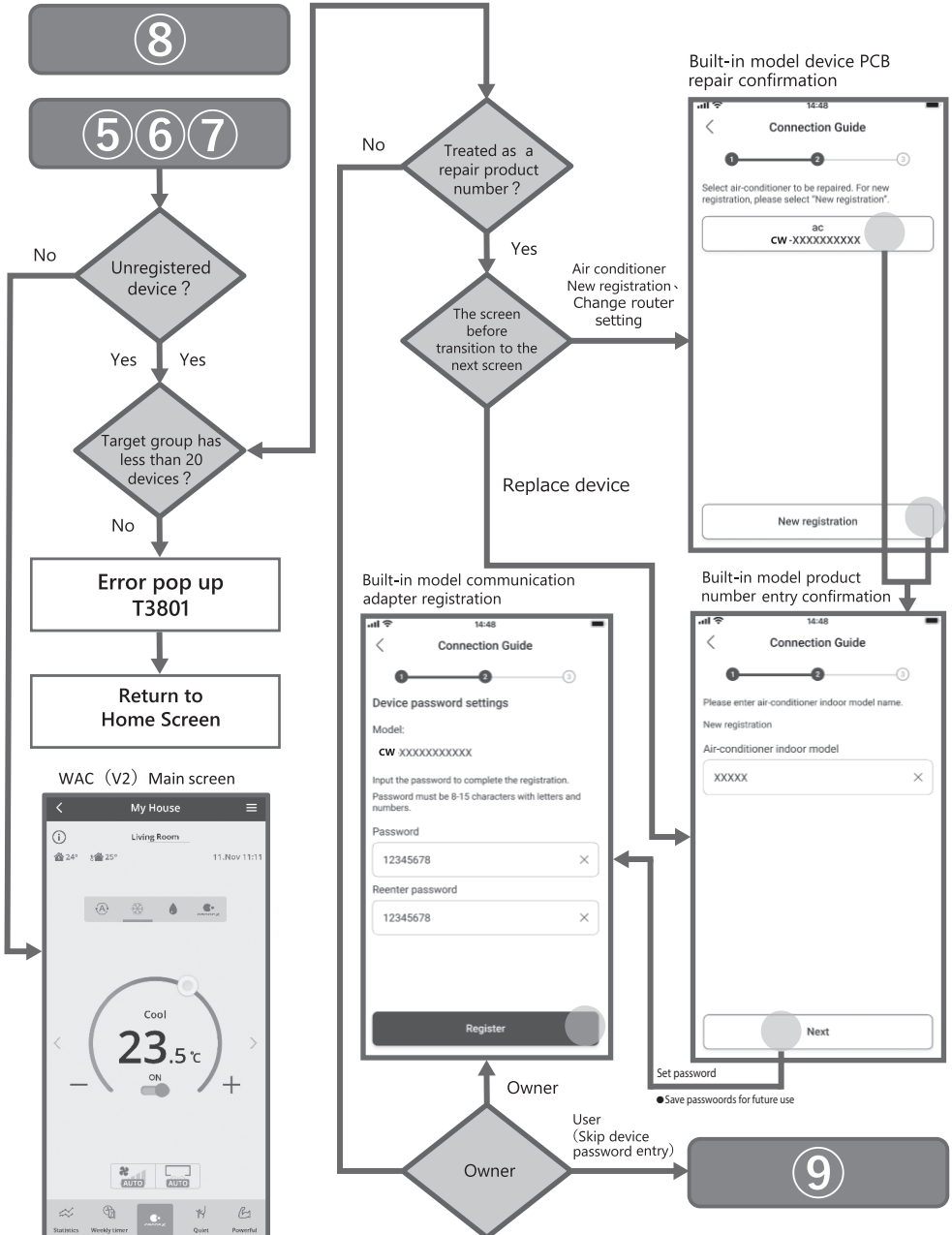

Setting connection network (Wireless Remote Control)

Owner (user) device login and (sharing)

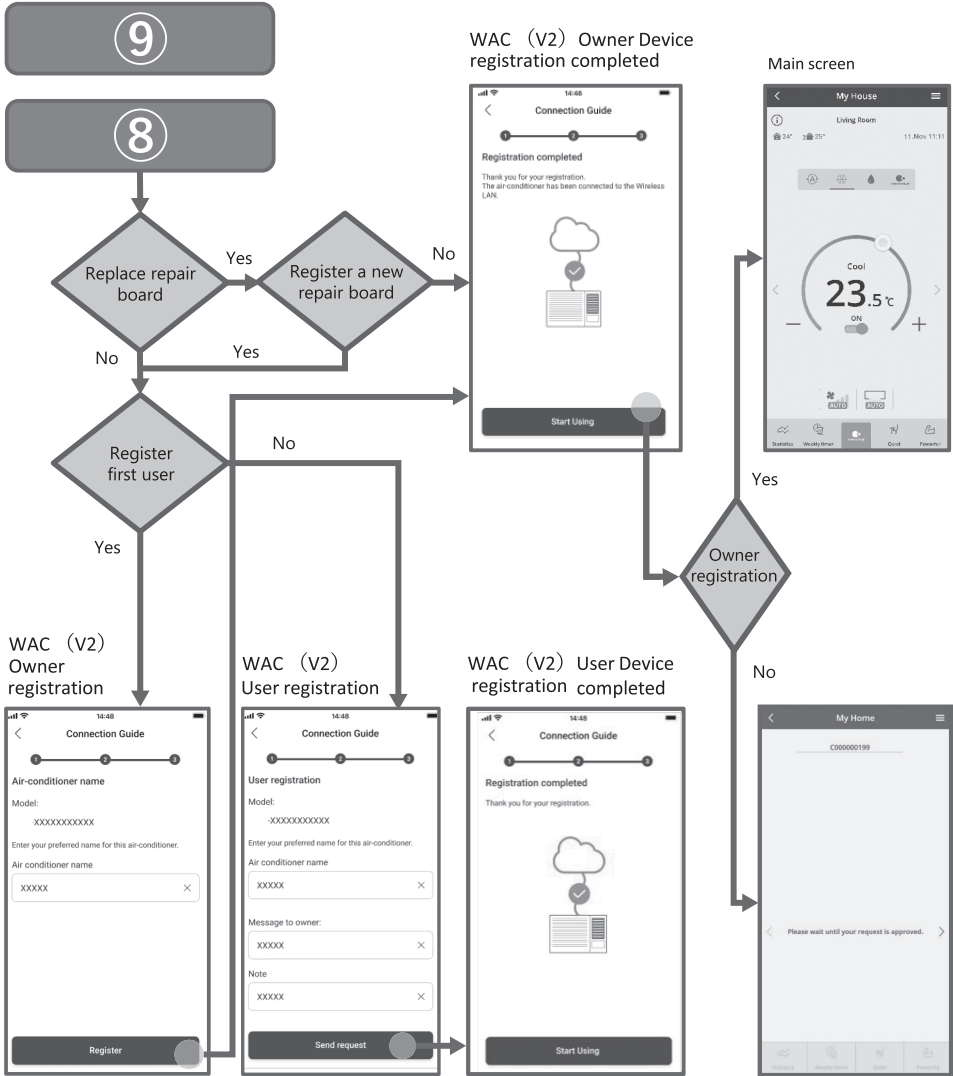

How to Use

Registration completed

- ① After registration and connection is established between the app and your air conditioner, set the preferred name to identify your air conditioner easily.
 - After registering your preferred name for your air conditioner, you can use the “Panasonic Comfort Cloud” app functions.
- ② Beside operation control, this application can monitor the estimated energy consumption and do comparison for different time frame by referring to the statistic's graph.

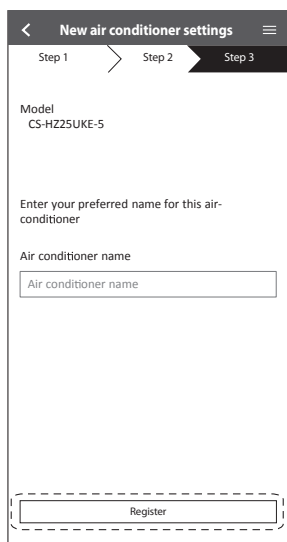

Note

- Check the app's connectivity status before and during operation. If the status is not reflected, use the remote control to operate your air conditioner.

Launch the App

- ① Log in to the “Panasonic Comfort Cloud” app.
- ② Select your air conditioner to control.

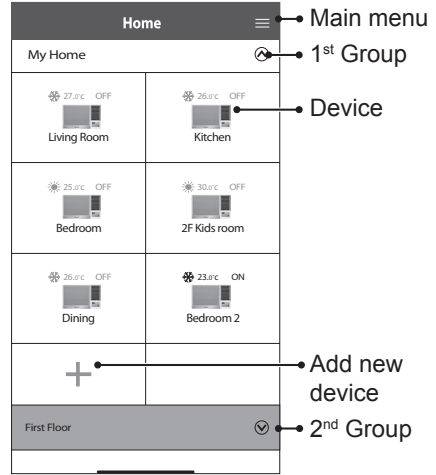
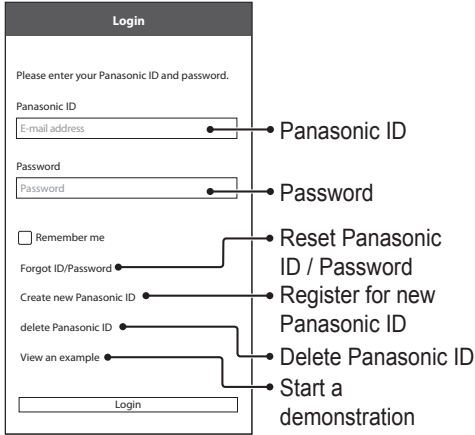

Main Device Screen - Operation Setting

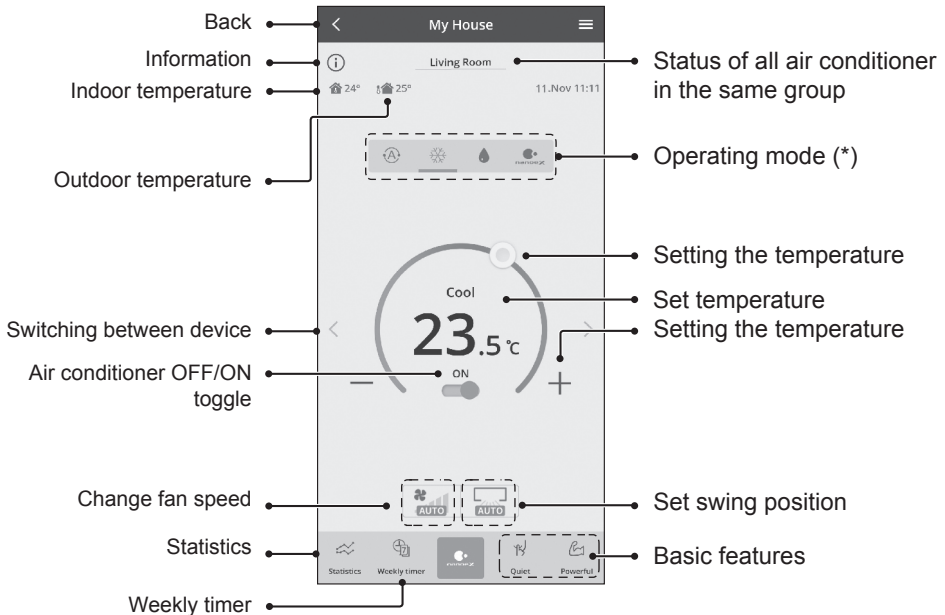

(*) Subject to model compatibility

How to Use

Information

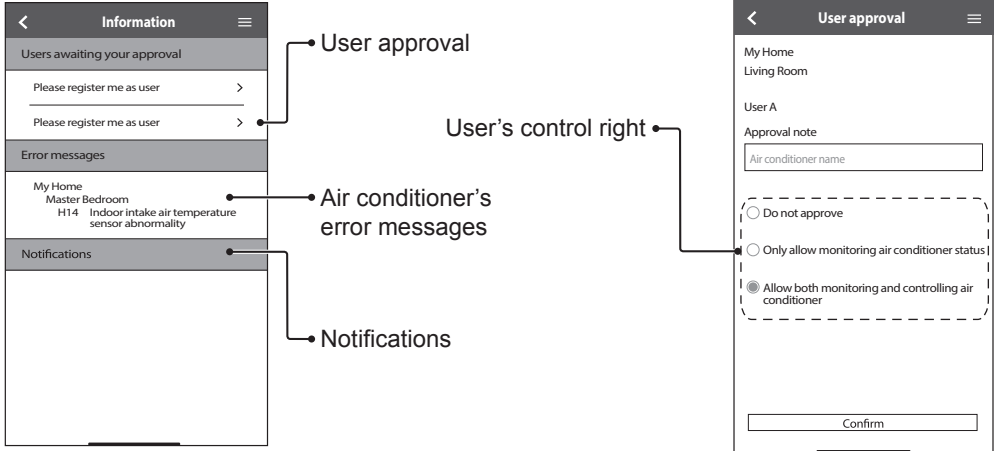

Air Conditioner Status

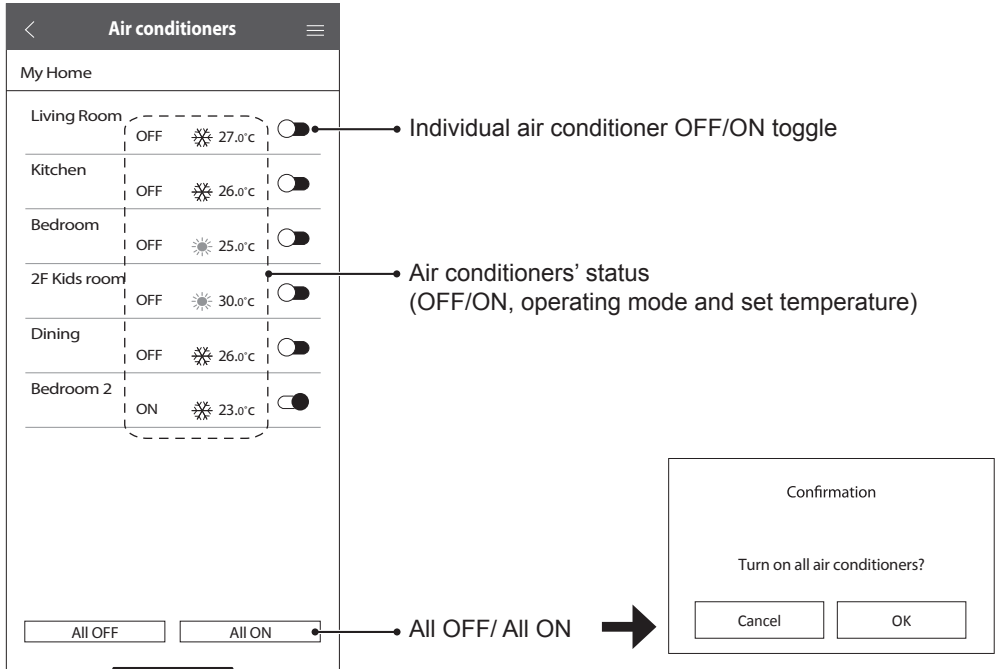

Statistics

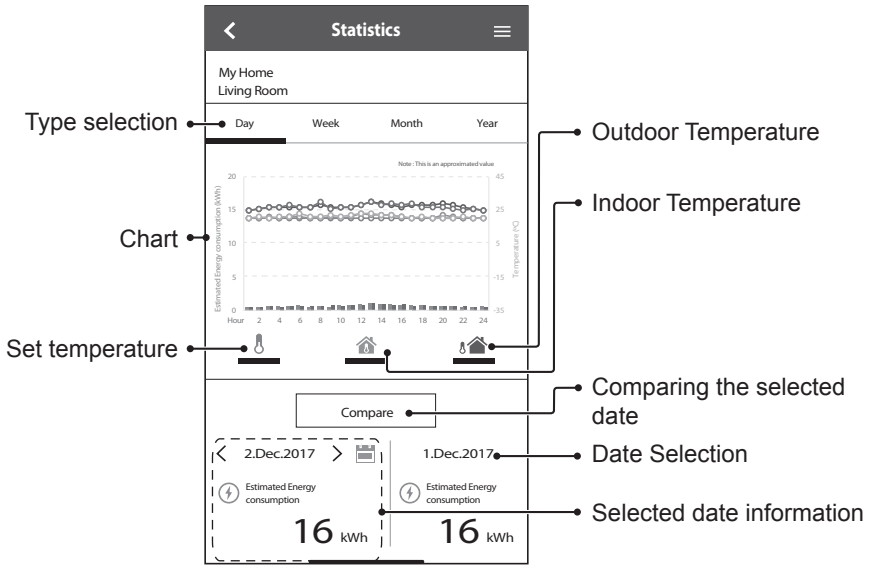

Note

- Estimated energy consumption may not be supported by certain models.
- For Multi-split AC system: energy consumption value displayed is for whole system.

How to Use

Weekly Timer

- 1 Tap "Weekly Timer" to set the timer schedule.
- 2 Tap .

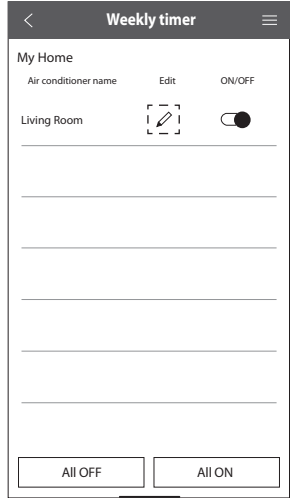

- 3 Tap  to add a new program. You can set a maximum of six programs for one day.

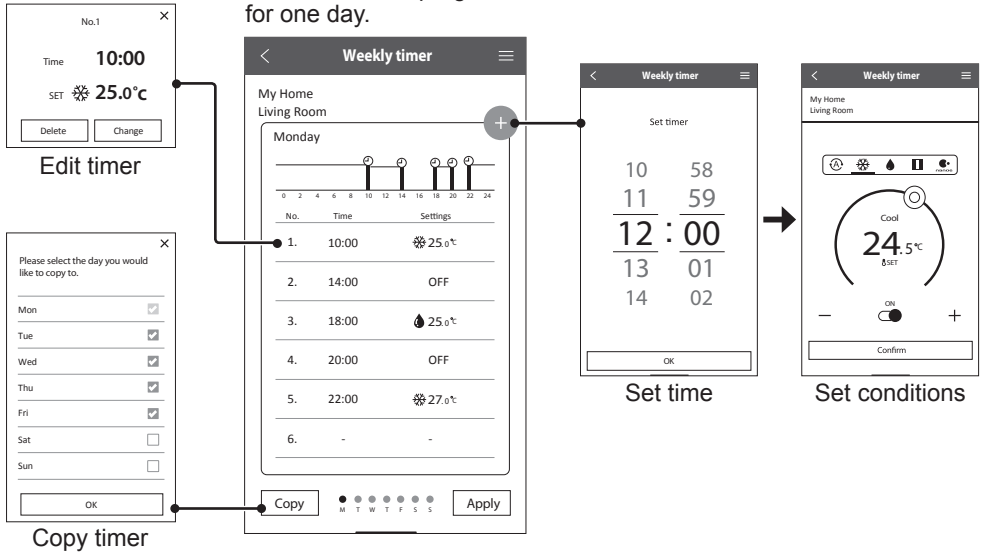

Main Menu

The main menu allows user to edit the device settings and provides important information.

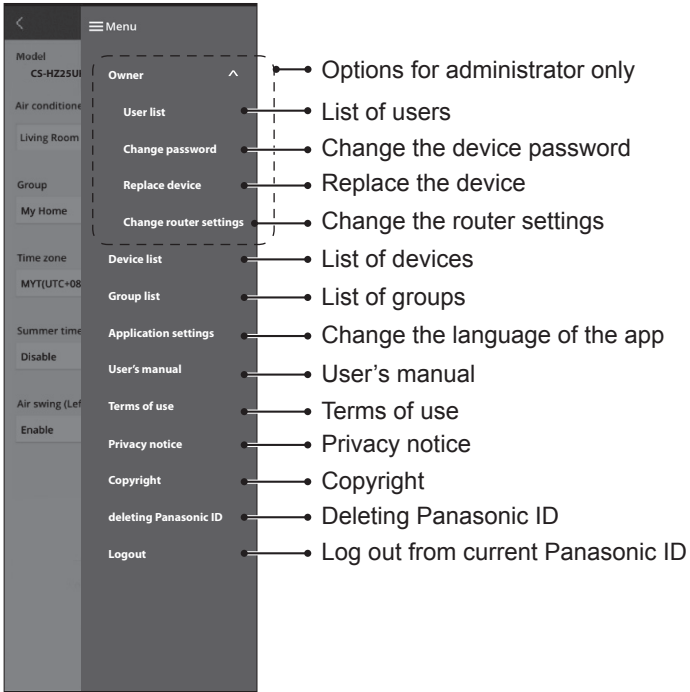

User List

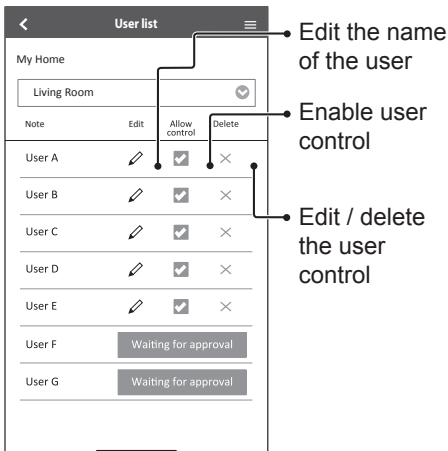

Change the Device Password

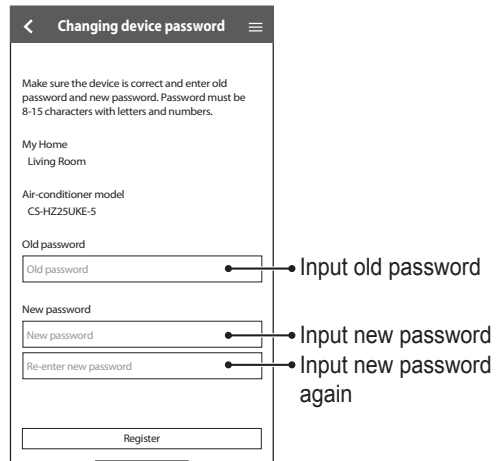

How to Use

Replace the Device

- ① Select “Replace device” from the menu.

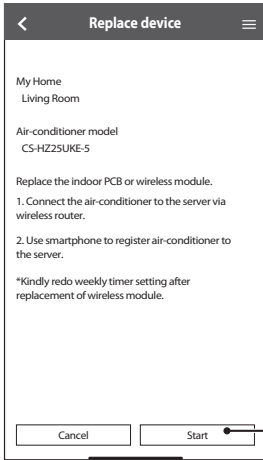

Tap Start

Change the Router Settings

- ② Select “Change router settings” from the menu.

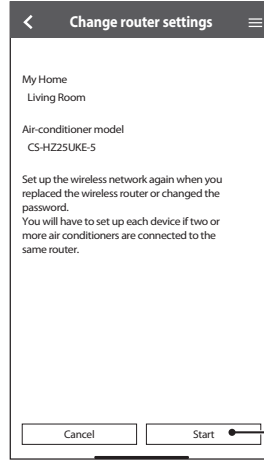

Tap Start

Device List

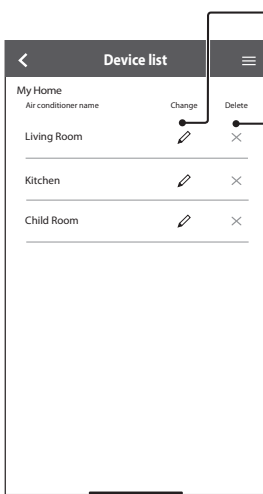

Edit the device information and settings

Delete the device

Group List

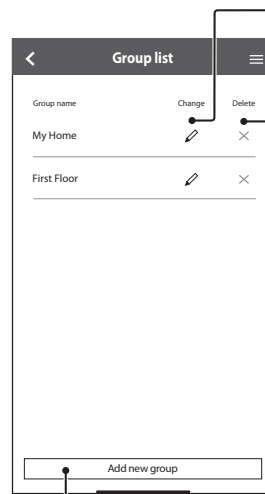

Edit the group name

Delete the group

Add new group





Network & App FAQs

Before calling your local service agent, please review this list. It may save you some time.

Initial setting

Symptom	Solution
"Panasonic Comfort Cloud" app cannot be installed in smartphone.	Check if the smartphone version is compatible (Android 5.0 and above, or iOS 9 and above). There is no guarantee that the app will work well with all versions.
Register additional air conditioner to "Panasonic Comfort Cloud" app.	Follow the steps for the initial air conditioner setup. We recommend that you name each registered air conditioner so that it is easy to differentiate them.
Register additional user to control the Network Adaptor.	Download the "Panasonic Comfort Cloud" app and create a new Panasonic ID. Follow the initial setting. When the air conditioner is registered, input the password set by the first user (owner). The owner needs to approve to complete the registration. For approval, the owner needs to select  , then select "Owner". After that, select "User List" to approve the additional user.

Connection

Symptom	Solution
Air conditioner and wireless router cannot be connected.	Check that the router's LAN signal reaches the unit, the SSID is not hidden, the MAC address setup is enabled for the unit, and the router's dual band signal is enabled for 2.4 GHz connection. Before setup, ensure that your smartphone is connected to a 2.4 GHz network. Some MESH network router is automatically assigned to 5 GHz signal. In such case, add a dedicated 2.4 GHz router to the existing network.
Unable to connect to Cloud server.	Business network that requires a server login are not supported. The IP address of PCPF and AFUS may be filtered or could have been blocked. Set up a separate Wireless LAN network for IoT products. For router setting, use port: 443; URL: ldcws.pcpf.panasonic.com
Wireless signal is disconnected or interrupted.	Your network connection may not be stable. Check the signal strength using these steps: <ul style="list-style-type: none"> • Stop the air conditioner operation, then press the Wireless LAN  button for 5 seconds until "1" appears on the remote control. • Press   until "4" appears. • Press  and the operation stops. • After 5 seconds, the Wireless LAN LED on the indoor unit will show the signal strength. <ul style="list-style-type: none"> Strong: Blink 3 times, followed by an interval Moderate: Blink 2 times, followed by an interval Weak: Blink once, followed by an interval No signal: OFF • The network connection will automatically stop after 10 minutes. Press the Wireless LAN  button to stop immediately.
Suspicious or unauthorized access to the unit.	• Reset the air conditioner to manufacturing default condition. For details, refer "Others - To transfer or dispose the air conditioner." in this chapter. Then, set up the network connection again.

Network & App FAQs





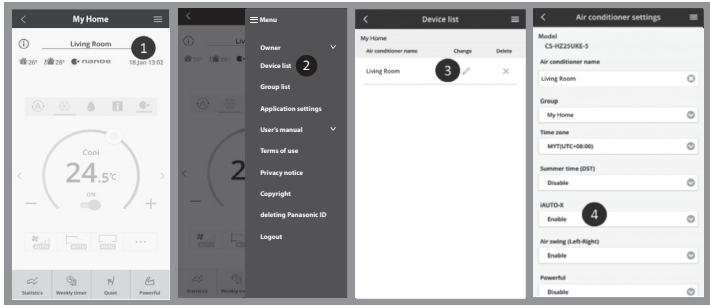

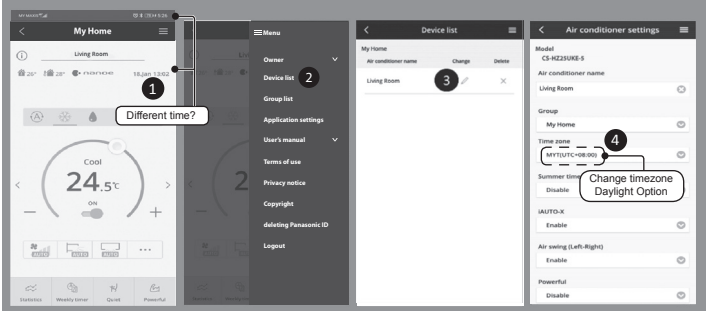
“Panasonic Comfort Cloud” app

Symptom	Solution
Unable to retrieve user ID	Due to the privacy data protection act, the “Panasonic Comfort Cloud” administrator cannot retrieve your Panasonic ID. Create a new Panasonic ID.
Unable to receive the email link for password rest after selecting “Forgot ID/password”	Your email address may have been input incorrectly. Select “Forgot ID/ Password” again.
Logged off even though “Remember me” is selected.	<ul style="list-style-type: none"> • User disagreed with the privacy notice. • Due to the privacy data protection act, you will be logged off automatically if you do not access the “Panasonic Comfort Cloud” app for 15 day continuously. • The “Panasonic Comfort Cloud” app was closed in your mobile phone. Reopen the “Panasonic Comfort Cloud” app without network connection. • The “Panasonic Comfort Cloud” server is being maintained or updated. • Your Panasonic ID was used to log in on another smartphone. You can only log in one Panasonic ID on one smartphone. • The “Panasonic Comfort Cloud” storage data / cache was cleared. Log in to “Panasonic Comfort Cloud” app again.
The indoor temperature icon is not displayed.	The indoor temperature icon is only applicable for models with the latest design.
Some product features such as HEAT, iAUTO-X, Air swing (Left-Right) and Powerful are unavailable.	<p>The product features will appear according to each country’s default setting. Select the correct country during User ID registration.</p> <p>The app administrator can enable the product features for each air conditioner in the group as follow:</p>



Symptom	Solution
<p>The Weekly Timer does not function.</p>	<p>Check if you turned on the Weekly Timer at the “Panasonic Comfort Cloud” app as follow:</p>  <p>Check if there is any conflict between the Weekly Timer and the remote control Timer. The app server and the remote control time may be different. The timer will activate based on the earlier time. Check if the time zone has been set correctly as follow:</p> 

Others

Symptom	Solution
<p>Replacement of router.</p>	<p>Select  Menu from the “Panasonic Comfort Cloud” app. Select “Owner”, then select “Change router settings”.</p>
<p>Change of smartphone’s model.</p>	<p>Check if the smartphone version is compatible (Android 5.0 and above, or iOS 9 and above). Install the “Panasonic Comfort Cloud” app and log in using your Panasonic login ID and password. Follow the steps for the initial connection setup.</p>
<p>Change of control board of the air conditioner unit.</p>	<p>Change the control board. Then, select  Menu from the “Panasonic Comfort Cloud” app. Select “Owner”, then select “Replace device”. Note that the authorised service dealer shall perform this.</p>
<p>Change of Network Adaptor/Wireless LAN module of air conditioner unit.</p>	<p>Change the Network Adaptor/Wireless LAN module. Then, select  Menu from the “Panasonic Comfort Cloud” app. Select “Owner”, then select “Change router settings”. Note that the authorised service dealer shall perform this.</p>
<p>To transfer or dispose the air conditioner.</p>	<p>Reset the air conditioner to manufacturing default condition.</p> <ul style="list-style-type: none"> • Check that the Wireless LAN LED on the indoor unit is ON/blinking, then press the Wireless LAN  button for 5 seconds until “1” appears on the remote control. • Press  until “5” appears. • Press  for 3 seconds and the operation stops. • The Wireless LAN LED is OFF and the factory reset is completed. <p>To unregister the air conditioner from the “Panasonic Comfort Cloud” app, select  Menu, then select “Device list” to delete the unit.</p>

Troubleshooting

The following symptoms do not indicate malfunction.

Symptom	Cause
Wireless LAN LED is ON when the unit is OFF.	• The unit's wireless LAN connection with the router has been activated.
Wireless LAN LED blinks continuously.	• The unit's wireless LAN connection with the router is not established. Recheck your connection. • If you do not want to use the app, press Wireless LAN  button to turn it off.

Firmware Update Function

This product has functionality for connecting to the Panasonic firmware update server over the Internet to automatically update the device firmware to the latest version.

To update the firmware, the device will do check, once per day, whether its firmware is the latest version after power up. And if an update is required, the update is applied and the device restarts automatically. Operations are not possible while the device is being restarted (which takes about 1-5 minutes).

Software License Information

This product incorporates the following software:

- (1) The software developed independently by or for Panasonic Corporation,
- (2) The software owned by third party and licensed to Panasonic Corporation,
- (3) The open source software under the BSD licence and/or equivalent licenses.

The software categorized as of (3) is distributed in the hope that it will be useful, but WITHOUT ANY WARRANTY, without even the implied warranty of MERCHANTABILITY or FITNESS FOR A PARTICULAR PURPOSE.

The following license terms shall be applied to Open-Sourced Components.

1. Supplicant license

Copyright (C) 2003-2016, Jouni Malinen <j@w1.fi > and contributors.

All rights reserved.

This software may be distributed, used, and modified under the terms of BSD license:

Redistribution and use in source and binary forms, with or without modification, are permitted provided that the following conditions are met:

1. Redistributions of source code must retain the above copyright notice, this list of conditions and the following disclaimer.
2. Redistributions in binary form must reproduce the above copyright notice, this list of conditions and the following disclaimer in the documentation and/ or other materials provided with the distribution.
3. Neither the name(s) of the above-listed copyright holder(s) nor the names of its contributors may be used to endorse or promote products derived from this software without specific prior written permission.

THIS SOFTWARE IS PROVIDED BY THE COPYRIGHT HOLDERS AND CONTRIBUTORS AS IS AND ANY EXPRESS OR IMPLIED WARRANTIES, INCLUDING, BUT NOT LIMITED TO, THE IMPLIED WARRANTIES OF MERCHANTABILITY AND FITNESS FOR A PARTICULAR PURPOSE ARE DISCLAIMED. IN NO EVENT SHALL THE COPYRIGHT OWNER OR CONTRIBUTORS BE LIABLE FOR ANY DIRECT, INDIRECT, INCIDENTAL, SPECIAL, EXEMPLARY, OR CONSEQUENTIAL DAMAGES (INCLUDING, BUT NOT LIMITED TO, PROCUREMENT OF SUBSTITUTE GOODS OR SERVICES; LOSS OF USE, DATA, OR PROFITS; OR BUSINESS INTERRUPTION) HOWEVER CAUSED AND ON ANY THEORY OF LIABILITY, WHETHER IN CONTRACT, STRICT LIABILITY, OR TORT (INCLUDING NEGLIGENCE OR OTHERWISE) ARISING IN ANY WAY OUT OF THE USE OF THIS SOFTWARE, EVEN IF ADVISED OF THE POSSIBILITY OF SUCH DAMAGE.

Copyright^①

- The App Store is a service mark of Apple Inc.
- iPhone is a trademark of Apple Inc. registered in the United States and other countries. The iPhone trademarks is used under license of iPhone Co., Ltd.
- Android and Google Play are trademarks or registered trademarks of Google LLC.
- Other names, company names, product names, etc described in this manual are trademarks or registered trademarks of each company. In the text, some TM and [®] marks are not listed.

About Software

This product incorporates the following software:

- 1) The software developed independently by or for Panasonic Corporation,
- 2) The software owned by third party and licensed to Panasonic Corporation,
- 3) The software licensed under the GNU GENERAL PUBLIC LICENSE Version 2.0 (GPL V2.0),
- 4) Open sourced software other than the software licensed under the GPL V2.0.

The software categorized as (3) and (4) are distributed in the hope that it will be useful, but without any warranty, without even the implied warranty of [merchantability] or [fitness for a particular purpose].

Please refer to the detailed terms and conditions thereof shown in the "Software License" menu on this product.

At least three (3) years from delivery of this product, Panasonic will give to any third party who contacts us at the contact information provided below, for a charge no more than our cost of physically performing source code distribution, a complete machine-readable copy of the corresponding source code covered under GPL V2.0 or the other licenses with the obligation to do so, as well as the respective copyright notice thereof.

Contact information:

oss-cd-request@gg.jp.panasonic.com

The source code and the copyright notice are also available for free in our website below.

<https://panasonic.net/cns/oss/ap/>

lwIP

lwIP is licenced under the BSD licence:

Copyright (c) 2001-2004 Swedish Institute of Computer Science.

All rights reserved.

Copyright (c) 2001-2003 Swedish Institute of Computer Science. All rights reserved.

Copyright (c) 2002 CITEL Technologies Ltd. All rights reserved.

Copyright (c) 2007 Dominik Spies <kontakt@dspies.de> All rights reserved.

Copyright (c) 2002-2003, Adam Dunkels. All rights reserved.

Copyright (c) 2001-2003 Swedish Institute of Computer Science.

Copyright (c) 2003-2004 Leon Woestenberg <leon.woestenberg@axon.tv>

Copyright (c) 2003-2004 Axon Digital Design B.V., The Netherlands.

All rights reserved.

Copyright (c) 2001-2004 Leon Woestenberg <leon.woestenberg@gmx.net>

Copyright (c) 2001-2004 Axon Digital Design B.V., The Netherlands.

All rights reserved.

Copyright (c) 2001-2004 Axon Digital Design B.V., The Netherlands.

All rights reserved.

Copyright (c) 2001-2004 Axon Digital Design B.V., The Netherlands.

All rights reserved.

MINIX3

Copyright (c) 2016 The MINIX 3 Project.

All rights reserved.

Redistribution and use in source and binary forms, with or without modification, are permitted provided that the following conditions are met:

1. Redistributions of source code must retain the above copyright notice, this list of conditions and the following disclaimer.
2. Redistributions in binary form must reproduce the above copyright notice, this list of conditions and the following disclaimer in the documentation and/or other materials provided with the distribution.
3. The name of the author may not be used to endorse or promote products derived from this software without specific prior written permission.

THIS SOFTWARE IS PROVIDED BY THE AUTHOR "AS IS" AND ANY EXPRESS OR IMPLIED WARRANTIES, INCLUDING, BUT NOT LIMITED TO, THE IMPLIED WARRANTIES OF MERCHANTABILITY AND FITNESS FOR A PARTICULAR PURPOSE ARE DISCLAIMED. IN NO EVENT SHALL THE AUTHOR BE LIABLE FOR ANY DIRECT, INDIRECT, INCIDENTAL, SPECIAL, EXEMPLARY, OR CONSEQUENTIAL DAMAGES (INCLUDING, BUT NOT LIMITED TO, PROCUREMENT OF SUBSTITUTE GOODS OR SERVICES; LOSS OF USE, DATA, OR PROFITS; OR BUSINESS INTERRUPTION) HOWEVER CAUSED AND ON ANY THEORY OF LIABILITY, WHETHER IN CONTRACT, STRICT LIABILITY, OR TORT (INCLUDING NEGLIGENCE OR OTHERWISE) ARISING IN ANY WAY OUT OF THE USE OF THIS SOFTWARE, EVEN IF ADVISED OF THE POSSIBILITY OF SUCH DAMAGE.

mbdTLS

Copyright (C) 2006-2015, ARM Limited, All Rights Reserved

Copyright (C) 2006-2016, ARM Limited, All Rights Reserved

Apache License

Version 2.0, January 2004

<http://www.apache.org/licenses/>

TERMS AND CONDITIONS FOR USE, REPRODUCTION, AND DISTRIBUTION

1. Definitions.

"License" shall mean the terms and conditions for use, reproduction, and distribution as defined by Sections 1 through 9 of this document.

"Licensor" shall mean the copyright owner or entity authorized by the copyright owner that is granting the License.

"Legal Entity" shall mean the union of the acting entity and all other entities that control, are controlled by, or are under common control with that entity. For the purposes of this definition, "control" means (i) the power, direct or indirect, to cause the direction or management of such entity, whether by contract or otherwise, or (ii) ownership of fifty percent (50%) or more of the outstanding shares, or (iii) beneficial ownership of such entity.

"You" (or "Your") shall mean an individual or Legal Entity exercising permissions granted by this License.

"Source" form shall mean the preferred form for making modifications, including but not limited to software source code, documentation source, and configuration files.

"Object" form shall mean any form resulting from mechanical transformation or translation of a Source form, including but not limited to compiled object code, generated documentation, and conversions to other media types.

"Work" shall mean the work of authorship, whether in Source or Object form, made available under the License, as indicated by a copyright notice that is included in or attached to the work.

"Derivative Works" shall mean any work, whether in Source or Object form, that is based on (or derived from) the Work and for which the editorial revisions, annotations, elaborations, or other modifications represent, as a whole, an original work of authorship. For the purposes of this License, Derivative Works shall not include works that remain separable from, or merely link (or bind by name) to the interfaces of, the Work and Derivative Works thereof.

"Contribution" shall mean any work of authorship, including the original version of the Work and any modifications or additions to that Work or Derivative Works thereof, that is intentionally submitted to Licensor for inclusion in the Work by the copyright owner or by an individual or Legal Entity authorized to submit on behalf of the copyright owner. For the purposes of this definition, "submitted" means any form of electronic, verbal, or written communication sent to the Licensor or its representatives, including but not limited to communication on electronic mailing lists, source code control systems, and issue tracking systems that are managed by, or on behalf of, the Licensor for the purpose of discussing and improving the Work, but excluding

communication that is conspicuously marked or otherwise designated in writing by the copyright owner as "Not a Contribution."

"Contributor" shall mean Licensor and any individual or Legal Entity on behalf of whom a Contribution has been received by Licensor and subsequently incorporated within the Work.

2. Grant of Copyright License. Subject to the terms and conditions of this License, each Contributor hereby grants to You a perpetual, worldwide, non-exclusive, no-charge, royalty-free, irrevocable copyright license to reproduce, prepare Derivative Works of, publicly display, publicly perform, sublicense, and distribute the Work and such Derivative Works in Source or Object form.

3. Grant of Patent License. Subject to the terms and conditions of this License, each Contributor hereby grants to You a perpetual, worldwide, non-exclusive, no-charge, royaltyfree, irrevocable (except as stated in this section) patent license to make, have made, use, offer to sell, sell, import, and otherwise transfer the Work, where such license applies only to those patent claims licensable by such Contributor that are necessarily infringed by their Contribution(s) alone or by combination of their Contribution(s) with the Work to which such Contribution(s) was submitted.

If You institute patent litigation against any entity (including a cross-claim or counterclaim in a lawsuit) alleging that the Work or a Contribution incorporated within the Work constitutes direct or contributory patent infringement, then any patent licenses granted to You under this License for that Work shall terminate as of the date such litigation is filed.

4. Redistribution. You may reproduce and distribute copies of the Work or Derivative Works thereof in any medium, with or without modifications, and in Source or Object form, provided that You meet the following conditions:

- (a) You must give any other recipients of the Work or Derivative Works a copy of this License; and
- (b) You must cause any modified files to carry prominent notices stating that You changed the files; and
- (c) You must retain, in the Source form of any Derivative Works that You distribute, all copyright, patent, trademark, and attribution notices from the Source form of the Work, excluding those notices that do not pertain to any part of the Derivative Works; and
- (d) If the Work includes a "NOTICE" text file as part of its distribution, then any Derivative Works that You distribute must include a readable copy of the attribution notices contained within such NOTICE file, excluding those notices that do not pertain to any part of the Derivative Works, in at least one of the following places: within a NOTICE text file distributed as part of the Derivative Works; within the Source form or documentation, if provided along with the Derivative Works; or, within a display generated by the Derivative Works, if and wherever such third-party notices normally appear. The contents of the NOTICE file are for informational purposes only and do not modify the License. You may add Your own attribution notices within Derivative Works that You distribute, alongside or as an addendum to the NOTICE text from the Work, provided that such additional attribution notices cannot be construed as modifying the License.

You may add Your own copyright statement to Your modifications and may provide additional or different license terms and conditions for use, reproduction, or distribution of Your modifications, or for any such Derivative Works as a whole, provided Your use, reproduction, and distribution of the Work otherwise complies with the conditions stated in this License.

5. Submission of Contributions. Unless You explicitly state otherwise, any Contribution intentionally submitted for inclusion in the Work by You to the Licensor shall be under the terms and conditions of this License, without any additional terms or conditions.

Notwithstanding the above, nothing herein shall supersede or modify the terms of any separate license agreement you may have executed with Licensor regarding such Contributions.

6. Trademarks. This License does not grant permission to use the trade names, trademarks, service marks, or product names of the Licensor, except as required for reasonable and customary use in describing the origin of the Work and reproducing the content of the NOTICE file.

7. Disclaimer of Warranty. Unless required by applicable law or agreed to in writing, Licensor provides the Work (and each Contributor provides its Contributions) on an "AS IS" BASIS, WITHOUT WARRANTIES OR CONDITIONS OF ANY KIND, either express or implied, including, without limitation, any warranties or conditions of TITLE, NON-INFRINGEMENT, MERCHANTABILITY, or FITNESS FOR A PARTICULAR PURPOSE. You are solely responsible for determining the appropriateness of using or redistributing the Work and assume any risks associated with Your exercise of permissions under this License.

8. Limitation of Liability. In no event and under no legal theory, whether in tort (including negligence), contract, or otherwise, unless required by applicable law (such as deliberate and grossly negligent acts) or agreed to in writing, shall any Contributor be liable to You for damages, including any direct, indirect, special, incidental, or consequential damages of any character arising as a result of this License or out of the use or inability to use the Work (including but not limited to damages for loss of goodwill, work stoppage, computer failure or malfunction, or any and all other commercial damages or losses), even if such Contributor has been advised of the possibility of such damages.

9. Accepting Warranty or Additional Liability. While redistributing the Work or Derivative Works thereof, You may choose to offer, and charge a fee for, acceptance of support, warranty, indemnity, or other liability obligations and/or rights consistent with this License. However, in accepting such obligations, You may act only on Your own behalf and/or on Your sole responsibility, not on behalf of any other Contributor, and only if You agree to indemnify, defend, and hold each Contributor harmless for any liability incurred by, or claims asserted against, such Contributor by reason of your accepting any such warranty or additional liability.

END OF TERMS AND CONDITIONS

APPENDIX: How to apply the Apache License to your work.

To apply the Apache License to your work, attach the following boilerplate notice, with the fields enclosed by brackets "[]" replaced with your own identifying information. (Don't include the brackets!) The text should be enclosed in the appropriate comment syntax for the file format. We also recommend that a file or class name and description of purpose be included on the same "printed page" as the copyright notice for easier identification within third-party archives.

Copyright [yyyy] [name of copyright owner]

Licensed under the Apache License, Version 2.0 (the "License"); you may not use this file except in compliance with the License.

You may obtain a copy of the License at

<http://www.apache.org/licenses/LICENSE-2.0>

Unless required by applicable law or agreed to in writing, software distributed under the License is distributed on an "AS IS" BASIS, WITHOUT WARRANTIES OR CONDITIONS OF ANY KIND, either express or implied.

See the License for the specific language governing permissions and limitations under the License.

=====
Copyright (c) 2003-2016, Jouni Malinen
<j@w1.fi> and contributors All Rights Reserved.

This program is licensed under the BSD license (the one with advertisement clause removed).

If you are submitting changes to the project, please see CONTRIBUTIONS file for more instructions.

License

Copyright²

This software may be distributed, used, and modified under the terms of BSD license:

Redistribution and use in source and binary forms, with or without modification, are permitted provided that the following conditions are met:

1. Redistributions of source code must retain the above copyright notice, this list of conditions and the following disclaimer.
2. Redistributions in binary form must reproduce the above copyright notice, this list of conditions and the following disclaimer in the documentation and/or other materials provided with the distribution.
3. Neither the name(s) of the above-listed copyright holder(s) nor the names of its contributors may be used to endorse or promote products derived from this software without specific prior written permission.

THIS SOFTWARE IS PROVIDED BY THE COPYRIGHT HOLDERS AND CONTRIBUTORS "AS IS" AND ANY EXPRESS OR IMPLIED WARRANTIES, INCLUDING, BUT NOT LIMITED TO, THE IMPLIED WARRANTIES OF MERCHANTABILITY AND FITNESS FOR A PARTICULAR PURPOSE ARE DISCLAIMED. IN NO EVENT SHALL THE COPYRIGHT OWNER OR CONTRIBUTORS BE LIABLE FOR ANY DIRECT, INDIRECT, INCIDENTAL, SPECIAL, EXEMPLARY, OR CONSEQUENTIAL DAMAGES (INCLUDING, BUT NOT LIMITED TO, PROCUREMENT OF SUBSTITUTE GOODS OR SERVICES; LOSS OF USE, DATA, OR PROFITS; OR BUSINESS INTERRUPTION) HOWEVER CAUSED AND ON ANY THEORY OF LIABILITY, WHETHER IN CONTRACT, STRICT LIABILITY, OR TORT (INCLUDING NEGLIGENCE OR OTHERWISE) ARISING IN ANY WAY OUT OF THE USE OF THIS SOFTWARE, EVEN IF ADVISED OF THE POSSIBILITY OF SUCH DAMAGE.

Free RTOS

The FreeRTOS source code is licensed by a *modified* GNU General Public License (GPL). The modification is provided in the form of an exception.

NOTE: The modification to the GPL is included to allow you to distribute a combined work that includes FreeRTOS without being obliged to provide the source code for proprietary components outside of the FreeRTOS kernel.

The FreeRTOS GPL Exception Text:

Any FreeRTOS source code, whether modified or in its original release form, or whether in whole or in part, can only be distributed by you under the terms of the GNU General Public License plus this exception. An independent module is a module which is not derived from or based on FreeRTOS.

Clause 1:

Linking FreeRTOS statically or dynamically with other modules is making a combined work based on FreeRTOS. Thus, the terms and conditions of the GNU General Public License cover the whole combination.

As a special exception, the copyright holder of FreeRTOS gives you permission to link FreeRTOS with independent modules that communicate with FreeRTOS solely through the FreeRTOS API interface, regardless of the license terms of these independent modules, and to copy and distribute the resulting combined work under terms of your choice, provided that

- + Every copy of the combined work is accompanied by a written statement that details to the recipient the version of FreeRTOS used and an offer by yourself to provide the FreeRTOS source code (including any modifications you may have made) should the recipient request it.
- + The combined work is not itself an RTOS, scheduler, kernel or related product.
- + The independent modules add significant and primary functionality to FreeRTOS and do not merely extend the existing functionality already present in FreeRTOS.

Clause 2:

FreeRTOS may not be used for any competitive or comparative purpose, including the publication of any form of run time or compile time metric, without the express permission of Real Time Engineers Ltd. (this is the norm within the industry and is intended to ensure information accuracy).

The standard GPL exception text:

GNU GENERAL PUBLIC LICENSE
Version 2, June 1991

Copyright (C) 1989, 1991 Free Software Foundation, Inc. 59 Temple Place, Suite 330, Boston, MA 02111-1307 USA
Everyone is permitted to copy and distribute verbatim copies of this license document, but changing it is not allowed.

Preamble

The licenses for most software are designed to take away your freedom to share and change it. By contrast, the GNU General Public License is intended to guarantee your freedom to share and change free software--to make sure the software is free for all its users. This General Public License applies to most of the Free Software Foundation's software and to any other program whose authors commit to using it. (Some other Free Software Foundation software is covered by the GNU Library General Public License instead.) You can apply it to your programs, too.

When we speak of free software, we are referring to freedom, not price. Our General Public Licenses are designed to make sure that you have the freedom to distribute copies of free software (and charge for this service if you wish), that you receive source code or can get it if you want it, that you can change the software or use pieces of it in new free programs; and that you know you can do these things.

To protect your rights, we need to make restrictions that forbid anyone to deny you these rights or to ask you to surrender the rights. These restrictions translate to certain responsibilities for you if you distribute copies of the software, or if you modify it.

For example, if you distribute copies of such a program, whether gratis or for a fee, you must give the recipients all the rights that you have. You must make sure that they, too, receive or can get the source code. And you must show them these terms so they know their rights.

We protect your rights with two steps: (1) copyright the software, and (2) offer you this license which gives you legal permission to copy, distribute and/or modify the software.

Also, for each author's protection and ours, we want to make certain that everyone understands that there is no warranty for this free software. If the software is modified by someone else and passed on, we want its recipients to know that what they have is not the original, so that any problems introduced by others will not reflect on the original authors' reputations.

Finally, any free program is threatened constantly by software patents. We wish to avoid the danger that redistributors of a free program will individually obtain patent licenses, in effect making the program proprietary. To prevent this, we have made it clear that any patent must be licensed for everyone's free use or not licensed at all.

The precise terms and conditions for copying, distribution and modification follow.

GNU GENERAL PUBLIC LICENSE
TERMS AND CONDITIONS FOR COPYING,
DISTRIBUTION AND MODIFICATION

0. This License applies to any program or other work which contains a notice placed by the copyright holder saying it may be distributed under the terms of this General Public License. The "Program", below, refers to any such program or work, and a "work based on the Program" means either the Program or any derivative work under copyright law: that is to say, a work containing the Program or a portion

of it, either verbatim or with modifications and/or translated into another language. (Hereinafter, translation is included without limitation in the term "modification".) Each licensee is addressed as "you".

Activities other than copying, distribution and modification are not covered by this License; they are outside its scope. The act of running the Program is not restricted, and the output from the Program is covered only if its contents constitute a work based on the Program (independent of having been made by running the Program).

Whether that is true depends on what the Program does.

1. You may copy and distribute verbatim copies of the Program's source code as you receive it, in any medium, provided that you conspicuously and appropriately publish on each copy an appropriate copyright notice and disclaimer of warranty; keep intact all the notices that refer to this License and to the absence of any warranty; and give any other recipients of the Program a copy of this License along with the Program.

You may charge a fee for the physical act of transferring a copy, and you may at your option offer warranty protection in exchange for a fee.

2. You may modify your copy or copies of the Program or any portion of it, thus forming a work based on the Program, and copy and distribute such modifications or work under the terms of Section 1 above, provided that you also meet all of these conditions:

- a) You must cause the modified files to carry prominent notices stating that you changed the files and the date of any change.
- b) You must cause any work that you distribute or publish, that in whole or in part contains or is derived from the Program or any part thereof, to be licensed as a whole at no charge to all third parties under the terms of this License.
- c) If the modified program normally reads commands interactively when run, you must cause it, when started running for such interactive use in the most ordinary way, to print or display an announcement including an appropriate copyright notice and a notice that there is no warranty (or else, saying that you provide a warranty) and that users may redistribute the program under these conditions, and telling the user how to view a copy of this License. (Exception: if the Program itself is interactive but does not normally print such an announcement, your work based on the Program is not required to print an announcement.)

These requirements apply to the modified work as a whole. If identifiable sections of that work are not derived from the Program, and can be reasonably considered independent and separate works in themselves, then this License, and its terms, do not apply to those sections when you distribute them as separate works. But when you distribute the same sections as part of a whole which is a work based on the Program the distribution of the whole must be on the terms of this License, whose permissions for other licensees extend to the entire whole, and thus to each and every part regardless of who wrote it.

Thus, it is not the intent of this section to claim rights or contest your rights to work written entirely by you; rather, the intent is to exercise the right to control the distribution of derivative or collective works based on the Program.

In addition, mere aggregation of another work not based on the Program with the Program (or with a work based on the Program) on a volume of a storage or distribution medium does not bring the other work under the scope of this License.

3. You may copy and distribute the Program (or a work based on it, under Section 2) in object code or executable form under the terms of Sections 1 and 2 above provided that you also do one of the following:

- a) Accompany it with the complete corresponding machine-readable source code, which must be distributed under the terms of Sections 1 and 2 above on a medium customarily used for software interchange; or,
- b) Accompany it with a written offer, valid for at least three years,

to give any third party, for a charge no more than your cost of physically performing source distribution, a complete machine-readable copy of the corresponding source code, to be distributed under the terms of Sections 1 and 2 above on a medium customarily used for software interchange; or,

c) Accompany it with the information you received as to the offer to distribute corresponding source code. (This alternative is allowed only for noncommercial distribution and only if you received the program in object code or executable form with such an offer, in accord with Subsection b above.)

The source code for a work means the preferred form of the work for making modifications to it. For an executable work, complete source code means all the source code for all modules it contains, plus any associated interface definition files, plus the scripts used to control compilation and installation of the executable. However, as a special exception, the source code distributed need not include anything that is normally distributed (in either source or binary form) with the major components (compiler, kernel, and so on) of the operating system on which the executable runs, unless that component itself accompanies the executable.

If distribution of executable or object code is made by offering access to copy from a designated place, then offering equivalent access to copy the source code from the same place counts as distribution of the source code, even though third parties are not compelled to copy the source along with the object code.

4. You may not copy, modify, sublicense, or distribute the Program except as expressly provided under this License. Any attempt otherwise to copy, modify, sublicense or distribute the Program is void, and will automatically terminate your rights under this License. However, parties who have received copies, or rights, from you under this License will not have their licenses terminated so long as such parties remain in full compliance.

5. You are not required to accept this License, since you have not signed it. However, nothing else grants you permission to modify or distribute the Program or its derivative works. These actions are prohibited by law if you do not accept this License. Therefore, by modifying or distributing the Program (or any work based on the Program), you indicate your acceptance of this License to do so, and all its terms and conditions for copying, distributing or modifying the Program or works based on it.

6. Each time you redistribute the Program (or any work based on the Program), the recipient automatically receives a license from the original licensor to copy, distribute or modify the Program subject to these terms and conditions. You may not impose any further restrictions on the recipients' exercise of the rights granted herein. You are not responsible for enforcing compliance by third parties to this License.

7. If, as a consequence of a court judgment or allegation of patent infringement or for any other reason (not limited to patent issues), conditions are imposed on you (whether by court order, agreement or otherwise) that contradict the conditions of this License, they do not excuse you from the conditions of this License. If you cannot distribute so as to satisfy simultaneously your obligations under this License and any other pertinent obligations, then as a consequence you may not distribute the Program at all. For example, if a patent license would not permit royalty-free redistribution of the Program by all those who receive copies directly or indirectly through you, then the only way you could satisfy both it and this License would be to refrain entirely from distribution of the Program.

If any portion of this section is held invalid or unenforceable under any particular circumstance, the balance of the section is intended to apply and the section as a whole is intended to apply in other circumstances. It is not the purpose of this section to induce you to infringe any patents or other property right claims or to contest validity of any such claims; this section has the sole purpose of protecting the integrity of the free

Copyright^③

software distribution system, which is implemented by public license practices. Many people have made generous contributions to the wide range of software distributed through that system in reliance on consistent application of that system; it is up to the author/donor to decide if he or she is willing to distribute software through any other system and a licensee cannot impose that choice.

This section is intended to make thoroughly clear what is believed to be a consequence of the rest of this License.

8. If the distribution and/or use of the Program is restricted in certain countries either by patents or by copyrighted interfaces, the original copyright holder who places the Program under this License may add an explicit geographical distribution limitation excluding those countries, so that distribution is permitted only in or among countries not thus excluded. In such case, this License incorporates the limitation as if written in the body of this License.

9. The Free Software Foundation may publish revised and/or new versions of the General Public License from time to time. Such new versions will be similar in spirit to the present version, but may differ in detail to address new problems or concerns. Each version is given a distinguishing version number. If the Program specifies a version number of this License which applies to it and "any later version", you have the option of following the terms and conditions either of that version or of any later version published by the Free Software Foundation. If the Program does not specify a version number of this License, you may choose any version ever published by the Free Software Foundation.

10. If you wish to incorporate parts of the Program into other free programs whose distribution conditions are different, write to the author to ask for permission. For software which is copyrighted by the Free Software Foundation, write to the Free Software Foundation; we sometimes make exceptions for this. Our decision will be guided by the two goals of preserving the free status of all derivatives of our free software and of promoting the sharing and reuse of software generally.

NO WARRANTY

11. BECAUSE THE PROGRAM IS LICENSED FREE OF CHARGE, THERE IS NO WARRANTY FOR THE PROGRAM, TO THE EXTENT PERMITTED BY APPLICABLE LAW. EXCEPT WHEN OTHERWISE STATED IN WRITING THE COPYRIGHT HOLDERS AND/OR OTHER PARTIES PROVIDE THE PROGRAM "AS IS" WITHOUT WARRANTY OF ANY KIND, EITHER EXPRESSED OR IMPLIED, INCLUDING, BUT NOT LIMITED TO, THE IMPLIED WARRANTIES OF MERCHANTABILITY AND FITNESS FOR A PARTICULAR PURPOSE. THE ENTIRE RISK AS TO THE QUALITY AND PERFORMANCE OF THE PROGRAM IS WITH YOU. SHOULD THE PROGRAM PROVE DEFECTIVE, YOU ASSUME THE COST OF ALL NECESSARY SERVICING, REPAIR OR CORRECTION.

12. IN NO EVENT UNLESS REQUIRED BY APPLICABLE LAW OR AGREED TO IN WRITING WILL ANY COPYRIGHT HOLDER, OR ANY OTHER PARTY WHO MAY MODIFY AND/OR REDISTRIBUTE THE PROGRAM AS PERMITTED ABOVE, BE LIABLE TO YOU FOR DAMAGES, INCLUDING ANY GENERAL, SPECIAL, INCIDENTAL OR CONSEQUENTIAL DAMAGES ARISING OUT OF THE USE OR INABILITY TO USE THE PROGRAM (INCLUDING BUT NOT LIMITED TO LOSS OF DATA OR DATA BEING RENDERED INACCURATE OR LOSSES SUSTAINED BY YOU OR THIRD PARTIES OR A FAILURE OF THE PROGRAM TO OPERATE WITH ANY OTHER PROGRAMS), EVEN IF SUCH HOLDER OR OTHER PARTY HAS BEEN ADVISED OF THE POSSIBILITY OF SUCH DAMAGES.

END OF TERMS AND CONDITIONS

How to Apply These Terms to Your New Programs

If you develop a new program, and you want it to be of the greatest possible use to the public, the best way to achieve this is to make it free software which everyone can redistribute and change under these terms.

To do so, attach the following notices to the program. It is safest to attach them to the start of each source file to most effectively convey the exclusion of warranty; and each file should have at least the "copyright" line and a pointer to where the full notice is found.

<one line to give the program's name and a brief idea of what it does.>

Copyright (C) <year> <name of author>

This program is free software; you can redistribute it and/or modify it under the terms of the GNU General Public License** as published by the Free Software Foundation; either version 2 of the License, or (at your option) any later version.

This program is distributed in the hope that it will be useful, but WITHOUT ANY WARRANTY; without even the implied warranty of MERCHANTABILITY or FITNESS FOR A PARTICULAR PURPOSE. See the GNU General Public License for more details.

You should have received a copy of the GNU General Public License along with this program; if not, write to the Free Software Foundation, Inc., 59 Temple Place, Suite 330, Boston, MA 02111-1307 USA

Also add information on how to contact you by electronic and paper mail. If the program is interactive, make it output a short notice like this when it starts in an interactive mode:

Gnomovision version 69, Copyright (C) year name of author
Gnomovision comes with ABSOLUTELY NO WARRANTY; for details type `show w`.

This is free software, and you are welcome to redistribute it under certain conditions; type `show c` for details.

The hypothetical commands `show w` and `show c` should show the appropriate parts of the General Public License. Of course, the commands you use may be called something other than `show w` and `show c`; they could even be mouseclicks or menu items--whatever suits your program.

You should also get your employer (if you work as a programmer) or your school, if any, to sign a "copyright disclaimer" for the program, if necessary. Here is a sample; alter the names:

Yoyodyne, Inc., hereby disclaims all copyright interest in the program 'Gnomovision' (which makes passes at compilers) written by James Hacker.

<signature of Ty Coon>, 1 April 1989

Ty Coon, President of Vice

This General Public License does not permit incorporating your program into proprietary programs. If your program is a subroutine library, you may consider it more useful to permit linking proprietary applications with the library. If this is what you want to do, use the GNU Library General Public License instead of this License.

Memo

Panasonic Corporation
Website: <http://www.panasonic.com>

© Panasonic Corporation 2024

Printed in Philippines

ACXF55-38260