

NOISE CONSIDERATION

- Select an installation location that can support the weight of the air conditioner and one that will not cause increased operating noise and vibration.
- Ensure that when installed, airflow and noise from the rear side of the unit (outdoor) do not disturb neighbouring elements.
- Obstacles placed in front of the air outlet on the rear side of the unit (outdoor), or covers placed over it will cause excessive noise and deterioration in performance.

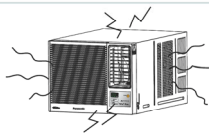

TRANSFERRING

- Repositioning or transfer of the air conditioner due to renovation or moving requires an additional service charge. Please consult your dealer before moving.

5 AIR CONDITIONER OPERATION

OPERATING THE UNIT



Start operation by pressing OPERATION. The operation will turn on and the display panel will light up. To stop the operation, press the OPERATION again. The unit will stop operating and the display panel light will turn off.

SETTING DISPLAY TEMPERATURE

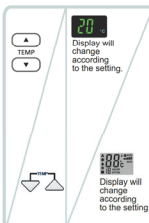

Press TEMP/TIMER ▲ or ▼ to set the display temperature. The temperature can be set between 16°C and 30°C. Recommended temperature: 26°C-28°C

NOTES:

- The previous set temperature will be stored and displayed when the air-con is ON.

SELECTING OPERATION MODE

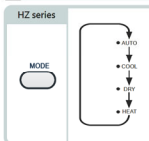

Press MODE to select the desired operation. (The indicator will light up and a "beep" sound will indicate changing setting)

AUTO mode
Air conditioners are automatically operated according to indoor and outdoor temperatures.

COOL mode
To set room temperature to your preference of cooling comfort.

HEAT mode
To set room temperature to your preference of heating comfort.

DRY mode
DRY mode unit operates at low fan speed to give a gentle cooling operation.

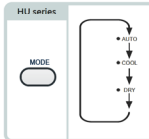

Press MODE to select the desired operation. (The indicator will light up and a "beep" sound will indicate changing setting)

AUTO mode
Air conditioners are automatically operated according to indoor and outdoor temperatures.

COOL mode
To set room temperature to your preference of cooling comfort.

DRY mode
DRY mode unit operates at low fan speed to give a gentle cooling operation.

SELECTING FAN SPEED



Press FAN SPEED selection button to choose fan speed level of the fan. (The indicator will light up and a "beep" sound will indicate changing setting)

If air conditioner automatically selects COOL or DEHUMIDIFYING mode and the fan speed is at AUTO speed, it will operate the "Self-cleaning" function to clear the dust on Heat exchanger, (Defer air flow for 40 seconds or intermittently operate)

ADJUSTING HORIZONTAL AIRFLOW DIRECTION

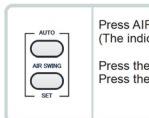

Press AIR SWING button to select air swing direction angle. (The indicator will light up and a "beep" sound will indicate changing setting)

Press the upper button to adjust left and right airflow direction. Press the lower button to stop AIR SWING.

POWERFUL OPERATION

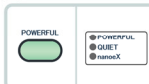

To reduce / increase the temperature quickly under cool mode/heat mode: Press POWERFUL button, after powerful is selected, the operation will go on for 4 hours, after that it will shift back to previous operation mode. If you want to cancel this operation, press powerful button once more.

SETTING THE OFF TIMER

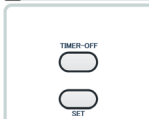

When the air conditioner is OFF: Press the TIMER-OFF button to set the timer. Press the same button until the preferred hour of operation is reached. (The TIMER indicator light will blink to await for setting) Press TIMER SET button to complete the setting. At this time, the TIMER indicator light is steady instead of blinking.

NOTE:
It is unavailable to set ON TIMER and OFF TIMER simultaneously. The timer figure will change according to the time remaining.

QUIET OPERATION



To reduce / increase temperature quickly: Press QUIET button. If you want to cancel this operation, press QUIET button once more.

SETTING THE ON TIMER



When the air conditioner is ON: Press the TIMER-ON button to set the timer. Press the same button until the preferred hour of operation is reached. (The TIMER indicator light will blink to await for setting) Press TIMER SET button to complete the setting. At this time, the TIMER indicator light is steady instead of blinking.

NOTE:
It is unavailable to set ON TIMER and OFF TIMER simultaneously. The timer figure will change according to the time remaining.

CANCEL OFF TIMER SETTING



Press the CANCEL button to cancel the timer setting. The TIMER indicator light will turn off. However the temperature remains displayed.

nanoeX Operation

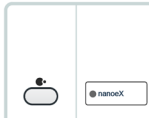

- When the OFF/ON button is pressed, the nanoe™X function automatically starts operation.
- To manually ON (start) or OFF (close) this operation, press . (nanoeX indicator is on or off)
- Even when the machine is turned off, this operation can still be activated. In this case, the blades and air volume will be operated according to the remote control settings.
- If a power interruption occurs during operation, the operation will resume immediately after the power is restored.

Note: When nanoe™X is in action, it will produce nano-ions, so sometimes it will make a little sound. If you really care about this sound, please turn off this function.

Note: NanoexX can also be started in HEAT mode, and nanoeX can be started independently when COOL/HEAT/DRY is not running.

Note: When nanoeX is started alone, the remote control display screen is shown on the right. The air volume and direction can be adjusted automatically (ON or OFF)

nanoeX can keep skin moisturized and hair soft. (The effect on skin and hair will vary according to the season, surrounding environment (temperature, humidity), usage time and personal conditions.)

nanoeX can alleviate the peculiar smell in the room and inhibit the growth of bacteria and mold. (It can also effectively reduce the odor (smoke and oily smoke) or bacteria attached to the curtain. The inhibitory effects of bacteria and molds are the results of demonstration in confined spaces, not actual use of space. In addition, the deodorizing effect will vary depending on the environment (temperature, humidity), operating time, ozone, and fiber type.)

As nanoeX is produced by using the air in the room, it may not be produced due to temperature and humidity conditions.

Production conditions:
Indoor temperature: about 5°C~35°C
(Dew point temperature: above 2°C)
Relative humidity: about 30%~85%

SLEEP (Cooling mode)



- This setting enables the human body to enter sleep and automatically adjust the temperature to achieve sleep comfort and energy-efficient operation.
- When the sleep button is pressed (or touch control panel sleep light on), the air conditioner enters the sleep mode schedule. Press it again to cancel the sleep schedule.
- After sleep is activated, the SLEEP LED is on, and pressing it again will cancel the sleep mode (SLEEP LED is dim).
- SLEEP mode is released when the machine is turned off.

Note: During sleep operation, in order to avoid over-cooling and over-heating, the temperature, air volume and wind direction will not follow the remote control settings and will be adjusted automatically. If the user needs cannot be met, the temperature or air volume can be reset.

After the body enters the sleep state, the body temperature drops so in the sleep mode, the air conditioner will keep running for one hour or increase by 1°C after reaching the set temperature, so that people have a comfortable sleeping environment.

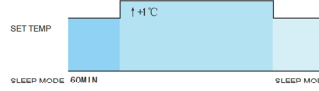

To connect to a network

For Wireless LAN Module operation setup please refer to Setup Instructions Manual.

6 HELPFUL INFORMATION & ENERGY SAVING HINTS

HELPFUL INFORMATION

Auto Restart Control

- Operation will automatically resume under the previous operation mode.
- If the unit was set to TIMER mode or SLEEP mode, operation will not resume automatically.

Timer Setting

- When power failure occurs, the timer setting is cancelled. Once power returns, reset timer.

ENERGY SAVING HINTS

- Clean the air filter every 2 weeks. Regular cleaning of the air filter preserves efficiency.
- Keeping ventilation set to close keeps cool air in and hot air out.
- Avoid direct sunlight and heat.
- For health reason do not overcool your room.
- Your air conditioner's cooling capacity should match your room size.

7 CARE AND MAINTENANCE

WARNING Always turn off the air conditioner and the main power supply before cleaning the unit. Switch off the power supply if the unit is not going to be used for a long period of time.

- Clean the cabinet, front grille with mild soap or detergent and lukewarm water.
 - The front intake grille can be easily removed for cleaning purposes (refer to Remove the front intake grille procedures). Gently wash it with water and a sponge.
 - The filter can be easily cleaned using a vacuum cleaner. Vacuum the front of the filter and then wash the rear with water. If it is badly spoiled, wash with a mild household detergent.
 - Do not clean with benzene, thinner, scouring powder or cloth soaked in caustic chemicals.
 - If the unit is extremely dirty, heat transfer is less efficient and the unit may not cool effectively. Contact Shun Hing Electric Service Centre Ltd. for an annual check. (Annual check is not covered by the warranty.)
 - If the air filter becomes clogged with dust, the cooling capacity will drop, and 6% of the electricity used to operate the air conditioner will be wasted.
- NOTE:** Do not dry the front panel or the air filter in direct sunlight. (Exposure to direct sunlight may discolour deform the panel.)

PRE-SEASON INSPECTION

Is the discharged air cold?
After 15 minutes of operation, it is normal for the temperature difference between intake and outlet air to be more than 0°C for cooling.

Are the air intake and outlet vanes of the indoor and outdoor side obstructed?
Are the remote control batteries weak?
The temperature difference between the blower outlet and the suction temperature under the normal state of the machine: cooling 8°C or above, heating (Heat pump mode) 14°C or above, is a normal phenomenon.

RECOMMENDED INSPECTION

Usage over several seasons will reduce performance as the unit becomes dirty. A dirty unit may produce foul odours and dust may clog the dehumidifying drainage. Seasonal inspection is recommended in addition to regular cleaning. Consult Shun Hing Electric Service Centre Ltd.,

8 BEFORE CALLING FOR SERVICE

BEFORE Check the following points before calling for repairs or service. If the malfunction persists, please contact Shun Hing Electric Service Centre Ltd.,

- | | |
|---|---|
| <p>Condition 1 If the unit is too noisy during operation.</p> <p>The following sounds are normal during operation:</p> <ul style="list-style-type: none"> A low humming sound indicating that the unit is operating. A soft clicking sound when the compressor turns on and off. A flowing sound due to circulation of the refrigerant when the compressor is turned on. A splashing sound indicating condensation in the condenser coil. If you hear other noises, please consult Shun Hing Electric Service Centre Ltd., | <p>Condition 4 If water drips off the rear of the unit.</p> <ul style="list-style-type: none"> Humidity is high. Condensed water is overflowing. To rectify the problem, mount an optional drain pan to the unit. |
| <p>Condition 2 If the unit does not operate.</p> <ul style="list-style-type: none"> The main power cord is not plugged in. The main circuit breaker has tripped. Remote control batteries are weak. | <p>Condition 5 If water drips inside the room.</p> <ul style="list-style-type: none"> The unit is tilted inward. To rectify this, tilt the unit slightly outward. Mount the optional drain pan if you prefer. The drain pan may be blocked. |
| <p>Condition 3 If the unit does not cool properly.</p> <ul style="list-style-type: none"> The room is too big for the unit's capacity. The ventilation lever is set to OPEN The air circulation is impeded by curtains or furniture. After 15 minutes of operation, it is normal for the temperature difference between intake and outlet air to be more than 8°C for cooling. | <p>Condition 6</p> <ul style="list-style-type: none"> Squeaking noise during operation. Squeaking noise after shutting down (This is due to the expansion or contraction of the host due to temperature changes) |

Information for Users on Collection and Disposal of Old Equipment and used Batteries
(Information on Disposal in other Countries outside the European Union)
These symbols are only valid in the European Union. If you wish to discard these items, please contact your local authorities or dealer and ask for the correct method of disposal.

Note for the battery symbol (bottom two symbol examples):
This symbol might be used in combination with a chemical symbol in this case it complies with the requirement set by the Directive for the chemical involved.

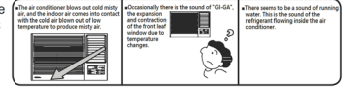

To call Shun Hing Electric Service Centre Ltd. IMMEDIATELY Turn off the power and contact Shun Hing Electric Service Centre Ltd. as soon as any of the following events occur

- The circuit breaker frequently trips or the fuse blows regularly.
- If water or foreign objects have accidentally entered the air conditioner.
- If there is abnormal sound during operation.

NOTE:

- The enclosure opposing the room side is splash proof (IPX4).
- Do not install this appliance in a laundry room or other locations where water may drip from the ceiling, etc.
- If the supply cord is damaged or need to be replaced, it must be replaced by the manufacturer or its service agent or a similarly qualified person in order to avoid a hazard.