

# Panasonic

## Operating Instructions (Household use) Rechargeable Shaver

Model No. ES-LV9U

English..... 3

中文 ..... 29





Operating Instructions  
(Household use) Rechargeable Shaver  
Model No. ES-LV9U

## Contents

---

<b>Safety precautions.....</b>	<b>4</b>	<b>Replacing the cleaning liquid.....</b>	<b>20</b>
<b>Important information .....</b>	<b>9</b>	<b>When the LOW/STATUS lamp glows .....</b>	<b>21</b>
<b>Parts identification .....</b>	<b>11</b>	<b>FAQ .....</b>	<b>22</b>
<b>Preparation.....</b>	<b>12</b>	<b>Troubleshooting .....</b>	<b>22</b>
<b>How to use .....</b>	<b>14</b>	<b>Battery life .....</b>	<b>27</b>
<b>Cleaning thoroughly.....</b>	<b>17</b>	<b>Removing the built-in rechargeable battery .....</b>	<b>27</b>
<b>Replacing the system outer foil and the inner blades.....</b>	<b>19</b>	<b>Specifications .....</b>	<b>28</b>

Thank you for purchasing this Panasonic product.

**Before operating this unit, please read these instructions completely and save them for future use.**

## Safety precautions

Make sure to follow these instructions.

To prevent accidents, injuries or damage to property, please follow the instructions below.

- **The following chart indicates the degree of damage caused by improper operation.**

 **DANGER** Indicates a potential hazard that will result in serious injury or death.

 **WARNING** Indicates a potential hazard that could result in serious injury or death.

 **CAUTION** Indicates a potential hazard that could result in minor injury or property damage.

- **The symbols are classified and explained as follows.**

 This symbol indicates prohibition.

 This symbol indicates requirement that must be followed.

## WARNING

### ► This product

**This product has a built-in rechargeable battery. Do not throw into fire, apply heat, or charge, use, or leave in a high temperature environment.**



- Doing so may cause overheating, ignition, or explosion.

### **Do not modify or repair.**

- Doing so may cause fire, electric shock, or injury.



Contact an authorized service center for repair (replacement of battery etc).

### **Never disassemble except when disposing of the product.**



- Doing so may cause fire, electric shock, or injury.

## WARNING

### ► In case of an abnormality or malfunction

**Immediately stop using and disconnect the AC adaptor.**

- Failure to do so may cause fire, electric shock, or injury.

**<Abnormality or malfunction cases>**



• The main unit, self-cleaning recharger, AC adaptor or cord is deformed or abnormally hot.

• The main unit, self-cleaning recharger, adaptor or cord smells of burning.

• There is an abnormal sound during use or charging of the main unit or self-cleaning recharger.

- Immediately request inspection or repair at an authorized service center.

### ► Power supply



**Do not connect or disconnect the adaptor to a household outlet with a wet hand.**

- Doing so may cause electric shock or injury.

**Do not immerse the AC adaptor and the self-cleaning recharger in water or wash with water. Do not place the AC adaptor and the self-cleaning recharger over or near water filled sink or bathtub.**



**Never use the appliance if the AC adaptor is damaged or if the power plug fits loosely in a household outlet.**

**Do not damage the cord or the power plug.**

• Do not deface, modify, forcefully bend or pull the cord or the power plug. Also, do not place anything heavy on, twist or pinch the cord.

- Doing so may cause electric shock or fire due to a short circuit.



**Do not use in a way that would exceed the rating of the household outlet or the wiring.**

- Exceeding the rating by connecting too many plugs to one household outlet may cause fire due to overheating.



**Do not use anything other than the supplied AC adaptor and the self-cleaning recharger for any purpose.**

**Also, do not use any other product with the supplied AC adaptor and the self-cleaning recharger. (See page 11.)**

- Doing so may cause burn or fire due to a short circuit.



**Fully insert the power plug.**

- Failure to do so may cause fire or electric shock.

**⚠ WARNING**

- ⚠ Disconnect the AC adaptor when cleaning the main body with water.**  
- Failure to do so may cause electric shock or injury.

- ⚠ Regularly clean the power plug and the appliance plug to prevent dust from accumulating.**  
- Failure to do so may cause fire due to insulation failure caused by humidity.

**▶ Preventing accidents**

- ⊘ Persons using an implanted medical electronic device, such as a pacemaker, should not allow this product to be in the vicinity of where the medical electronic device is implanted.**  
- Doing so may cause an accident or illness.

- ⊘ Do not place within reach of children or infants. Do not let them use it.**  
- Putting parts or accessories in the mouth may cause an accident or injury.

- ⊘ Do not use or store the self-cleaning recharger on top of other electrical devices.**  
- Doing so may cause electric shock due to liquid spill or fire due to a short circuit.

If detergent or oil is consumed accidentally, do not induce vomiting, drink a large amount of water and contact a physician.

- ⚠ If detergent or oil comes into contact with eyes, wash immediately and thoroughly with running water and contact a physician.**  
- Failure to follow these instructions may result in physical problems.

If detergent contacts skin, wash immediately and thoroughly with soap.

- ⚠ If you experience skin irritation anywhere on the body, stop using immediately and contact a physician.**  
- Failure to follow these instructions may result in physical injury or injury to the skin.

**▶ Note the following precautions**

This appliance is not intended for use by persons (including children) with reduced physical, sensory or mental capabilities, or lack of experience and knowledge, unless they have been given supervision or instruction concerning use of the appliance by a person responsible for their safety. **Children should be supervised to ensure that they do not play with the appliance.**

- ⚠** - Failure to do so may cause an accident or injury.

**⚠ WARNING**

**The supply cord cannot be replaced. If the cord is damaged, the AC adaptor should be scrapped.**

- Failure to do so may cause an accident or injury.

**⚠ CAUTION****► Protecting the skin**

**Do not use excessive pressure to apply the system outer foil to your lip or other part of your face.**



**Do not apply the system outer foil directly to blemishes or injured skin.**

**Do not touch the blade section (metallic section) of the inner blade.**

- Doing so may cause injury to skin or hand.

**Do not forcefully press the system outer foil. Also, do not touch the system outer foil with fingers or nails when in use.**



**Do not use this product for hair on head or any other part of the body.**

- Doing so may cause injury to skin or reduce the life of the system outer foil.

**Do not remove the shaver from the self-cleaning recharger while using the "AUTO" mode or "Dry/Charge" mode.**



- Doing so may cause skin burn due to high temperatures around the system outer foil.



**Check the system outer foil for cracks or deformations before use.**

- Failure to do so may cause injury to the skin.

**► Note the following precautions**

**Do not allow metal objects or trash to adhere to the power plug or the appliance plug.**



- Doing so may cause electric shock or fire due to a short circuit.



**Do not share your shaver with your family or other people.**

- Doing so may result in infection or inflammation.



**Do not use detergent for any purpose other than washing the shaver blades.**

- Using it with other products may cause discoloration or cracking.



**Disconnect the adaptor from the household outlet when not charging.**

- Failure to do so may cause electric shock or fire due to electrical leakage resulting from insulation deterioration.



**Use caution when opening detergent as spout is sharp.**

- Failure to do so may cause injury.

## Handling of the removed battery when disposing

### DANGER

- **The rechargeable battery is exclusively for use with this appliance. Do not use the battery with other products.**
- **Do not charge the battery after it has been removed from the product.**
- **Do not throw into fire or apply heat.**
- **Do not hit, disassemble, modify, or puncture with a nail.**
- **Do not let the positive and negative terminals of the battery get in contact with each other through metallic objects.**
- **Do not carry or store the battery together with metallic jewellery such as necklaces and hairpins.**
- **Do not use or leave the battery where it will be exposed to high temperatures, such as under direct sunlight or near other sources of heat.**
- **Never peel off the tube.**
  - Doing so may cause overheating, ignition, or explosion.

### WARNING

**After removing the rechargeable battery, do not keep it within reach of children and infants.**

-  The battery will harm the body if accidentally swallowed.  
If this happens, consult a physician immediately.

**If the battery fluid leaks out and comes in contact with the eyes, do not rub the eyes, and thoroughly rinse with clean water, such as tap water.**

-  Failure to do so may cause eye injury.  
Consult a physician immediately.

### CAUTION

**If the battery fluid leaks out and comes in contact with the skin or clothes, rinse off with clean water, such as tap water.**

-  Failure to do so may cause inflammation.



## Important information

- This WET/DRY shaver can be used for wet shaving using shaving lather or for dry shaving. You can use this watertight shaver in the shower and clean with water. The following symbol means suitable for use in a bath or shower.



- Treat yourself to wet lather shaves for at least three weeks and notice the difference. Your Panasonic WET/DRY shaver requires a little time to get used to because your skin and beard need about a month to adjust to any new shaving method.
- Keep both the inner blades inserted. If only one of the inner blades is inserted, the shaver may be damaged.
- If you clean the shaver with water, do not use salt water or hot water. Do not soak the shaver in water for a long period of time.
- The following symbol indicates that a specific detachable power supply unit is required for connecting the electrical appliance to the supply mains. The type reference of power supply unit is marked near the symbol.



- Charge the appliance correctly according to these Operating Instructions. (See page 12 "Charging the shaver".)

- This appliance contains battery that is only replaceable by skilled persons. Please contact an authorized service center for the details of repair.

## Note the following precautions

### ► When using

- Do not bring the system outer foil into contact with hard objects. Doing so may damage the system outer foil as it is very thin and deforms easily.
- Do not drop or hit against other objects. Doing so may cause injury.

### ► About detergent

- Do not leave the detergent in location of high temperatures. Doing so may cause deterioration.
- Immediately wipe up any cleaning liquid that has been spilled. Prolonged contact may cause discoloration of leather products or wooden floors.

### ► When storing

- Store the shaver in a place with low humidity after use. Failure to do so may cause malfunction due to condensation or rust.
- Be sure to place the protective cap on the shaver when carrying around or storing. Failure to do so may cause injury to skin or reduce the life of the system outer foil.

**► When cleaning**

- Do not dry the main unit with a dryer or a fan heater.  
Doing so may cause malfunction or deformation of the parts.
- Do not leave the shaver exposed to direct sunlight with the foil frame detached.  
Doing so may deteriorate the waterproof rubber and degrade waterproof function, which may cause to malfunction.

# Parts identification

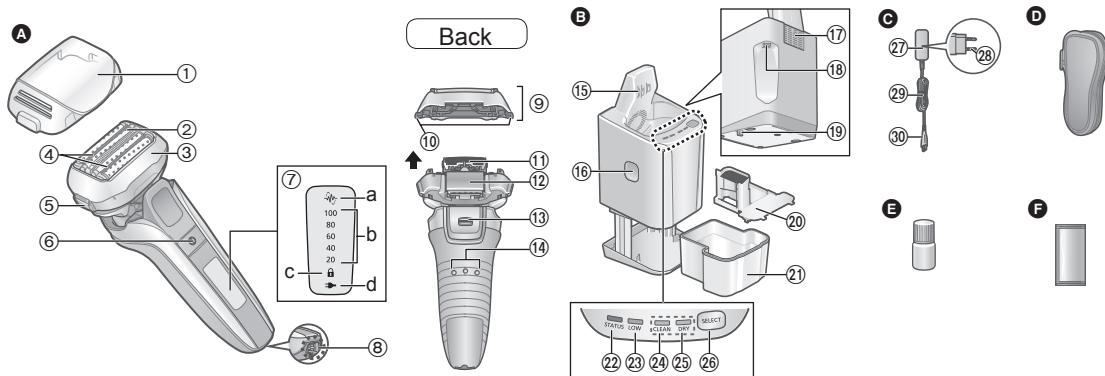

## A Main body

- ① Protective cap
- ② System outer foil
- ③ Foil frame
- ④ Smooth rollers
  - They help to glide over the skin more easily.
- ⑤ Foil frame release buttons
- ⑥ Power switch
- ⑦ Lamp display
  - a. Shaving sensor lamp (💡)
  - b. Battery capacity lamp

- c. Switch lock lamp (🔒)
- d. Charge status lamp (➔)

- ⑧ Appliance socket
- ⑨ Outer foil section
- ⑩ System outer foil release buttons
- ⑪ Inner blades
- ⑫ Trimmer
- ⑬ Trimmer handle
- ⑭ Main body rear terminals

## B Self-cleaning recharger (RC9-22)

- ⑮ Charging terminals

## C AC adaptor (RE7-87)

- ⑯ Cleaning liquid unit removal button
- ⑰ Intake port
- ⑱ Self-cleaning recharger socket
- ⑲ Lock release lever
- ⑳ Cleaning liquid filter
- ㉑ Cleaning liquid unit
- ㉒ STATUS lamp
- ㉓ LOW lamp
- ㉔ CLEAN lamp
- ㉕ DRY lamp
- ㉖ SELECT button
- ㉗ Adaptor
- ㉘ Power plug
- ㉙ Cord

- ㉚ Appliance plug
- Accessories

## D Travel case

## E Oil

## F Special detergent (Detergent)

There may be water droplets inside the self-cleaning recharger at the time of purchase, but there is no problem regarding the hygiene. They are remains after the factory inspection.

## Preparation

### Charging the shaver

- Turn the shaver off.
- Wipe off any water droplets on the main body rear terminals.

#### 1 Insert the appliance plug into the self-cleaning recharger.

#### 2 Remove the protective cap while pressing the side of the cap and insert the shaver into the self-cleaning recharger.

- Slowly insert the shaver into the self-cleaning recharger taking care not to damage the system outer foil.

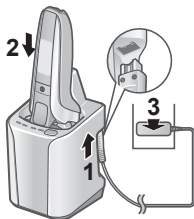

#### 3 Plug the adaptor into a household outlet.

- Check that the charge status lamp (➡) is glowing.
- Charging is completed after approx. 1 hour.

#### 4 Disconnect the adaptor after charging is completed.

#### Quick charge

Even though the battery runs out, you can shave once after 3-minute charge.  
(This will differ depending on usage.)

#### While charging

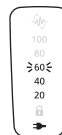

➡ glows.

The number of the battery capacity lamp will increase as charging progresses.

#### After charging is completed

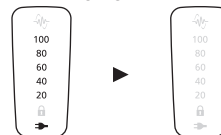

All the battery capacity lamp and ➡ will glow and then turn off after 5 seconds.

#### Notes

- When charging the shaver for the first time or when it has not been in use for more than 6 months, the charging time may change or the charge status lamp (➡) may not glow for a few minutes. It will eventually glow if kept connected.
- Recommended ambient temperature for charging is 10 °C – 35 °C. It may take longer to charge, or the charge status lamp (➡) will blink quickly and the battery may fail to charge properly in extremely high or low temperatures.

- The shaver can be used for approximately 2 weeks with a full charge.

(Based on one 3-minute dry-shave usage per day in an ambient temperature range of 20 °C – 30 °C.)

The number of usable days varies depending on the following conditions.

- Beard thickness
- Pressure applied to the skin
- Usage frequency of the sonic vibration cleaning mode

- If there is noise from the radio or other sources while using or charging the appliance, move to a different location to use the appliance.

## Charging without the self-cleaning recharger

- Turn the shaver off.
- Wipe off any water droplets on the appliance socket.

**1 Insert the appliance plug into the shaver.**

**2 Plug the adaptor into a household outlet.**

**3 Disconnect the adaptor after charging is completed.**

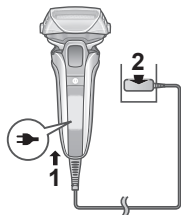

### Note

You cannot operate the shaver while charging.

## Preparing the cleaning liquid

Cleaning can start right after the usage by preparing in advance.

- Remove the AC adaptor from the self-cleaning recharger.

**1 Press the cleaning liquid unit removal button (1) and remove the cleaning liquid unit (2) on a hard, flat surface.**

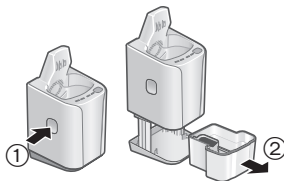

- When the self-cleaning recharger is lifted, or on the soft surface such as carpets, the lock release lever will not fit in the recharger properly. In that case, the cleaning liquid unit cannot be removed.

**2 Pour tap water (1) and detergent (2) into the cleaning liquid unit.**

- Be careful not to let the water rise above the maximum water line (a).
- Pour the entire packet of detergent.

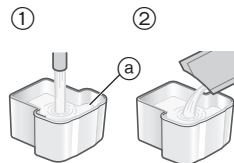

**3 Slowly insert the cleaning liquid unit into the self-cleaning recharger until it clicks.**

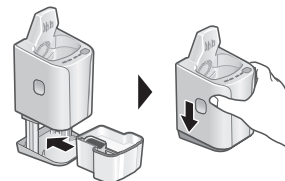

### Notes

- To replace the cleaning liquid, see page 20.
- Only use self-cleaning recharger detergent for Panasonic shavers. Not doing so may cause malfunction or failure.
- Do not tilt the self-cleaning recharger. Doing so may cause spill or the number of days that cleaning liquid can be used reduce.

- You can use the cleaning liquid for approximately 30 days if used once per day. (This will differ depending on beard thickness and the ambient temperature.)

## How to use

### Shaving beard

#### 1 Press and shave.

- The “shaving sensor”, which automatically adjusts the power depending on the beard thickness, will operate.

It will shave with high power on areas where the beard is heavy, and reduce the power on areas where the beard is thin, to reduce burden on the skin.



#### Tips for better shaving

Apply the whole system outer foil perpendicularly against the skin and shave by slowly gliding the shaver over the face against the grain of the beard.

- The beard under the chin and around the throat can be shaved better by stretching the skin so the beard will stand.
- To prevent damaging the system outer foil, do not shave with only a part of the system outer foil.

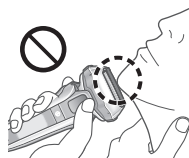
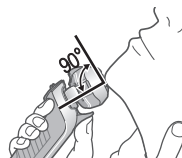

#### 2 Press when finished.

## While using

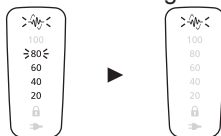

The remaining battery capacity are shown and then turn off after 5 seconds.

- Approximate amount of battery capacity is displayed as 20 - 100.
- The shaving sensor lamp (  ) blinks.

## After use

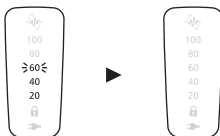

The remaining battery capacity blink and then turn off after 5 seconds.

When the battery capacity is low "20" blinks when operating the shaver.

- You can shave 2 to 3 times after "20" blinks. (This will differ depending on usage.)



## Notes

- The appliance may not operate in an ambient temperature lower than approximately 5 °C.
- The shaving sensor may not respond depending on the type and quantity of the shaving gel. This is not abnormal.



- Depending on the beard thickness or the amount of beard trimmings in the shaver head, the shaving sensor may not react and the driving sound may not change. This is not abnormal.
- To prevent erroneous operation, place your fingers on the finger rest while using the shaver.
- The sonic vibration cleaning mode is activated when the power switch is pressed for more than 2 seconds while the shaver is not operating. (See page 18.) You cannot shave in this mode.

## Operation and display of the switch lock

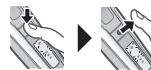

## ▶ Locking the power switch

1. Press  once and then release.
  - The shaver starts operating.



2. Press  for more than 2 seconds until the switch lock lamp (  ) turns on.
  - The shaver will stop operating.



3. Release .
  - The switch lock lamp (  ) will light up for 5 seconds and turn off.

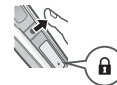

## ► Unlocking the power switch

1. Press **(1)** for more than 2 seconds until the switch lock lamp (🔒) turns off.
2. Once the shaver starts operating, release **(1)**.
  - The switch lock lamp (🔒) will turn off.



- The power switch is locked when the switch lock lamp (🔒) blinks for 5 seconds and the shaver does not operate even though the power switch is pressed.

## ► Using the trimmer

1. Slide the trimmer handle up to the “mm” position so that the trimmer stands upright.
2. Press **(1)** and use.

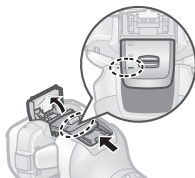

Press and hold the top knob (a) and slide the trimmer handle down to lower the trimmer.

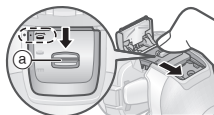

## Tips for better usage

Apply the trimmer edge perpendicular to skin gently and move downward slowly.

## Trimming sideburns



## Pre-shave of long beards



## ► Switching the shaver head

You can change the pivot action.



The shaver head is moved to prevent missed spots.



You can lock the shaver head.



## Cleaning, drying, charging

We recommend cleaning the shaver after each use.

- 1 **Insert the shaver into the self-cleaning recharger and plug the adaptor into a household outlet. (See page 12.)**

- Check that the charge status lamp (➔) is glowing.
- When the LOW lamp or the STATUS lamp lights up, see page 21.

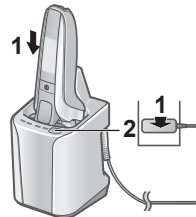

- 2 Press **(SELECT)**.



The CLEAN lamp and the DRY lamp glow, and the “AUTO” mode will start after approximately 6 seconds.

- It is not possible to change the mode after the “AUTO” mode has started.



\*When the ambient temperature of the self-cleaning recharger is low (approx. 15 °C or lower), the drying process will take up to 170 min.

### 3 Remove the adaptor after the selected mode is completed.

Clean the shaver with water once per month. (See pages 17 to 19.)

The main unit neck section (a), inner blade attachment part (b), trimmer, system outer foil gaps, etc. cannot be cleaned with the self-cleaning recharger.

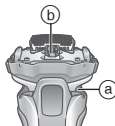

### Changing the mode of self-cleaning recharger

The “Charge” mode starts when attaching the shaver, and the mode can be changed by pressing the SELECT button.

**Charge mode**  
(Charge)



**AUTO mode**  
(Clean/Dry/  
Charge)



**Dry/Charge mode**  
(Dry/Charge)



### Notes

- Do not press the cleaning liquid unit removal button during cleaning as the cleaning liquid may spill causing a malfunction.
- The drying time may increase in an ambient temperature approximately 15 °C or lower.  
The Clean or Dry function may not operate under extreme low temperatures (approximately 0 °C or lower).
- A lubricant constituent is included in the detergent, so smooth shave is maintained without applying oil.

## Cleaning thoroughly

### Cleaning with water

- Turn the shaver off and disconnect the AC adaptor.

### 1 Apply some hand soap and some water to the system outer foil.



## 2 Press for more than 2 seconds to activate the sonic vibration cleaning mode.

- Splashing of foam is suppressed.
- The battery capacity lamps blink in order.
- After about 20 seconds, it will be automatically turned off, or you can turn it off by pressing the power switch.

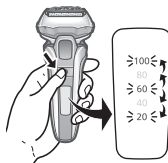



## 3 Remove the outer foil section and clean with running water.

- See page 19 for removing the outer foil section.
- Splashing is reduced by rinsing the shaver in sonic vibration cleaning mode.
- After rinsing with water, shake the shaver up and down for a few times to remove excess moisture and then wipe off any drops of water with a dry cloth.



## 4 Attach the outer foil section and dry with the self-cleaning recharger.

1. Insert the shaver into the self-cleaning recharger and plug the adaptor into a household outlet.
  - Check that the charge status lamp () is glowing.
2. Press  twice.

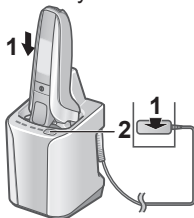

The DRY lamp glows, and the “Dry/Charge” mode will start after approximately 6 seconds.

- It is possible to change to the “AUTO” mode even after the “Dry/Charge” mode has started.

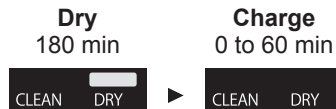

3. Remove the adaptor after the selected mode is completed.

## 5 Lubricate the shaver.

It will keep the movement of the blades smooth and maintain a comfort shave.

1. Apply one drop of oil to each of the system outer foils.
2. Raise the trimmer and apply a drop of oil.
3. Switch the shaver on, and run it for approximately five seconds.
4. Switch off the shaver, and wipe off any excess oil from the system outer foil with a soft cloth.



- **Drying the shaver without the self-cleaning recharger**  
Dry in a shade and apply oil.



## Notes

- Do not use any kitchen or bathroom detergents other than hand soap.  
Doing so may cause malfunction.
- Be careful not to hit the main body on the sink or any other object while draining the water. Failure to do so may cause malfunction.
- Do not wipe with thinners, benzine, alcohol etc.  
Doing so may cause malfunction, cracking or discoloration of the parts.  
Wipe with diluted soapy water.
- Do not use the self-cleaning recharger while droplets or soap remain on the shaver.  
Doing so may change the concentration level or composition of the cleaning liquid in the cleaning liquid unit, which may degrade cleaning, sterilization, lubrication and drying performance. This may also cause cleaning liquid to spill from the self-cleaning recharger.

## Cleaning the system outer foil

Remove the outer foil section.

(See this page.)

Wash the system outer foil in the areas indicated by the circles every time you use the shaver. Otherwise, abnormal sound may be generated.

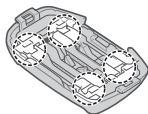

## Replacing the system outer foil and the inner blades

system outer foil	once every year
inner blades	once every two years

### ► Removing the outer foil section

Press the foil frame release buttons and lift the outer foil section upwards.

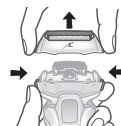

### ► Attaching the outer foil section

After turning the foil frame mark (ℒ) to the front, securely attach the outer foil section to the shaver until it clicks.

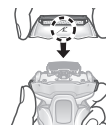

### ► Replacing the system outer foil

1. Press the system outer foil release buttons and pull down the system outer foil.

- Do not press the system outer foil release buttons with excessive force.

Doing so may bend the system outer foil, preventing complete attachment to the foil frame.

2. Align the foil frame mark (ℒ) and the system outer foil mark (△) and securely attach together until it clicks.

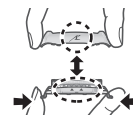

### ► Replacing the inner blades

1. Remove the inner blades one at a time.
2. Insert the inner blades one at a time.

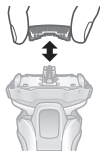

### Note

Do not throw away the foil frame.

## Replacing the cleaning liquid

If the STATUS lamp glows for 5 seconds when the SELECT button is pressed, the cleaning liquid needs to be replaced.

- Even if the STATUS lamp does not light up, replace the cleaning liquid after 6 months have passed.

### 1 Remove the AC adaptor and remove the cleaning liquid unit. (See page 13.)



### 2 Wash away the old cleaning liquid.

- It can be drained as sewage.

### 3 Rinse the cleaning liquid unit.

- Pour water as illustrated while tilting the cleaning liquid unit and shaking it gently.
- You can clean with the cleaning liquid filter removed.

After washing, be sure to attach the cleaning liquid filter.



### 4 Gently wipe off any beard trimmings attached to the inside of the cleaning tray (a) with a cloth or tissue paper dampened with water.

- Clean the corners and uneven parts of the cleaning tray with a cotton swab dampened with water.

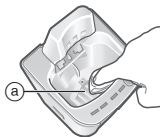

### 5 Prepare the new cleaning liquid. (See page 13.)



The symbol on the left means “Do not wash the self-cleaning recharger with water”.

### Notes

- The cleaning liquid will decrease every time it is used, but do not add detergent and water except when replacing the cleaning liquid. Doing so may deteriorate the cleaning function.
- Do not wash the self-cleaning recharger unit with water.
- Do not wipe with thinners, benzene, alcohol etc. Doing so may cause malfunction, or cracking or discoloration of the parts. Wipe with diluted soapy water.

### ► When the water does not drain from the cleaning tray

- Do not tilt the self-cleaning recharger to pour out water. Doing so may cause the cleaning liquid in the cleaning liquid unit to spill or cause the self-cleaning recharger to malfunction.

- Beard trimmings may clog the drain at the bottom of the cleaning tray. In this case, you cannot clean or dry the shaver.

1. Be sure to remove the AC adaptor from the self-cleaning recharger.
2. Place the self-cleaning recharger on a flat surface, and push the beard trimmings down through the drain (b) with a toothpick etc.

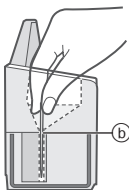

### ► Replacement parts

Replacement parts are available at your dealer or Service Center.

Replacement parts for ES-LV9U	System outer foil	WES9181
	Inner blades	WES9170
Special Detergent for Shaver Cleaning & Charging System		WES4L03

## When the LOW/STATUS lamp glows

It indicates that the cleaning liquid is due for replacement when the LOW lamp or STATUS lamp glows for approximately 5 seconds when the SELECT button is pressed.

Lamp on the self-cleaning recharger	Content of notification
The LOW lamp glows. ►	Replacement of the cleaning liquid is required in approximately 7 days. Prepare the detergent.
The STATUS lamp glows. ►	<p>Replace the cleaning liquid. (Modes other than the "AUTO" mode can be used even if it is not replaced.)</p> <p>If you think the replacement should not be due yet.</p> <ul style="list-style-type: none"> <li>• Is the cleaning liquid unit correctly attached?</li> <li>• Is the self-cleaning recharger placed in a level surface?</li> <li>• Is the self-cleaning recharger used outside the range of the recommended usage temperature? (Only "Charge" mode can be used.)</li> </ul>

## FAQ

Question	Answer
Why does “Dry/ Charge” mode take longer than “AUTO” mode?	▶ This is due to the difference in the drying time. The drying time for the “Dry/ Charge” mode is set longer as there may still be excess moisture on the areas other than the system outer foil after the shaver has been rinsed and cleaned with water.
Can I refill the self-cleaning recharger with water when the cleaning liquid has decreased?	▶ Do not refill with water as doing so may deteriorate the cleaning function. Replace the cleaning liquid.
Can the self-cleaning recharger be used to wash other models?	▶ Doing so may cause malfunction, so do not use with other models.
Will the battery deteriorate if not used for an extended period of time?	▶ The battery will deteriorate if not used for over 6 months, so make sure to perform a full charge at least once every 6 months.
Can I charge the shaver after every use?	▶ The battery used is a lithium-ion, so charging after every use will have no effect on battery life.

Question	Answer
Why should the adaptor be disconnected after charge?	▶ Charging the battery for more than 1 hour will not affect battery performance, but disconnect the adaptor for safety and to save energy.
What is the constituent of the dedicated oil and the detergent?	▶ Oil: Liquid paraffin Detergent: Non-ionic surfactant agent, antimicrobial agent, lubricant and fragrance.
Why does the appliance beep twice after switched off?	▶ The sound indicates that the battery capacity is running low. Please charge the appliance.

## Troubleshooting

Perform the following actions.  
If the problems still cannot be solved or all self-cleaning recharger's lamps blink, contact the store where you purchased the unit or a service center authorized by Panasonic for repair.

► **Self-cleaning recharger**

Problem	Action
<p>The blade has not been thoroughly washed.</p>	<p>Do not add detergent and water except when replacing the cleaning liquid. Doing so may deteriorate the cleaning function. (See page 20.)</p> <p>► After cleaning, oil-like droplets may remain on the outside of the foil frame.</p> <p>► This is the lubricating component of the cleaning liquid and does not indicate a problem. You may wipe it off with a soft cloth.</p>
<p>The blades are not dry or are sticky.</p>	<p>The blades may not dry quickly due to temperature conditions.</p> <p>► Run the “Dry/Charge” mode again or wipe with a soft cloth before shaving.</p>

Problem	Action
<p>The system outer foil cracks or deforms during cleaning.</p>	<p>Do not insert any foreign objects into the recharger. Remove foreign objects in the cleaning tray. (See page 20.)</p> <p>►</p> <p>Replace the system outer foil and/or inner blades. (See page 19.)</p> <p>►</p>
<p>The cleaning liquid has foamed.</p>	<p>If you mix soapy water or hand soap with the detergent or use another detergent, the cleaning liquid will foam. Use the self-cleaning recharger after thoroughly washing and drying the shaver.</p> <p>►</p> <p>Replace the cleaning liquid. (See page 20.)</p> <p>►</p>

Problem	Action
Cleaning liquid has accumulated in the cleaning tray.	▶ Remove any waste, etc. that has accumulated in the drain at the bottom of the cleaning tray. (See page 20.)
	▶ If you use the self-cleaning recharger when the shaver is wet or when soap or shaving gel is on the shaver, cleaning liquid may accumulate in the cleaning tray.
Cleaning liquid leaked from the cleaning liquid unit.	▶ Do not press the cleaning liquid unit removal button during any mode.
	▶ Place the self-cleaning recharger horizontally.
	▶ If you use the self-cleaning recharger when the shaver is wet or when soap or shaving gel is on the shaver, cleaning liquid may leak.
The cleaning liquid unit cannot be removed.	▶ Place the self-cleaning recharger on a hard, flat surface. (See page 13.)

Problem	Action
The mode does not start.	▶ Check that the AC adaptor is connected to the self-cleaning recharger, and that the adaptor is plugged in to a household outlet. (See page 16.)
	▶ Confirm that the shaver is properly attached to the self-cleaning recharger. (See page 16.)
	▶ The Clean or Dry function may not operate under extreme low temperatures (approximately 0 °C or lower).
The shaver cannot be charged.	▶ Check if the STATUS lamp is glowing. (See page 21.)
	▶ Gently wipe the main body rear terminals and the charging terminals of the self-cleaning recharger with a cloth or tissue dampened with water.



Problem	Action
Makes a loud sound. ▶	<p>During cleaning: The self-cleaning recharger makes a loud sound due to the cleaning of the blades.</p> <p>After cleaning: The self-cleaning recharger makes a loud sound due to the removal of water droplets in order to speed drying.</p> <p>The sound after cleaning is different from the sound during cleaning. The water level has dropped and it is removing water droplets from the blades after cleaning. This does not indicate a problem.</p>

▶ **Shaver**

Problem	Action
The power switch does not turn ON. ▶	Unlock the switch lock. (See page 16.)

Problem	Action
The shaving sensor does not respond.	<p>Depending on the beard thickness or the amount of beard trimmings in the shaver head, the shaving sensor may not react and the driving sound may not change. This is not abnormal.</p> <p>▶ The shaving sensor may not respond depending on the type and quantity of the shaving gel. This is not abnormal.</p> <p>▶ The shaving sensor may not respond when the remaining battery capacity is low. If this happens, recharge the shaver.</p> <p>▶ Apply oil. (See page 18.)</p> <p>▶ The shaving sensor may not respond when there is not enough oil on the blades.</p>

Problem	Action
The shaving sensor responds even though the shaver is not in contact with the skin.	▶ When the shaver is extremely dirty, remove the foil frame and wash with water. (See page 17.)
	▶ Replace the system outer foil and/or inner blades. Expected life of system outer foil and inner blades: System outer foil: Approximately 1 year Inner blades: Approximately 2 years
Operating time is short even after a full charge.	▶ Although the shaver can be used for about 2 weeks after a full charge (assuming dry-shave usages for 3 minutes per day), the usable number of days might be lower depending on how the shaver is used (for example, when used for wet shaving).
	▶ Apply oil.
	▶ Clean the shaver.
	▶ When the number of operations per charge starts to decrease, the battery is nearing the end of its life.

Problem	Action
Shaver does not operate even after charging.	▶ Use the appliance in an ambient temperature approximately 5 °C or higher.
	▶ The battery has reached the end of its life. ▶ The shaver will not operate with the AC adaptor connected. Please use the shaver after it has been sufficiently charged and the AC adaptor disconnected.
The driving sound changes while shaving.	▶ The shaving sensor is operating. The sound changes depending on the beard thickness.
Makes a loud sound.	▶ Apply oil. The blades will not move smoothly when there is no oil on the blades, requiring more power.
	▶ The shaver makes a high-pitched sound due to the linear motor drive. This does not indicate a problem.
	▶ Confirm that the blades are properly attached.
	▶ Wash the system outer foil with water. (See page 17.)

Problem	Action
The odor is getting stronger.	▶ Clean the shaver.
Shavings fly out in all directions.	▶ Clean the inner blades with water when shavings are adhering to the inner blades.
System outer foil gets hot.	▶ Apply oil.
	▶ Replace the system outer foil if it is damaged or deformed. (See page 19.)
You do not get as close a shave as before.	▶ Clean the shaver.
	▶ Apply oil.
	▶ Replace the system outer foil and/or inner blades. Expected life of system outer foil and inner blades:
	▶ System outer foil: Approximately 1 year Inner blades: Approximately 2 years

## Battery life

The life of the battery is 3 years. The battery in this shaver is not intended to be replaced by consumers. Have the battery replaced by an authorized service center.

## Removing the built-in rechargeable battery

### Remove the built-in rechargeable battery before disposing of the shaver.

The battery is to be disposed of safely.

Please make sure that the battery is disposed of at an officially designated location if there is one.

This figure must only be used when disposing of the shaver, and must not be used to repair it. If you dismantle the shaver yourself, it will no longer be waterproof, which may cause it to malfunction.

- Remove the shaver from the AC adaptor.
- Press the power switch to turn on the power and then keep the power on until the battery is completely discharged.

- Perform steps ① to ⑤ and lift the battery, and then remove it.
- Take care not to short circuit the positive and negative terminals of the removed battery, and insulate the terminals by applying tape to them.

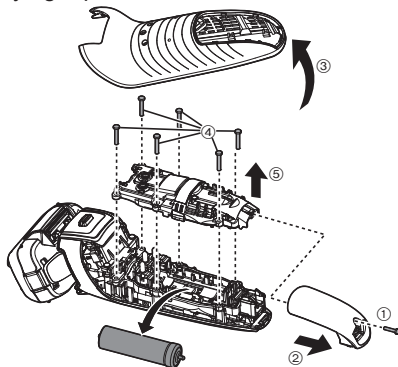

#### For environmental protection and recycling of materials

This shaver contains a Lithium-ion battery. Please make sure that the battery is disposed of at an officially assigned location, if there is one in your country.

## Specifications

Power source	See the name plate on the AC adaptor. (Automatic voltage conversion)
Motor voltage	3.6 V $\text{---}$
Charging time	Approx. 1 hour

This product is intended for household use only.

## 目錄

安全須知.....	30	當低水位燈 (LOW)/ 狀態燈 (STATUS) 亮起時 .....	44
重要資訊.....	33	常見問答集 .....	44
部件說明.....	35	疑難排解.....	45
準備 .....	36	電池壽命.....	48
使用方法.....	38	拆除內置充電電池.....	49
請徹底清潔 .....	41	規格 .....	49
更換外層網面及內層刀片 .....	42		
更換清潔液 .....	43		

感謝您購買本 Panasonic 產品。

使用本產品之前，請仔細閱讀本說明書，並妥善保存以供未來使用。

## 安全須知

請務必依照以下指示。

為了防止意外、受傷或財物損失，請依照以下指示。

■ 以下符號表示不當使用而導致的受損程度。

 **危險** 表示潛在的危險會導致嚴重受傷或致命。

 **警告** 表示潛在的危險可能會導致嚴重受傷或致命。

 **注意** 表示潛在的危險可能會導致輕微受傷或財物損失。

■ 符號已按下方分類並作出解釋。

 此符號表示禁止。

 此符號表示必須遵循的要求。

 **警告**

▶ 本產品

 本產品內置充電電池。請勿丟入火中、接觸熱源或在高溫的環境中充電、使用，或留置在高溫的環境中。

- 否則可導致過熱、燃燒或爆炸。

切勿改裝或自行維修產品。

 - 否則可能導致火警、觸電或受傷。  
請聯絡 Panasonic 直屬服務站進行維修（更換電池等）。

 切勿拆開本產品，棄置時除外。  
- 否則可能導致火警、觸電或受傷。

▶ 若發生異常現象或故障

請立即停止使用本產品及拔除電源供應器。

- 否則會造成火警、觸電或受傷。

< 異常或故障情況 >

• 主機、自動清洗充電器、電源供應器或電源線變形或異常灼熱。

 • 主機、自動清洗充電器、轉接器或電源線出現燒焦氣味。

• 主機或自動清洗充電器在使用或充電時出現異常聲響。

- 請立即將產品帶往 Panasonic 直屬服務站，以要求檢查或維修。

▶ 電源供應

 切勿在手濕時將轉接器插入家用電源插座或從插座中拔除。

- 否則可導致觸電或受傷。

## ⚠ 警告

切勿將電源供應器和自動清洗充電器浸在水中或用水洗滌。

切勿將電源供應器和自動清洗充電器置於裝滿水的水槽、浴缸上方或附近。



如電源供應器損壞，或電源插頭未緊接家用電源插座上，切勿使用本產品。

切勿損壞電源線或電源插頭。

• 切勿破壞表面、改裝、用力弄彎、拉扯電源線或電源插頭。此外，切勿將重物放在電源線上、旋轉或夾緊電源線。

- 否則可能會因短路而導致觸電或火警。

切勿以超出家用電源插座或配線額定值的方式使用產品。



- 將太多插頭插至同一插座上，以致超出額定值，可能會因過熱而導致火警。

在任何情況下，切勿使用非隨附的電源供應器和自動清洗充電器。



此外，切勿使用非隨附的電源供應器和自動清洗充電器。（請參閱第 35 頁。）

- 否則可能會因短路而導致灼傷或火警。



必須完全插入電源插頭。

- 否則可導致火警或觸電。



使用清水清潔主體時，請中斷連接電源供應器。

- 否則可導致觸電或受傷。



應定期清潔電源插頭和電源線插頭，以防止灰塵堆積。

- 否則濕氣可令絕緣失效，導致火警。

## ▶ 避免意外



曾接受過醫療電子儀器移植手術的人士，請勿讓本產品接觸此類儀器植入處的皮膚表面。

- 此動作可能導致意外或身體不適。



切勿將產品放置在兒童或幼童可觸摸的地方。請勿讓兒童或幼童使用。

- 若把零件或配件放入口中，可能導致意外和受傷。



切勿在其他電器設備的上方使用或存放自動清洗充電器。

- 否則可能會因液體溢出引起觸電，或是由於短路導致火警。

若不慎喝下清潔劑或潤滑油，請勿催吐，應喝下大量開水然後就醫。



若清潔劑或潤滑油接觸到眼睛，請立即以清水徹底清洗並就醫。

- 否則可能導致身體不適。

若清潔劑接觸到皮膚，請立即以肥皂徹底清洗乾淨。



若您的皮膚或身體其他部位過敏，請立即停止使用並就醫。

- 否則可能會造成身體或皮膚受傷。

## ▶ 請注意以下注意事項

患有體能、感官或智力減退，或缺乏經歷和知識之人士（包括小孩），在無人監護或未獲告知如何使用的情况下不得使用本產品。請勿讓小孩使用本產品。



- 否則可能導致意外或受傷。

## ⚠ 警告



請勿自行更換電源線，電源線一旦損壞應當廢棄本電源供應器，勿再使用。  
- 否則可能導致意外或受傷。

## ⚠ 注意

### ► 保護皮膚

請勿施加過大力量，將外層網面加壓在嘴唇或臉上及其他部位。



請勿在暗瘡或受傷的皮膚上，直接使用外層網面。切勿接觸內層刀片的刀片（金屬）部分。  
- 否則可能會導致身體皮膚受傷。

切勿用力壓下外層網面。此外，使用時切勿用手指或指甲觸碰外層網面。



切勿將本產品用於頭髮或身體任何其他部位的毛髮上。  
- 否則可能導致皮膚受傷或縮短外層網面的壽命。

使用「自動」模式或「風乾／充電」模式時，切勿將鬚刨從自動清洗充電器上拆除。  
- 否則可能會因為外層網面邊緣的高溫而燙傷。



使用前，請檢查外層網面是否有破裂或變形。  
- 否則可能導致皮膚受傷。

### ► 請注意以下注意事項



勿讓金屬物品或垃圾黏附在電源插頭或電源線插頭上。  
- 否則可能會因短路而導致觸電或火警。



請勿與家人或其他人共用鬚刨。  
- 共用鬚刨可能會導致感染或發炎。



請勿將清潔劑用於清洗鬚刨刀刃以外的用途。  
- 用於其他產品可能會導致褪色或爆裂。



不充電時，應從家用電源插座拔出轉接器。  
- 否則可能因絕緣劣化造成漏電，導致觸電或火警。



打開清潔劑時，請注意鋒利的包裝切口。  
- 否則可能導致皮膚受傷。

## 如何處置從廢棄產品中拆下的電池

### ⚠ 危險

- 本充電電池僅能用於搭配本產品使用。請勿將本電池搭配其他產品使用。
- 將電池從產品拆除後，請勿進行充電。
- 請勿丟入火中或加熱。
- 請勿撞擊、拆解、改裝或以指甲穿刺。
- 請勿讓電池的正極和負極端子透過金屬物質相互接觸。
- 請勿將電池與金屬飾品，如項鍊及髮夾等一起攜帶或存放。
- 切勿在高溫的位置使用或放置電池，例如在陽光直射或靠近其他熱源的地方。
- 請勿拆下電池直流管。  
- 否則可導致過熱、燃燒或爆炸。



## ⚠ 警告

拆除充電電池後，切勿放在孩童或嬰兒可取得的地方。



- 若意外吞下電池，會傷害身體。
- 若發生此情況，請立即就醫。

若電池液體外洩且接觸到眼睛，請勿揉搓眼睛，並使用清水（如自來水）徹底沖洗。



- 否則可能會導致眼睛受傷。
- 請立即就醫。

## ⚠ 注意

若電池液體外漏且接觸到皮膚或衣物，請使用清水（如自來水）沖洗。



- 否則可能導致發炎。

## 重要資訊

- 此款乾 / 濕通用鬚刨可用於直接剃鬚，也可在塗抹剃鬚膏後進行濕式剃鬚。此鬚刨具防水功能，因此可在淋浴時使用，也可在水中清洗。以下符號表示可在盆浴或淋浴時使用。



- 連續三周使用剃鬚膏進行濕式剃鬚，您能體會到一些變化。由於您的皮膚和鬚鬚需要大約一個月的時間來適應新的剃鬚方式，因此您可能需要一點時間來適應此款 Panasonic 乾 / 濕兩用鬚刨。

- 將內層刀片保持在原有位置。如只有一塊內層刀片，鬚刨可能已經受損。
- 如您以水清洗鬚刨，請勿使用鹽水或熱水。切勿將鬚刨長時間浸泡於水中。
- 下列符號表示需使用專用的可拆式電源供應器，將本電器連接至主電源。符號附近標示了電源供應器的類型參考。



- 請根據使用說明書正確地為產品充電。（請參閱第 36 頁的「充電」。）
- 本產品所含的電池只能由技術人員更換。請聯絡 Panasonic 直屬服務站洽詢修理細節。

## 請注意以下注意事項

### ► 使用時

- 請勿讓外層網面與堅硬的物體接觸。否則可能會破壞外層網面，因為網面非常薄且很容易變形。
- 切勿掉落，或者與其他物體發生碰撞。否則可導致受傷。

### ► 關於清潔劑

- 切勿將清潔劑放置在高溫處。否則可能會造成劣化。
- 立即擦掉任何溢出的清潔液。長時間接觸可能會造成皮革產品或木製地板褪色。

### ► 保存時

- 使用後將鬚刨收納在低濕度的地方。否則可能造成水氣凝結或鏽蝕，此可能造成故障。
- 攜帶或存放時，務必將鬚刨放在保護蓋中。否則可能導致皮膚受傷或縮短外層網面的壽命。

### ► 清潔時

- 切勿使用風筒或加熱風扇為主體風乾。  
否則可能會造成故障或部件變形。
- 拆卸網層後，切勿讓鬚刨直接曝曬在陽光下。  
否則可能造成防水橡膠劣化並減損防水功能，此可能造成故障。

# 部件說明

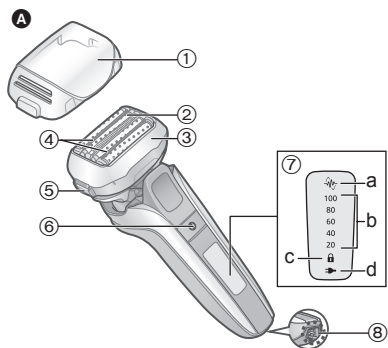

背面

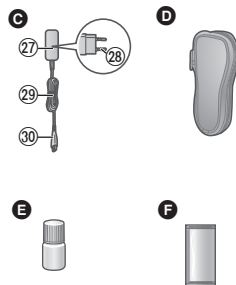
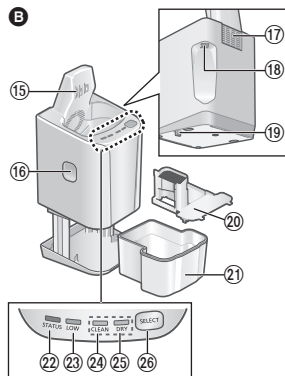
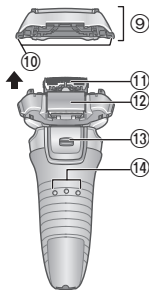

## A 主體

- ① 保護蓋
- ② 外層網面
- ③ 網層
- ④ 平滑滾輪
- 協助鬚刨更輕鬆地滑過皮膚
- ⑤ 網層拆除按鈕
- ⑥ 電源開關

## ⑦ 顯示燈

- a. 「偵感」刀頭震動感應燈 (🔊)
- b. 電池電量指示燈
- c. 開關鎖定燈 (🔒)
- d. 充電狀態指示燈 (🔌)

## ⑧ 充電插座

- ⑨ 外層網面部分
- ⑩ 拆除外層網面的按鈕
- ⑪ 內層刀片
- ⑫ 修剪器
- ⑬ 修剪器推桿
- ⑭ 主體後方接觸點

## B 自動清洗充電器 (RC9-22)

- ⑮ 充電接觸點
- ⑯ 清潔液槽拆除鈕
- ⑰ 進氣口
- ⑱ 自動清洗充電器插座
- ⑲ 鎖定解除桿
- ⑳ 清潔液濾網
- ㉑ 清潔液槽
- ㉒ 狀態燈 (STATUS)
- ㉓ 低水位燈 (LOW)
- ㉔ 清潔燈 (CLEAN)
- ㉕ 風乾燈 (DRY)
- ㉖ 選擇按鈕 (SELECT)

## C 電源供應器 (RE7-87)

- ㉗ 轉接器
- ㉘ 電源插頭
- ㉙ 電源線
- ㉚ 電源線插頭

## 配件

- ㉛ 輕便旅行盒
- ㉜ 潤滑油
- ㉝ 專用清潔劑 (清潔劑)

購買時，自動清洗充電器內部可能有水漬，但不會引起衛生問題。通過原廠檢查後可能有殘餘物。

## 準備

### 充電

- 關掉電源。
- 擦去主體後方接觸點上的水滴。

**1** 將電源線插頭插入自動清洗充電器。

**2** 請在按下保護蓋側邊的同時  
移除保護蓋，並將鬚刨插入  
自動清洗充電器。

- 緩慢地將鬚刨插入自動清洗充電器，並小心不要損壞外層網面。

**3** 將轉接器插入家用插座。

- 檢查充電狀態指示燈 (➡) 有亮起。
- 充電約 1 小時後完成。

**4** 充電完成後，請拔除轉接器。

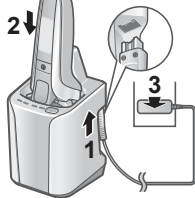

### 快速充電

即使電池用盡後，您也可以在充電 3 分鐘後剃鬚一次。  
(視乎使用情況而異)

### 充電時

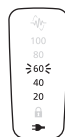

➡ 亮起。  
電池電量指示燈的數字會  
在充電過程中增加。

### 充電完成後

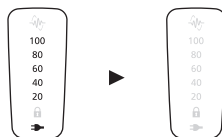

所有電池電量指示燈和充  
電狀態指示燈 ➡ 將亮起，  
並於 5 秒後熄滅。

### 註

- 鬚刨第一次充電或未使用超過 6 個月時，充電時間可能會有所改變，或者充電狀態指示燈 (➡) 可能會幾分鐘無法亮起。如繼續保持充電狀態，最後會亮起。
- 建議的充電環境溫度為 10 °C 至 35 °C。在溫度極高或極低的情況下對電池充電，可能需要較長的時間，或者充電狀態指示燈 (➡) 將快速閃爍，且電池可能無法正常充電。
- 完全充電後，鬚刨大約可以使用 2 週。  
(這是根據每天在 20 °C 到 30 °C 的環境溫度範圍內使用乾式剃鬚 3 分鐘)  
可使用的天數會因以下條件而有所差異：
  - 鬚鬚濃密度
  - 施加到皮膚的力度
  - 音波振動清潔模式的使用頻率
- 如果收音機或其他音訊來源在使用或充電本產品時發出噪音，請於另一個地方使用本產品。

## 不以自動清洗充電器充電

- 關掉電源。
- 抹乾充電插座上的水滴。

- 1 將電源線插頭插入鬚刨。
- 2 將轉接器插入家用插座。
- 3 充電完成後，請拔除轉接器。

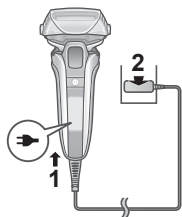

### 註

您無法在充電時使用鬚刨。

## 準備清潔液

請事先準備，以便在使用後立即開始清潔。

- 從自動清洗充電器拆除電源供應器。

- 1 按下清潔液槽拆除鈕  
(①) 並在堅硬、平坦的表面上拆除清潔液槽 (②)。

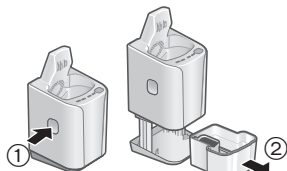

- 若在柔軟的平面如地毯等上提起自動清洗充電器，鎖定解除桿將無法適當裝入充電器。若為這種狀況，將無法拆除清潔液槽。

- 2 將清水 (①) 及清潔劑 (②) 倒入清潔液槽。

- 請不要把自來水注入高於水線位置 (a)。
- 請倒入整包清潔劑。

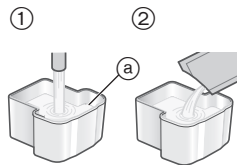

- 3 請慢慢插入清潔液槽到自動清洗充電器，直到發出「卡塔」聲。

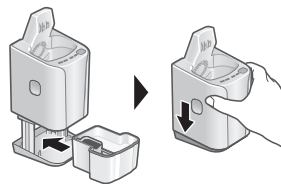

### 註

- 如需更換清潔液，請參閱第 43 頁。
- 只使用自動清洗充電器的專用清潔劑（型號 WES4L03）來清洗。否則可能會造成故障或無法進行清洗。
- 請勿傾斜自動清洗充電器。否則清潔液可能會濺出或可使用的天數減少。
- 在每天使用一次的情況下，清潔液可使用約 30 天。（視乎鬚鬚厚度和周圍氣溫而異）

# 使用方法

## 剃鬚

### 1 按下 開始剃鬚。

- 「偵感」刀頭震動系統會根據鬚鬚濃密自動調整功率運作。  
此將在鬚鬚濃密的地方以高功率剃鬚，在鬚鬚較少的地方降低功率以減低對皮膚的磨擦。



### 達成更好的剃鬚方式建議

以外層網面垂直的方式靠貼皮膚，並將鬚鬚刨輕輕朝您臉部的鬚鬚處滑動以剃鬚。

- 此可伸展皮膚，讓鬚鬚豎起，更徹底地剃除下巴下方與喉嚨周圍的鬚鬚。
- 為避免損壞外層網面，切勿在僅有一部份的外層網面接觸的情況  
下剃鬚。

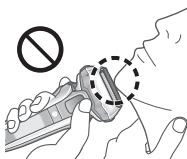
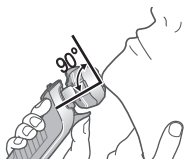

### 2 完成後，請按下 。

#### 使用時

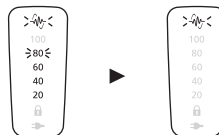

剩餘的電池電量將顯示，並於 5 秒後熄滅。

- 電池的電量將顯示為 20-100。
- 「偵感」刀頭震動感應燈 () 閃爍。

#### 使用後

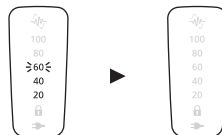

剩餘的電池電量將閃爍，並於 5 秒後熄滅。

#### 電池電量不足時

操作鬚刨時，「20」會閃爍。

- 出現「20」閃爍之後，還可使用 2 到 3 次。  
(視使用情況而異。)







#### 註

- 如果環境溫度低於約 5 °C，則本產品可能無法運作。
- 視剃鬚膏的類型與分量而定，「偵感」刀頭震動系統可能無法作出反應。此並非異常現象。
- 依鬚鬚濃密度或鬚鬚修剪量而定，「偵感」刀頭震動系統可能無法做出反應，且驅動聲音可能不變。這不是異常情況。
- 為避免錯誤操作，使用鬚刨時，請將手指放在適當的手握位置上。
- 在鬚刨靜止時，且按下電源開關超過 2 秒時，就會啟動音波振動清潔模式。(請參閱第 41 頁。)  
您無法在這種模式下剃鬚。

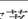



## 開關鎖定的操作及顯示

### ▶ 鎖定電源開關

1. 按下  一次，然後放開。
  - 鬚刨開始運作。
2. 按著  超過 2 秒，直到「開關鎖定燈」(  ) 亮起。
  - 鬚刨將停止運作。
3. 然後放開  。
  - 開關鎖定燈 (  ) 將亮起 5 秒然後熄滅。

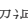

### ▶ 解除鎖定電源開關

1. 按著  超過 2 秒，直到「開關鎖定燈」(  ) 熄滅。
2. 當鬚刨開始運作時，便放開  。
  - 開關鎖定燈 (  ) 將熄滅。

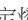

- 當開關鎖定燈 (  ) 閃爍 5 秒時，電源開關為鎖定，此時即使按壓電源開關，鬚刨還是無法使用。

### ▶ 使用修剪器

1. 將修剪器推桿推至「mm」位置，讓修剪器垂直。
2. 按下  開始使用。



按住頂部旋鈕 (a)，並將修剪器推桿向下滑至修剪器。

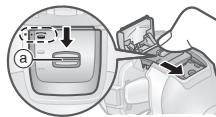

### 使用修剪器的建議

輕輕地使修剪器邊緣垂直於皮膚，然後緩慢地往下移動。

修剪鬚毛

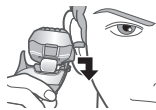

剃長鬍鬚



### ▶ 更換鬚刨刀頭

您可變換軸轉動作。

「」

鬚刨刀頭將可以移動，以避免錯過剃鬚位置。

「」

您可鎖定刀頭。

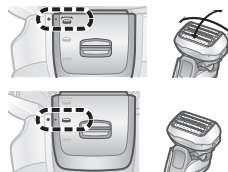

## 清潔、風乾、充電

我們建議在每次使用後即清潔鬚刨。

### 1 請將鬚刨插入自動清洗充電器，然後將轉接器插入家用插座。(請參閱第 36 頁。)

- 檢查充電狀態指示燈 (➡) 有亮起。
- 當低水位燈 (LOW) 或狀態燈 (STATUS) 亮起時，請參閱第 44 頁。

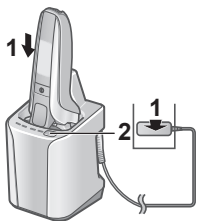

### 2 按下 **SELECT**。

清潔燈 (CLEAN) 與風乾燈 (DRY) 將亮起，而「自動」模式大約會在 6 秒後啟動。

- 「自動」模式開始後，便無法變更模式。

清潔

10 分鐘

風乾

80 分鐘\*

充電

0 至 60 分鐘



\* 當自動清洗充電器的環境溫度很低時 (約 15 °C 或更低)，風乾流程可能需時約 170 分鐘。

### 3 所選取的模式完成後，請移除轉接器。

請每月用水清潔鬚刨一次。(請參閱第 41 到 42 頁。)

主機頸部 (a)、內層刀片連接部 (b)、修剪器、外層網面間隙等均不得使用自動清洗充電器清潔。

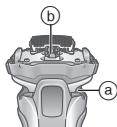

## 變更自動清洗充電器的模式

裝上鬚刨時，會啟動「充電」模式，並可按下選擇按鈕 (SELECT) 來變更模式。



### 註

- 切勿在清潔期間按下清潔液槽拆除鈕，因為清潔液可能會濺出，造成故障。
- 在環境溫度約為 15 °C 或更低的地方，風乾時間可能會增加。  
清潔或風乾功能可能因為溫度極低 (約 0 °C 或更低) 而無法運作。
- 清潔劑內已經包含潤滑成分，因此無須使用潤滑油即可順暢地剃鬚。



## 請徹底清潔

### 請用水清潔

- 將鬚刨關閉，並中斷連接電源供應器。

#### 1 在外層網面上塗抹一些肥皂和水。



#### 2 按著 **Ⓢ** 超過 2 秒來啟動音波振動清潔模式。

- 此可防止泡沫亂濺。
- 電池電量指示燈會依序閃爍。
- 約 20 秒後，振動器會自動關掉，或可按電源開關來關掉。

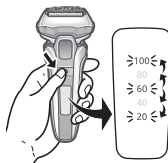

#### 3 取出外層網面部分，並使用自來水清潔。

- 請參閱第 42 頁，以獲得如何移除外層網面部分的資訊。
- 在音波振動清潔模式下沖洗鬚刨可以減少水滴濺出。
- 使用清水沖洗後，請上下用動鬚刨數次，清除多餘水氣，然後使用乾布抹乾鬚刨。



#### 4 請連接外層網面部分，並使用自動清洗充電器進行風乾。

- 請將鬚刨插入自動清洗充電器，然後將轉接器插入家用插座。

- 檢查充電狀態指示燈 (➡) 有亮起。

- 按下 **SELECT** 兩次。

風乾燈 (DRY) 將亮起，而「風乾 / 充電」模式大約會在 6 秒後啟動。

- 即使在「風乾 / 充電」模式開始後，仍可變更至「自動」模式。

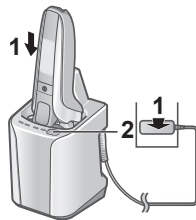

風乾	充電
180 分鐘	0 至 60 分鐘



- 所選取的模式完成後，請移除轉接器。

#### 5 請使用潤滑劑潤滑鬚刨。

此可讓刀片運作更順暢，並保持舒適的剃鬚體驗。

- 在每層外層網面上放上一滴潤滑油。
- 升起修剪器，並放上一滴油。
- 啟動鬚刨，然後運作約五秒。
- 關掉鬚刨，然後以軟布抹去外層網面多餘的潤滑油。



## ► 不使用自動清洗充電器來風乾鬚刨

請放在陰暗處自然風乾並塗抹潤滑油。



### 註

- 切勿使用肥皂以外的任何廚房或浴室清潔劑。否則可能造成故障。
- 排水時，小心不要讓主體撞到水槽或其他物件。否則可能造成故障。
- 切勿使用稀釋劑、石油精、酒精等擦拭。否則可能會造成故障，或部件斷裂或褪色。請使用稀釋過的肥皂水擦拭。
- 鬚刨上仍有水滴或肥皂時，切勿使用自動清洗充電器。否則可能造成清潔液槽內的清潔液成分濃度改變，此會造成清潔、殺菌、潤滑與風乾的性能降低。這還可能造成清潔液從自動清洗充電器中濺出的問題。

## 清潔外層網面

取出外層網面部分。  
(請參閱本頁。)

每次使用鬚刨時請清洗圖圈指示範圍的外層網面。否則可能會發出異常聲。

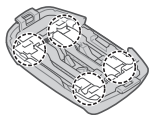

## 更換外層網面及內層刀片

外層網面	每年一次
內層刀片	每兩年一次

### ► 取下外層網面部分

按下網層拆除按鈕，並向上提起外層網面部分。

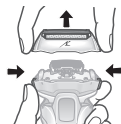

### ► 裝上外層網面部分

將網層標誌 (▲) 轉到前面之後，將外層網面部分牢固安裝到鬚刨聽到「卡嗒」一聲。

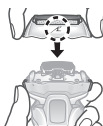

### ► 更換外層網面

1. 按著拆除外層網面的按鈕，拉下外層網面。

- 切勿以過大力道按下拆除外層網面的按鈕。否則可能會導致外層網面彎曲，並使網層無法完全連接。

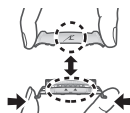

2. 對準網層標誌 (▲) 和外層網面標誌 (△)，然後牢固地安裝在一起，直到發出「卡嗒」聲。

### ► 更換內層刀片

1. 拆掉內層刀片。
2. 一次插入內層刀片到定位。

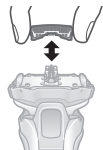

註  
請勿丟棄網層。

## 更換清潔液

當按下選擇按鈕 (SELECT) 後，如果狀態燈 (STATUS) 亮起 5 秒，則表示需要更換清潔液。

• 即使狀態燈 (STATUS) 不亮起，也請在經過 6 個月後更換清潔液。

**1 請移除電源供應器與清潔液槽。**  
(請參閱第 37 頁。)

**2 以清水將用過的清潔液沖掉。**  
• 可以將清潔液排入水槽。



**3 請沖洗清潔液槽。**

- 如圖所示倒入清水，同時將清潔液槽傾斜並輕輕搖晃。
  - 您也可以先拆除清潔液濾網後進行清潔。
- 清洗完畢後，請務必裝上清潔液濾網。



**4 用布或濕紙巾輕輕抹掉所有附著清潔匣 (a) 內的鬚毛碎屑。**

- 用濕棉花棒清潔匣內的角落及不平滑的部份。



**5 準備新的清潔液。**  
(請參閱第 37 頁。)



左邊符號表示「切勿用水清洗自動清洗充電器」。

註

- 清潔液會在每次使用後減少，但是除非您要更換清潔液，否則請勿加入清潔劑或清水。此動作可能會讓清潔效果降低。
- 請勿用水沖洗自動清洗充電器。
- 切勿使用稀釋劑、石油精、酒精等擦拭。否則可能會造成故障，或部件斷裂或褪色。請使用稀釋過的肥皂水擦拭。

► 如清潔匣不能排出水份

- 請勿傾斜自動清洗充電器來倒出水。否則清潔液槽內的清潔液可能會濺出，或造成自動清洗充電器故障。

- 可能是由於碎屑淤塞了清潔匣底部。如果發生此情況，您將會無法清潔或風乾鬚刨。

1. 請務必將電源供應器從自動清洗充電器移除。
2. 請將自動清洗充電器置放於平坦的平面上，然後使用牙籤等物，透過排水孔 (b) 往下壓入。

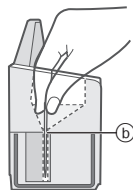

► 更換零件

您可以在經銷商或 Panasonic 直屬服務站購買更換零件。

ES-LV9U 的更換零件	外層網面	WES9181
	內層刀片	WES9170
鬚刨洗淨充電器專用清潔劑		WES4L03

## 當低水位燈 (LOW)/ 狀態燈 (STATUS) 亮起時

當按下選擇按鈕 (SELECT)，且低水位燈 (LOW) 或狀態燈 (STATUS) 亮起約 5 秒時，即表示應該更換清潔液。

自動清洗充電器上的指示燈	通知內容
低水位燈 (LOW) 亮起。	大約需要在 7 天後更換清潔液。 準備清潔劑。
狀態燈 (STATUS) 亮起。	請更換清潔液。 (即使沒有更換，仍然可以使用「自動」以外的其他模式)。 如果您認為尚未到達需要更換的時間。 <ul style="list-style-type: none"><li>• 是否已經正確連接清潔液槽？</li><li>• 自動清洗充電器是否置放於水平平面上？</li><li>• 是否在超過建議的溫度範圍外使用自動清洗充電器？ (僅可以使用「充電」模式)。</li></ul>

## 常見問答集

問題	解決辦法
為何「風乾 / 充電」模式需要比「自動」模式更長的時間？	這是由於風乾時間的差異所致。「風乾 / 充電」模式的風乾時間設定較長，這是因為在沖洗過鬚刨並用水清潔過後，系統外層網面以外的區域仍可能殘存多餘濕氣。
當清潔液減少後，我可以用水補充自動清洗充電器嗎？	請勿用水來補充，此動作可能會讓清潔效果降低。請更換清潔液。
自動清洗充電器可用來清洗其他機型嗎？	切勿用於其他機型，否則可能造成故障。
在經過一段很長的時間不使用後，電池是否會劣化？	如果超過 6 個月不使用，電池將劣化，因此請確保至少每 6 個月進行一次完整的充電。
我可以在每次使用後都對鬚刨充電嗎？	鬚刨所使用的是鋰離子電池，因此每次使用後對電池充電並不會對電池壽命造成影響。
為何在充電後必須中斷連接轉接器？	對電池充電 1 小時以上，並不會影響電池效能，但為了安全性與省電，請中斷連接轉接器。
專用潤滑油與清潔劑的成分是甚麼？	潤滑油：液化石蠟 清潔劑：非離子介面活性劑、抗菌劑、潤滑油與香料。

問題	解決辦法
為什麼鬚刨關閉後會發出兩次嗶聲？	▶ 這個聲音表示電量正在減少。請將鬚刨充電。

## 疑難排解

請執行以下操作。  
如果仍無法解決問題，或自動清洗充電器的所有指示燈仍閃爍，請與您購買本產品的商店聯繫，或洽 Panasonic 直屬服務站進行維修。

### ▶ 自動清洗充電器

問題	解決辦法
未徹底清洗刀片。	▶ 除非您要更換清潔液，否則請勿加入清潔劑和清水。此動作可能會讓清潔效果降低。 (請參閱第 43 頁。)
	▶ 清潔後，網層外部可能會有類似潤滑油的小水滴。此為清潔液的潤滑成分，不表示發生問題。您可以使用軟布來擦掉。
刀片未乾或黏稠。	▶ 刀片可能因氣溫的緣故未快速風乾。 重新執行「風乾／充電」模式，或在剃鬚前以軟布擦拭。

問題	解決辦法
清潔時外層網面會破裂或變形。	▶ 請勿將任何異物插入充電器。取出清潔匣的異物。(請參閱第 43 頁。)
	▶ 更換外層網面或內層刀片。 (請參閱第 42 頁。)
清潔液起泡。	▶ 若您將肥皂水或洗手皂與清潔劑混合使用，或使用另一種清潔劑，則清潔液會起泡。徹底清潔並風乾鬚刨後再使用自動清洗充電器。
	▶ 請更換清潔液。 (請參閱第 43 頁。)
清潔液已堆積在清潔匣中。	▶ 清除任何已堆積在清潔匣底端排水管中的碎屑等物。 (請參閱第 43 頁。)
	▶ 若您在鬚刨潮濕狀態下或當鬚刨上有肥皂或剃鬚膏時使用自動清洗充電器，清潔液可能會堆積在清潔匣中。

問題	解決辦法
清潔液從清潔液槽中濺出。	<ul style="list-style-type: none"> <li>▶ 切勿在任何模式期間按下清潔液槽拆除鈕。</li> <li>▶ 以水平方向放置自動清洗充電器。</li> <li>▶ 若您在鬚刨潮濕狀態下或當鬚刨上有肥皂或剃鬚膏時使用自動清洗充電器，清潔液可能會溢出。</li> </ul>
無法拆卸清潔液槽。	<ul style="list-style-type: none"> <li>▶ 請將自動清洗充電器置放於堅固平坦的平面上。(請參閱第 37 頁。)</li> </ul>
模式未開始。	<ul style="list-style-type: none"> <li>▶ 檢查電源供應器已連接到自動清洗充電器，且電源轉接器已插至家用電源插座。(請參閱第 40 頁。)</li> <li>▶ 確認鬚刨已妥善裝至自動清洗充電器。(請參閱第 40 頁。)</li> <li>▶ 清潔或風乾功能可能因為溫度極低(約 0 °C 或更低)而無法運作。</li> <li>▶ 檢查狀態燈 (STATUS) 是否已亮起。(請參閱第 44 頁。)</li> </ul>
無法對鬚刨充電。	<ul style="list-style-type: none"> <li>▶ 以布或紙巾沾水輕輕擦拭主體後方接觸點和自動清洗充電器的充電接觸點。</li> </ul>

問題	解決辦法
發出很大的聲響。	<p>清潔期間： 自動清洗充電器由於清理刀片的緣故而發出大聲響。</p> <p>清潔後： 自動清洗充電器由於要清除水滴並快速風乾的緣故，而發出大聲響。 清潔後的聲音與清潔期間的聲音不同。水量下降且正在去除清潔後刀片上的水滴。這並不是異常情況。</p>

### ▶ 鬚刨

問題	解決辦法
電源開關無法切換到開啟。	<ul style="list-style-type: none"> <li>▶ 解除鎖定開關鎖定。(請參閱第 39 頁。)</li> </ul>

問題	解決辦法
「偵感」刀頭震動系統沒有反應。	▶ 依鬚鬚濃密度或鬚鬚修剪量而定，「偵感」刀頭震動系統可能無法做出反應，且驅動聲音可能不變。這不是異常情況。
	▶ 視剃鬚膏的類型與分量而定，「偵感」刀頭震動系統可能無法作出反應。此並非異常現象。
	▶ 剩餘電池電量很低時，「偵感」刀頭震動系統可能不能作出感應。若發生此狀況，請重新將鬚刨充電。
	▶ 塗上潤滑油。(請參閱第 41 頁)。 ▶ 刀片上的潤滑油不足時，「偵感」刀頭震動系統可能會沒有反應。
即使鬚刨未與皮膚接觸，「偵感」刀頭震動系統仍會有反應。	▶ 鬚刨很髒時，請除去網層並用水清洗。(請參閱第 41 頁)。
	▶ 更換外層網面或內層刀片。外層網面和內層刀片的預期使用壽命： 外層網面： 約 1 年 內層刀片： 約 2 年

問題	解決辦法
即使充滿電，操作時間仍然很短。	▶ 雖然充滿電後鬚刨約可使用 2 週（假設每天使用乾式剃鬚 3 分鐘），但根據使用鬚刨的方式（例如用於濕式剃鬚），使用天數可能會減少。
	▶ 塗上潤滑油。
	▶ 清潔鬚刨。 ▶ 當每次充電後的操作次數開始減少時，表示電池已經接近使用壽命的終點。
即使充電後，鬚刨仍不運作。	▶ 在溫度約 5 °C 或以上的環境中使用本產品。
	▶ 電池已達到使用壽命的終點。
	▶ 當鬚刨連接到電源供應器時，鬚刨不會運作。請待鬚刨充滿電，且已經中斷連接電源供應器後再使用。
剃鬚時，驅動聲有變化。	▶ 「偵感」刀頭震動系統正在運作中。聲音會因鬚子濃密度而變化。

## 電池壽命

電池使用壽命為 3 年。使用者不應自行更換本鬚刨中的電池。請交由 Panasonic 直屬服務站來更換電池。

問題	解決辦法
發出很大的聲響。	▶ 塗上潤滑油。 當刀片上沒有潤滑油時，刀片就無法順暢移動，且需要更多電力。
	▶ 鬚刨可能因線性磨打的緣故發出很大的聲響。這並不是異常情況。
	▶ 確認已妥善裝上刀片。
	▶ 用水清洗外層網面。(請參閱第 41 頁。)
臭味越來越濃。	▶ 清潔鬚刨。
剃落的鬍子四處飛濺。	▶ 若鬍子沾黏到內層刀片，以毛刷清潔清潔內層刀片。
外層網面變熱。	▶ 塗上潤滑油。
	▶ 換掉損壞或變形的外層網面。(請參閱第 42 頁。)
您無法像之前將鬍子剃得那麼乾淨。	▶ 清潔鬚刨。
	▶ 塗上潤滑油。
	▶ 更換外層網面或內層刀片。 外層網面和內層刀片的預期使用壽命： ▶ 外層網面： 約 1 年 ▶ 內層刀片： 約 2 年



## 拆除內置充電電池

此鬚刨內的電池請勿由消費者自行替換。

將電池安全棄置。

如您的國家／地區有指定認可棄置電池的地方，請確保將電池棄置於這些地方。

下圖只能用於棄置鬚刨時。切勿使用下圖作維修之用。若您自行拆解鬚刨，產品就不再具有防水功效，並可能會導致產品損壞。

- 將鬚刨從電源供應器上拆除。
- 按電源開關接通電源，保持電源的開啟狀態直至電池完全放電。
- 執行步驟 ① 至 ⑤ 以拉出並拆除電池。
- 請小心，不要讓已移除電池的正負極端子發生短路，且必須在端子上使用膠帶使其絕緣。

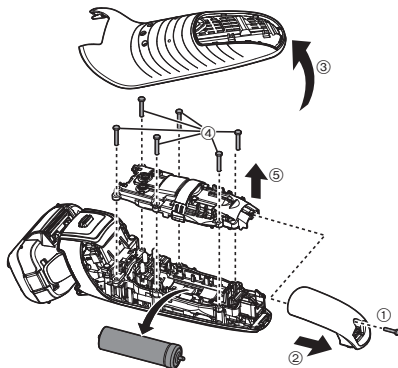

## 環保及資源回收

此鬚刨內藏鋰電池。

如您的國家有指定認可棄置電池的地方，請確保將電池棄置於這些地方。

## 規格

電源	請參閱電源供應器上標籤。 (自動變壓)
發動機電壓	3.6 V $\text{---}$
充電時間	約一小時

本產品只適於家居內使用。

# MEMO

---

---

---

---

---

---

---

---

---

---

---

---

---

---

---

---

---

---

---

---

---

---

---

---

---



Panasonic Corporation  
<https://www.panasonic.com>  
© Panasonic Corporation 2022